

2003 105238

After Recording Return To:
COUNTRYWIDE HOME LOANS, INC.
MS SV-79 DOCUMENT PROCESSING
1800 Tapo Canyon
Simi Valley, CA 93063-6712

[Space Above This Line For Recording Data]

IN1517339854703
[Case #]

920036589
[Escrow/Closing #]

0003129287565106
[Doc ID #]

ASSIGNMENT OF MORTGAGE

KNOW ALL MEN BY THESE PRESENTS That
COUNTRYWIDE HOME LOANS, INC.
4500 Park Granada, Calabasas, CA 91302-1613
organized and existing under the laws of NEW YORK, party of the first part, for
value received, has granted, bargained, sold, assigned, transferred and set over, and by these presents does
grant, sell, assign, transfer and set over unto THE LEADER MORTGAGE COMPANY

1015 EUCLID AVENUE
CLEVELAND, OH 44115
organized and existing under the laws of OHIO, whose location and mailing
address (if different) is

party of the second part, its successors and assigns, a certain indenture of mortgage dated
SEPTEMBER 29, 2003, made by
EYITAYO OLOYEDE,

to it, securing the payment of one promissory note therein described for the sum of
SEVENTY SEVEN THOUSAND FIVE HUNDRED FORTY SIX and 00/100
Dollars (\$ 77,546.00), and all its rights, title and interest in and to the premises situated in the
county of LAKE, State of Indiana, and described in said
mortgage as follows, to-wit:
LOT 48, MEADOWDALE 3RD SUBDIVISION, AS PER PLAT THEREOF, RECORDED IN
PLAT BOOK 34 PAGE 68, IN THE OFFICE OF THE RECORDER OF LAKE COUNTY,
INDIANA.

mtj 2003 105237

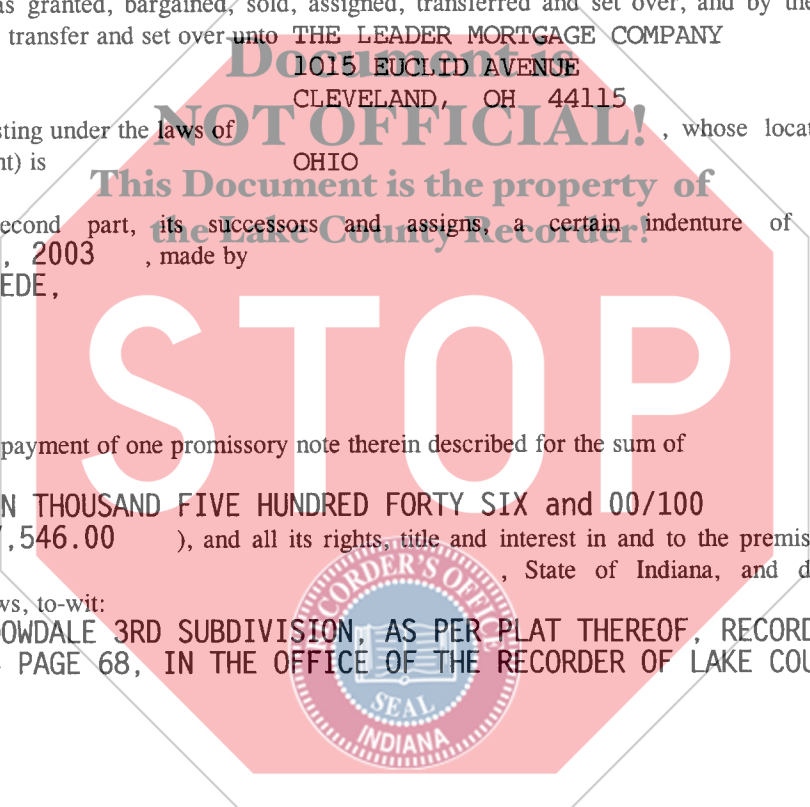

23991

*031292875000002995 - *

TICOR MO 920036589

12-56
JE DG

CASE #: IN1517339854703

DOC ID # 0003129287565106

which said mortgage is recorded in the office of the Recorder of LAKE

County, in the State of Indiana, in Book No.

at Page as Document No.

together with the said note therein described

and the money due or to grow due thereon, with the interest:

TO HAVE AND TO HOLD the same unto the said party of the second part, its successors and assigns, forever, subject only to the provisions in the said indenture of mortgage contained.

IN WITNESS WHEREOF, the party of the first part has caused this instrument to be executed in its name by VALERIE M NEFF its BRANCH OPERATIONS MANAGER

, and attested by KELLY NEFF LOAN SPECIALIST II, its and its corporate seal to be hereunto affixed this

TWENTY-NINTH day of SEPTEMBER, A.D. 2003. ATTEST:

COUNTRYWIDE HOME LOANS, INC.

Document is NOT OFFICIAL! This Document is the property of the Lake County Recorder! VALERIE M NEFF/BRANCH OPERATIONS MGR STATE OF INDIANA COUNTY OF LAKE KELLY NEFF/LOAN SPECIALIST II

On Sept 29, 2003, before me, personally appeared

, personally known to me (or proved to me on the basis of satisfactory evidence) to be the person(s) whose name(s) is/are subscribed to the within instrument and acknowledged to me that he/she/they executed the same in his/her/their authorized capacity(ies), and that by his/her/their signature(s) on the instrument the person(s), or the entity upon behalf of which the person(s) acted, executed the instrument.

WITNESS my hand and official seal. (This area for official notarial seal)



(Seal) Cheryl Cummings

This form was Prepared By: V. NEFF COUNTRYWIDE HOME LOANS, INC. address: 1525 US HIGHWAY 41 SUITE C-26, SCHERERVILLE, IN 46375- tel. no.: (219)322-2802