

2

2003 052138

2003 MAY 23 11 9:05
RECORDER

After Recording Return To:
COUNTRYWIDE HOME LOANS, INC.
MS SV-79 DOCUMENT PROCESSING
1800 Tapo Canyon
Simi Valley, CA 93063-6712

[Space Above This Line For Recording Data]

IN1517117052703
[Case #]

920031981
[Escrow/Closing #]

0002357383961090
[Doc ID #]

ASSIGNMENT OF MORTGAGE

KNOW ALL MEN BY THESE PRESENTS That
COUNTRYWIDE HOME LOANS, INC.
4500 Park Granada, Calabasas, CA 91302-1613
organized and existing under the laws of NEW YORK, party of the first part, for
value received, has granted, bargained, sold, assigned, transferred and set over, and by these presents does
grant, sell, assign, transfer and set over unto

THE LEADER MORTGAGE COMPANY
organized and existing under the laws of OHIO, whose location and mailing
address (if different) is
1015 EUCLID AVENUE, CLEVELAND, OH 44115
party of the second part, its successors and assigns, a certain indenture of mortgage dated
MAY 20, 2003, made by
CORNELL GARZA, AND NATALIE SCHROEDER, - JOINT

to it, securing the payment of one promissory note therein described for the sum of
ONE HUNDRED THREE THOUSAND SEVEN HUNDRED THIRTY THREE and 00/100
Dollars (\$ 103,733.00), and all its rights, title and interest in and to the premises situated in the
county of LAKE, State of Indiana, and described in said
mortgage as follows, to-wit:
LOT 18 IN ORCHARD HILL SUBDIVISION TO THE TOWN OF CEDAR LAKE, AS PER
PLAT THEREOF, RECORDED IN PLAT BOOK 49 PAGE 115. IN THE OFFICE OF THE
RECORDER OF LAKE COUNTY, INDIANA.

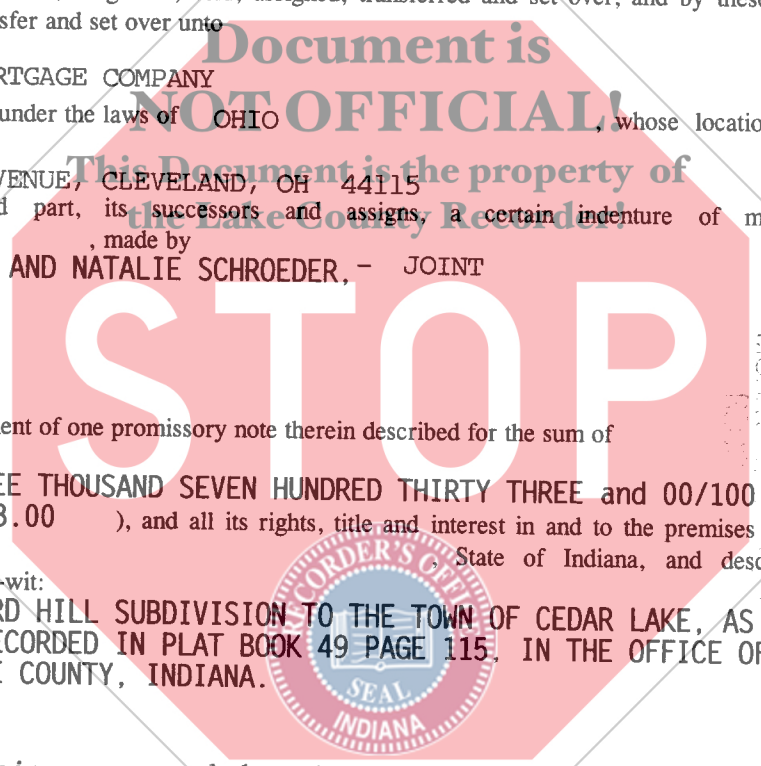

2003 076759

2003 JUL 21 11 11 AM '03

STATE OF INDIANA
LAKE COUNTY
FILED FOR RECORD

m-f 2003-052137
A-R-M 2003-076758

This document is being re-recorded to be consistent with the 2nd. Mortgage.

Indiana Assignment of Mortgage

Page 1 of 2

VMP-995(IN) (0001).01 CHL (12/00)

VMP MORTGAGE FORMS - (800)521-7291

Initials: KMN 1/00

23991

023573839000002995-

Tcor CP 920031981

15023
12.00

CASE #: IN1517117052703

DOC ID # 0002357383961090

which said mortgage is recorded in the office of the Recorder of
LAKE

County, in the State of Indiana, in Book No.

at Page as Document No.

together with the said note therein described

and the money due or to grow due thereon, with the interest:

TO HAVE AND TO HOLD the same unto the said party of the second part, its successors and assigns,
forever, subject only to the provisions in the said indenture of mortgage contained.

IN WITNESS WHEREOF, the party of the first part has caused this instrument to be executed in its name

by KELLY M NEFF

its LOAN SPECIALIST II

, and attested by JULI BELICEK

LOAN SPECIALIST II

, its

and its corporate seal to be hereunto affixed this

TWENTIETH day of MAY, A.D. 2003.

ATTEST:

COUNTRYWIDE HOME LOANS, INC.

Kelly M Neff

KELLY M NEFF, LOAN SPECIALIST II
STATE OF INDIANA
COUNTY OF LAKE

By: *Juli Belicek*

JULI BELICEK, LOAN SPECIALIST II

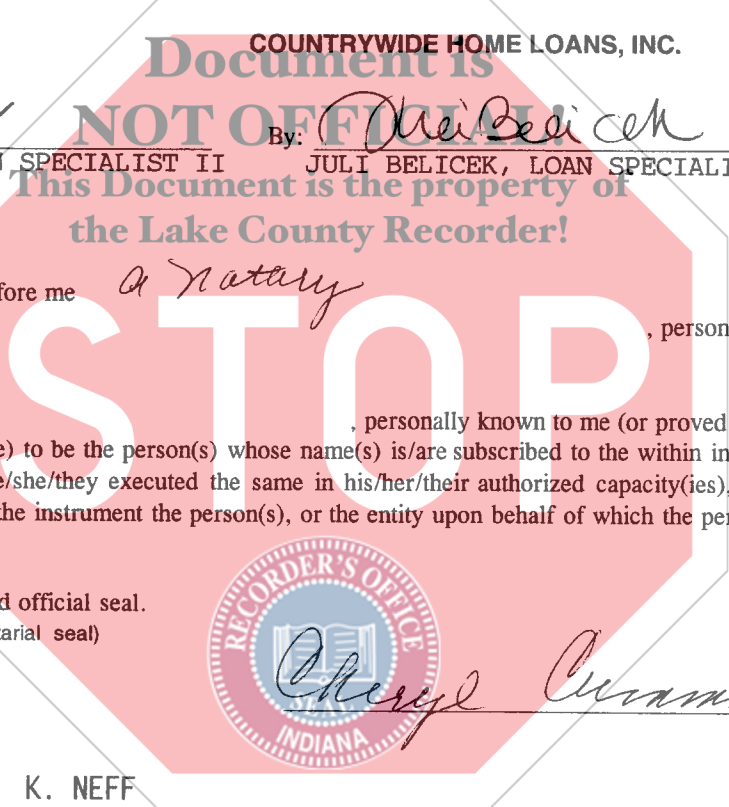

On 5/20/03, before me *a Notary*

, personally appeared

, personally known to me (or proved to me on the basis of satisfactory evidence) to be the person(s) whose name(s) is/are subscribed to the within instrument and acknowledged to me that he/she/they executed the same in his/her/their authorized capacity(ies), and that by his/her/their signature(s) on the instrument the person(s), or the entity upon behalf of which the person(s) acted, executed the instrument.

CHERYLE CUMMINGS
Notary Public
State of Indiana
My Commission Expires March 22, 2008



Cheryle Cummings (Seal)

This form was Prepared By: K. NEFF
COUNTRYWIDE HOME LOANS, INC.

address:
1525 US HIGHWAY 41 SUITE C-26, SCHERERVILLE, IN 46375-
tel. no.: (219)322-2802