

STATE OF INDIANA
LAKE COUNTY
FILED FOR RECORD

2003 073992
Parcel No. 23:9-45-39

2003 JUL 17 AM 9:42

WARRANTY DEED ORDER NO. 920035228

THIS INDENTURE WITNESSETH, That JEREMY CHARLES AND GINA CHARLES F/K/A GINA N. SESSA,
HUSBAND AND WIFE (Grantor)
of Lake County, in the State of INDIANA CONVEY(S) AND WARRANT(S)
to TIMOTHY L. HIPPI
(Grantee)
of Lake County, in the State of INDIANA, for the sum of TEN AND 00/100
TEN AND 00/100 Dollars (\$ 10.00)
and other valuable consideration, the receipt and sufficiency of which is hereby acknowledged, the following
described real estate in Lake County, State of Indiana:

The North 50 feet of the South 115 feet of the East 165 feet of that part of Block 3 in Pratt and Ruschli's
Subdivision, as per plat thereof, recorded in Plat Book 1 page 8, in the Office of the Recorder of Lake County,
Indiana, described as follows, to wit: Beginning at a point on the East line of Block 3, 160.61 feet South of the
Northeast corner; (the Northeast corner of said Block 3 being the intersection of the center line of Goldsborough
Street and the East line of the West Half of the Southwest Quarter of Section 5, Township 34 North, Range 8
West); thence South on the East line of said Block 3, 170 feet to the Southeast corner thereof; (the South line of
Block 3 being the center line of Porter Street); thence West along the South line of Block 3, 330.55 feet, more or
less, to the Southwest corner thereof; (the West line of Block 3 being in the center of Ruschli Street); thence North
along the West line of said Block 3, 170 feet; thence East 330.67 feet, more or less, to the place of beginning.

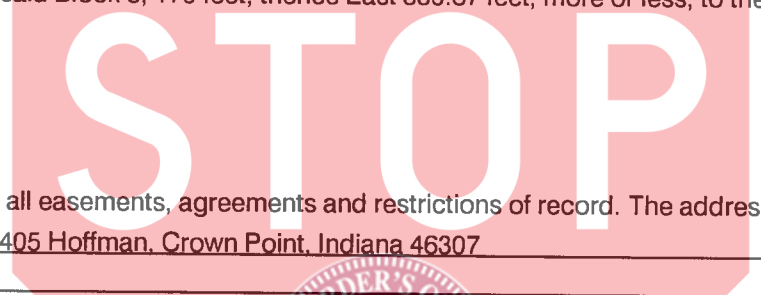

Subject to any and all easements, agreements and restrictions of record. The address of such real estate is
commonly known as 405 Hoffman, Crown Point, Indiana 46307

Tax bills should be sent to Grantee at such address unless otherwise indicated below.

IN WITNESS WHEREOF, Grantor has executed this deed this 11TH day of July, 2003.
Grantor: [Signature] (SEAL) Grantor: [Signature] (SEAL)
Printed Jeremy Charles Printed Gina Charles formerly known as Gina N. Sessa

STATE OF INDIANA }
COUNTY OF Lake } SS: ACKNOWLEDGEMENT

Before me, a Notary Public in and for said County and State, personally appeared JEREMY CHARLES AND GINA CHARLES F/K/A GINA N. SESSA
who acknowledge the execution of the foregoing Warranty Deed, and who, having been duly advised of what
any representations therein contained are true.

Witness my hand and Notarial Seal this 11TH day of July, 2003.

My commission expires:
OCTOBER 29, 2008

Signature [Signature] Notary Name STEPHEN R. STIGLICH
Printed Gloria Miller LAKE COUNTY AUDITOR
Resident of Lake Lake County

This instrument prepared by Atty. Thomas K. Hoffman
Return deed to 405 Hoffman, Crown Point, Indiana 46307

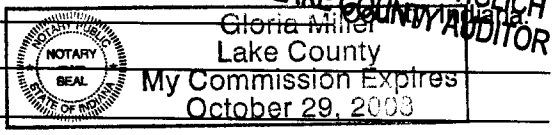

Send tax bills to 405 Hoffman, Crown Point, Indiana 46307

Ticor CP 920035228

001085

14. -
DG
TI