

2

STATE OF INDIANA)
COUNTY OF LAKE)ss:

IN RE: EFFIE PATTON, a/k/a Effie Jean Rowell-Lucas,
DECEDENT

AFFIDAVIT FOR TRANSFER OF REAL PROPERTY

PAMELA J. ROWELL, the undersigned, being first duly sworn upon her oath deposes and states that:

1. The above-named decedent died intestate on July 27, 2001, while domiciled in Lake County, Indiana.
2. More than forty-five (45) days have elapsed since the decedent's death.
3. No application or petition for the appointment of a personal representative is pending or has been granted in any jurisdiction.

4. That the following named persons are the heirs of the decedent:

Marvin Jones, adult son, 409 Jackson St., Gary, Indiana, 46402; George Jones, adult son, 5446 Lakeside Manor Lane, Indianapolis, IN 46254; Lynell Anderson, adult daughter, 3436 W. 53rd St., Indianapolis, IN 46228; Jon McReynolds, adult son, #7342729, Terminal Annex, P.O. Box 86164, Los Angeles, CA 90086; Pamela J. Rowell, adult daughter, 941 Clinton St. Gary, IN 46406; and Edgar Lucas, spouse, 941 Clinton St., Gary, IN 46406.

5. The value of the decedent's gross probate estate, less liens and encumbrances, does not exceed the sum of Twenty-Five Thousand Dollars (\$25,000) as provided by Indiana Code § 29-1-8-1.

6. Among the decedent's probate assets is a parcel of real estate, which was owned by the decedent, and is located in Lake County, Indiana, and is more particularly described as:

Lot s 41, 42, and 43, Block 3, King's Resubdivision of Blocks 3 and 6, J.R. Lane's First Addition to Ivanhoe, City of Gary, as shown in Plat Book 9, page 24, Lake County, Indiana. Key # 45-218-42. Commonly known as: 941, Clinton St., Gary, IN.

7. The following are the only known creditors of the estate:

CitiFinancial Services, Inc., 10435 Indianapolis Blvd., Ste. B, Highland, IN 46322, amount due approximately \$8,000; CitiFinancial Services, 111 N. Point Dr., Coppell TX, 75019,

2003 JUL 27 073861

2003 JUL 27 11:11 AM

FILED IN CLERK'S OFFICE LAKE COUNTY INDIANA

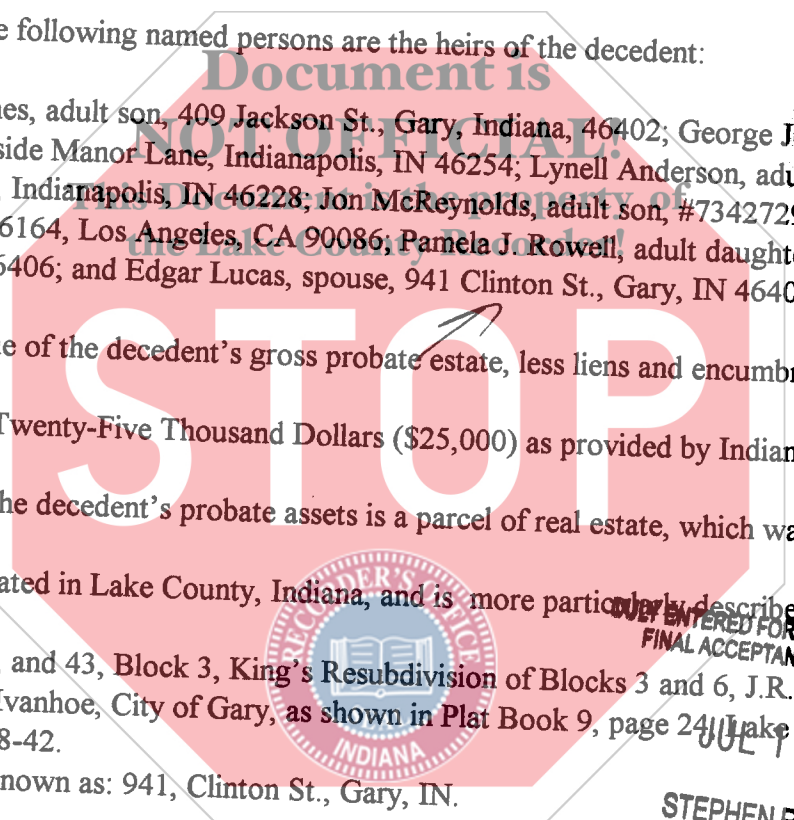

ENTERED FOR TAXATION SUBJECT TO FINAL ACCEPTANCE FOR TRANSFER

STEPHEN R. STIGLICH LAKE COUNTY AUDITOR

001139

Handwritten initials: BW, CS, CP

amount due \$43,000; and Ford Credit, P.O. Box 6440, Colorado Springs, CO 80962-4400, amount due approximately \$7,500.

8. The individuals entitled to the real estate as a result of the decedent's death are the decedent's heirs at law as provided under the laws of intestate succession, namely:

Marvin Jones, adult son, 409 Jackson St., Gary, Indiana, 46402; George Jones, adult son, 5446 Lakeside Manor Lane, Indianapolis, IN 46254; Lynell Anderson, adult daughter, 3436 W. 53rd St., Indianapolis, IN 46228; Jon McReynolds, adult son, #7342729, Terminal Annex, P.O. Box 86164, Los Angeles, CA 90086; Pamela J. Rowell, adult daughter, 941 Clinton St., Gary, IN 46406; and Edgar Lucas, spouse, 941 Clinton St., Gary, IN 46406.

9. That the gross value of the estate of the decedent, EFFIE PATTON, a/k/a Effie Jean Rowell-Lucas, as determined for the purposes of Federal Estate taxes, was less than the value required for the filing of a Federal Estate Tax Return. As a consequence thereof, the decedent's estate was not subject to Federal Estate Tax.

10. That the decedent's estate was not subject to Indiana Inheritance Tax.

I AFFIRM, under the penalties for perjury, that to the best of my knowledge the foregoing representations are true.

Date: 6-27-03

Pamela J Rowell
Pamela J. Rowell

STATE OF INDIANA)
)SS
COUNTY OF LAKE)

Before me the undersigned, a Notary Public for Porter County, State of Indiana personally appeared Pamela J. Rowell and she, being first duly sworn by me upon her oath, says that facts alleged in the foregoing instrument are true. Signed and sealed this 27th day of June 2003.

Signed: Lenore L. Heaphey
Printed: LENORE L. HEAPHEY
Notary Public
County of Residence Porter

My Commission Expires:
April 4, 2007

This instrument prepared by: Meyer & Wyatt, P.C., by Lenore L. Heaphey, Esq.