

2

(2)

STATE OF INDIANA
LAKE COUNTY
FILED RECORDS

2002 119570

2002 DEC 26 AM 9:38

RECORDS & CLERK
RECORDER

Parcel No. 16-27-312-36

CORPORATE WARRANTY DEED

56200 29513 LD

THIS INDENTURE WITNESSETH, That PRUDENTIAL RELOCATION, INC., FKA CITICAPITAL RELOCATION, INC., A Colorado Corporation (Grantor), a _____ organized and existing un the laws of the State of ARIZONA CONVEYS AND WARRANTS TO

GUSTAVO CARVAJAL AND DIANA CARVAJAL, JOINT TENANTS

(Grantee) of LAKE County, in the State of INDIANA, for the sum of TEN AND NO/100 Dollars (\$10.00) and other valuable consideration, the receipt and sufficiency of which is hereby acknowledged, the following described real estate in LAKE County, State of Indiana:

LOT 36, AND THE SOUTH 32-1/2 FEET OF LOT 37, IN BLOCK 1, IN PETTIT PARK 3RD ADDITION, TO THE TOWN OF HIGHLAND, AS PER PLAT THEREOF, RECORDED IN PLAT BOOK 33 PAGE 81, IN THE OFFICE OF THE RECORDER OF LAKE COUNTY, INDIANA

Subject to any and all easement, agreements and restrictions of record. The address of such real estate is commonly known as **8925 COTTAGE GROVE AVENUE, HIGHLAND, INDIANA 46322**. Tax bill should be sent to Grantee at such address unless otherwise indicated below.

The undersigned persons executing this deed on behalf of Grantor represents and certify that they are duly elected officers of Grantor and have been fully empowered, by proper resolution of the Board of Directors of Grantor, to execute and deliver Us deed; that Grantor has full corporate capacity to convey the real estate described herein; and that all necessary corporate action for the making of such conveyance has been taken and done.

IN WITNESS WHEREOF, Grantor has executed this deed this 20TH day of DECEMBER, 2002.

PRUDENTIAL RELOCATION, INC., FKA CITICAPITAL RELOCATION, INC.

BY:

NAME:

TITLE:

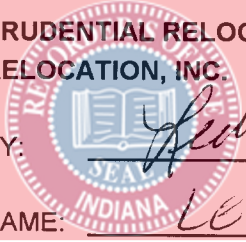

Leah Santaro

LEAH SANTARO

Asst Secy

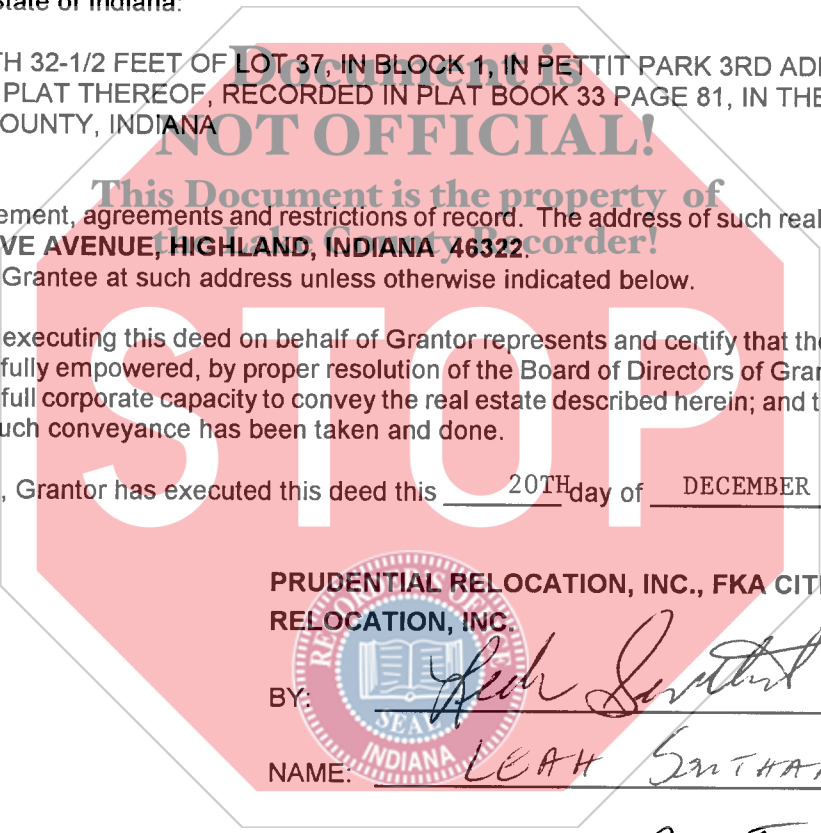

ALL FEES FOR PAGE 10, 11, 12, 13, 14, 15, 16, 17, 18, 19, 20, 21, 22, 23, 24, 25, 26, 27, 28, 29, 30, 31, 32, 33, 34, 35, 36, 37, 38, 39, 40, 41, 42, 43, 44, 45, 46, 47, 48, 49, 50, 51, 52, 53, 54, 55, 56, 57, 58, 59, 60, 61, 62, 63, 64, 65, 66, 67, 68, 69, 70, 71, 72, 73, 74, 75, 76, 77, 78, 79, 80, 81, 82, 83, 84, 85, 86, 87, 88, 89, 90, 91, 92, 93, 94, 95, 96, 97, 98, 99, 100, 101, 102, 103, 104, 105, 106, 107, 108, 109, 110, 111, 112, 113, 114, 115, 116, 117, 118, 119, 120, 121, 122, 123, 124, 125, 126, 127, 128, 129, 130, 131, 132, 133, 134, 135, 136, 137, 138, 139, 140, 141, 142, 143, 144, 145, 146, 147, 148, 149, 150, 151, 152, 153, 154, 155, 156, 157, 158, 159, 160, 161, 162, 163, 164, 165, 166, 167, 168, 169, 170, 171, 172, 173, 174, 175, 176, 177, 178, 179, 180, 181, 182, 183, 184, 185, 186, 187, 188, 189, 190, 191, 192, 193, 194, 195, 196, 197, 198, 199, 200, 201, 202, 203, 204, 205, 206, 207, 208, 209, 210, 211, 212, 213, 214, 215, 216, 217, 218, 219, 220, 221, 222, 223, 224, 225, 226, 227, 228, 229, 230, 231, 232, 233, 234, 235, 236, 237, 238, 239, 240, 241, 242, 243, 244, 245, 246, 247, 248, 249, 250, 251, 252, 253, 254, 255, 256, 257, 258, 259, 260, 261, 262, 263, 264, 265, 266, 267, 268, 269, 270, 271, 272, 273, 274, 275, 276, 277, 278, 279, 280, 281, 282, 283, 284, 285, 286, 287, 288, 289, 290, 291, 292, 293, 294, 295, 296, 297, 298, 299, 300, 301, 302, 303, 304, 305, 306, 307, 308, 309, 310, 311, 312, 313, 314, 315, 316, 317, 318, 319, 320, 321, 322, 323, 324, 325, 326, 327, 328, 329, 330, 331, 332, 333, 334, 335, 336, 337, 338, 339, 340, 341, 342, 343, 344, 345, 346, 347, 348, 349, 350, 351, 352, 353, 354, 355, 356, 357, 358, 359, 360, 361, 362, 363, 364, 365, 366, 367, 368, 369, 370, 371, 372, 373, 374, 375, 376, 377, 378, 379, 380, 381, 382, 383, 384, 385, 386, 387, 388, 389, 390, 391, 392, 393, 394, 395, 396, 397, 398, 399, 400, 401, 402, 403, 404, 405, 406, 407, 408, 409, 410, 411, 412, 413, 414, 415, 416, 417, 418, 419, 420, 421, 422, 423, 424, 425, 426, 427, 428, 429, 430, 431, 432, 433, 434, 435, 436, 437, 438, 439, 440, 441, 442, 443, 444, 445, 446, 447, 448, 449, 450, 451, 452, 453, 454, 455, 456, 457, 458, 459, 460, 461, 462, 463, 464, 465, 466, 467, 468, 469, 470, 471, 472, 473, 474, 475, 476, 477, 478, 479, 480, 481, 482, 483, 484, 485, 486, 487, 488, 489, 490, 491, 492, 493, 494, 495, 496, 497, 498, 499, 500, 501, 502, 503, 504, 505, 506, 507, 508, 509, 510, 511, 512, 513, 514, 515, 516, 517, 518, 519, 520, 521, 522, 523, 524, 525, 526, 527, 528, 529, 530, 531, 532, 533, 534, 535, 536, 537, 538, 539, 540, 541, 542, 543, 544, 545, 546, 547, 548, 549, 550, 551, 552, 553, 554, 555, 556, 557, 558, 559, 560, 561, 562, 563, 564, 565, 566, 567, 568, 569, 570, 571, 572, 573, 574, 575, 576, 577, 578, 579, 580, 581, 582, 583, 584, 585, 586, 587, 588, 589, 590, 591, 592, 593, 594, 595, 596, 597, 598, 599, 600, 601, 602, 603, 604, 605, 606, 607, 608, 609, 610, 611, 612, 613, 614, 615, 616, 617, 618, 619, 620, 621, 622, 623, 624, 625, 626, 627, 628, 629, 630, 631, 632, 633, 634, 635, 636, 637, 638, 639, 640, 641, 642, 643, 644, 645, 646, 647, 648, 649, 650, 651, 652, 653, 654, 655, 656, 657, 658, 659, 660, 661, 662, 663, 664, 665, 666, 667, 668, 669, 670, 671, 672, 673, 674, 675, 676, 677, 678, 679, 680, 681, 682, 683, 684, 685, 686, 687, 688, 689, 690, 691, 692, 693, 694, 695, 696, 697, 698, 699, 700, 701, 702, 703, 704, 705, 706, 707, 708, 709, 710, 711, 712, 713, 714, 715, 716, 717, 718, 719, 720, 721, 722, 723, 724, 725, 726, 727, 728, 729, 730, 731, 732, 733, 734, 735, 736, 737, 738, 739, 740, 741, 742, 743, 744, 745, 746, 747, 748, 749, 750, 751, 752, 753, 754, 755, 756, 757, 758, 759, 760, 761, 762, 763, 764, 765, 766, 767, 768, 769, 770, 771, 772, 773, 774, 775, 776, 777, 778, 779, 780, 781, 782, 783, 784, 785, 786, 787, 788, 789, 790, 791, 792, 793, 794, 795, 796, 797, 798, 799, 800, 801, 802, 803, 804, 805, 806, 807, 808, 809, 810, 811, 812, 813, 814, 815, 816, 817, 818, 819, 820, 821, 822, 823, 824, 825, 826, 827, 828, 829, 830, 831, 832, 833, 834, 835, 836, 837, 838, 839, 840, 841, 842, 843, 844, 845, 846, 847, 848, 849, 850, 851, 852, 853, 854, 855, 856, 857, 858, 859, 860, 861, 862, 863, 864, 865, 866, 867, 868, 869, 870, 871, 872, 873, 874, 875, 876, 877, 878, 879, 880, 881, 882, 883, 884, 885, 886, 887, 888, 889, 890, 891, 892, 893, 894, 895, 896, 897, 898, 899, 900, 901, 902, 903, 904, 905, 906, 907, 908, 909, 910, 911, 912, 913, 914, 915, 916, 917, 918, 919, 920, 921, 922, 923, 924, 925, 926, 927, 928, 929, 930, 931, 932, 933, 934, 935, 936, 937, 938, 939, 940, 941, 942, 943, 944, 945, 946, 947, 948, 949, 950, 951, 952, 953, 954, 955, 956, 957, 958, 959, 960, 961, 962, 963, 964, 965, 966, 967, 968, 969, 970, 971, 972, 973, 974, 975, 976, 977, 978, 979, 980, 981, 982, 983, 984, 985, 986, 987, 988, 989, 990, 991, 992, 993, 994, 995, 996, 997, 998, 999, 1000

DEC 24 2002

PETER BENJAMIN
LAKE COUNTY AUDITOR

*167
n.A
01*

Acknowledgment

STATE OF INDIANA
COUNTY OF BENSON

Before me, a Notary Public in and for said County and State, personally appeared LEAH SOUTHARD, the ASST. SECRETARY Respectively of PRUDENTIAL RELOCATION, INC., FKA CITICAPITAL RELOCATION, INC., A Colorado Corporation, who acknowledged execution of the foregoing Deed for and on behalf of said Grantor, and who, having been duly sworn, stated that the representation therein contained are true.

Witness my hand and Notarial Seal this 17th day of Dec., 2002.

My commission expires: 04-16-05

Signature: [Handwritten Signature]
Printed LINDA REAL, Notary Public
Resident of TEXAS County, New York

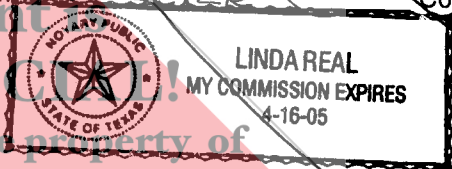

This instrument prepared by:
Beadles, Newman and Lawler
3500 Hulen Street
Fort Worth, Tx 76107

This Document is the property of
the Lake County Recorder!

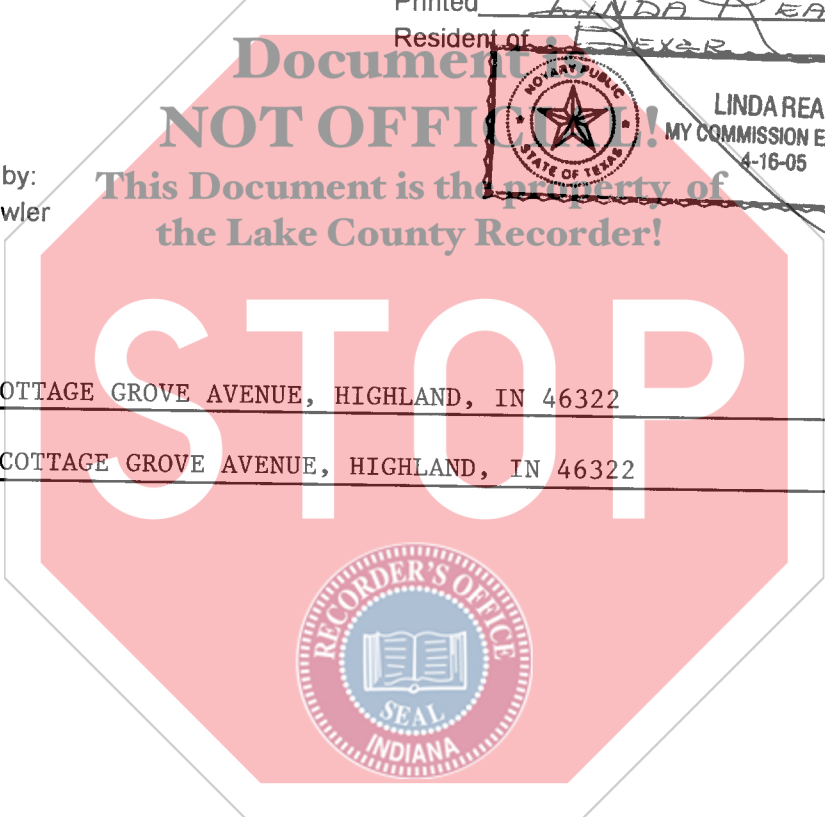

Return deed to 8925 COTTAGE GROVE AVENUE, HIGHLAND, IN 46322

Send tax bills to 8925 COTTAGE GROVE AVENUE, HIGHLAND, IN 46322

