

# KUZMA ESTATES

## AN ADDITION TO LAKE COUNTY, INDIANA

ALL PLATTED FROM  
KEY 7-14-62#63  
DULY ENTERED FOR TAXATION SUBJECT TO  
FINAL ACCEPTANCE FOR TRANSFER

DEC 18 2002  
NEW KEY 7-375-142  
PETER BENJAMIN  
LAKE COUNTY AUDITOR  
LOTS 1 & 2



NORTH



SCALE : 1" = 80'

BASIS OF BEARING : BEARING BASED ON SOUTH  
LINE S.E. 1/4 • N 88°52'13" W.

### LEGAL DESCRIPTION:

Part of the Southeast Quarter of Section 18, Township 34 North, Range 8 West of the Second Principal Meridian, in Lake County, Indiana described as follows: Commencing at a P.K. Nail found 1988 71 feet West of the Southeast corner of said Section 18, said point being the Southwest corner of the East Half of the Southwest Quarter of the Southeast Quarter of Section 18, thence North 00°30'20" East along the West line of the Southeast Quarter of the Southwest Quarter of the Southeast Quarter of said Section 18, 124.3 feet to an iron pipe found and the point of beginning, thence continue North 00°30'20" East along said West line a distance of 398.95 feet, thence South 88°51'35" East on a line parallel to the South line of said Section 18 a distance of 749.39 feet, thence South 59°21'00" East a distance of 403.03 feet more or less to the center of Cedar Lake Road, thence South 30°39'00" West along the center of Cedar Lake Road a distance of 118.84 feet, thence North 61°01'00" West a distance of 399.90 feet, thence South 29°12'45" West a distance of 319.22 feet, thence North 89°04'56" West a distance of 533.37 feet to the point of beginning, containing 7.01 acres.

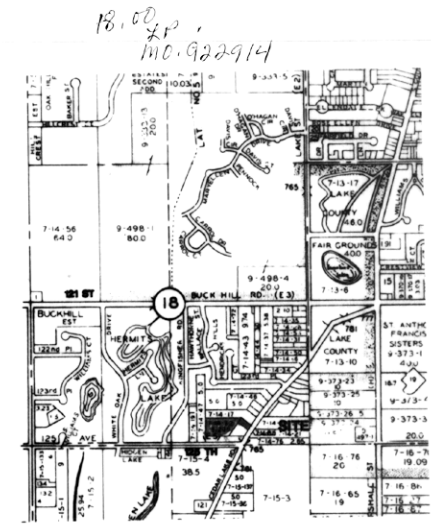

VICINITY MAP  
SEC. 18 - 34 - 8

### CERTIFICATE OF MAINTENANCE RESPONSIBILITY

By acceptance of this Plat, the County assumes no liability for maintenance on drainage swales, ditches and tiles, roadside ditches, storm and sanitary sewers, septic systems, retention and detention ponds, overflow pipes, and park areas found on the entire plat.

### UTILITY EASEMENT

An easement is hereby granted to the County of Lake, all public utility companies including Ameritech and Northern Indiana Public Service Company severally, and private utility companies where they have a "Certificate of Territorial Authority" to render service, and their respective successors and assigns, to install, place, and maintain sewers, water mains, gas mains, conduits, cables, poles and wires— either overhead or underground with all necessary braces, guys, anchors, and other appliances in, upon, and along and over the strips of land designated on the plat and marked "Utility Easement" for the purpose of serving the public in general with sewer, water, gas, electric and telephone service, including the right to use the streets where necessary, and to overlaid lots with aerial service wires to serve adjacent lots, together with the right to enter upon the said easements for the public utilities at all times for any and all the purposes aforesaid and to trim and keep trimmed any trees, shrubs, or saplings that interfere with any such utility equipment. No permanent buildings shall be placed on said easement, but same may be used for gardens, shrub, landscaping, and other purposes that do not interfere with the use of said easement for such public utility purpose.

### DRAINAGE EASEMENT

An easement is hereby granted to the County of Lake for the installation of a drainage swale, ditch, or waterway upon and along the strip or strips of land designated on the plat and marked "Drainage Easement" for the purpose of handling the storm water run-off.

We, the undersigned, Jeffrey P. Kuzma and Laura Kuzma, owners of the real estate shown and described herein, do hereby certify that we have laid off, platted and subdivided, and do hereby lay off, plat and subdivide real estate in accordance with the within drawn plat. This subdivision shall be known and designated as KUZMA ESTATES. All streets, alleys, parks and other public lands shown and not heretofore dedicated, are hereby established as shown on this plat, between which lines and the property lines of the street, there shall be erected or maintained no building structure.

WITNESS OUR HANDS AND SEALS THIS 26<sup>th</sup> DAY OF November, 2002.

*Jeffrey P. Kuzma*  
JEFFREY P. KUZMA

*Laura Kuzma*  
LAURA KUZMA  
AKA LAURA J. KUZMA

STATE OF INDIANA)  
COUNTY OF LAKE )

Before me, the undersigned Notary Public in and for the County of Lake, State of Indiana, appeared JEFFREY P. KUZMA and LAURA KUZMA, and each separately and severally acknowledged the execution of the foregoing instrument as his or her voluntary act and deed, for the purpose therein expressed.

Witness my hand and Notarial Seal this 26<sup>th</sup> day of November, 2002.

Under authority provided by Chapter 174, Acts of 1947, enacted by the General Assembly of the State of Indiana and Ordinance adopted by the Board of County Commissioners of the County of Lake, Indiana, this plat was given by the County of Lake as follows:

Approved by the County Plan Commission at a meeting held on

6<sup>th</sup> day of November, 2002.

*William Rutz*  
President

*Wilbur F. Cox*  
Executive Secretary - Wilbur F. Cox

I, Glenn H. Kracht, hereby certify that I am a Registered Land Surveyor, licensed in compliance with the laws of the State of Indiana, that this plat correctly represents a survey completed by me on JULY 19, 2002; that all the monuments shown actually exist; and that their location, size, type and material are accurately shown.

*Glenn H. Kracht*  
Glenn H. Kracht IN No. 29400001



**GKA** GLENN KRACHT ASSOCIATES  
314 FAIRFIELD DRIVE CROWN POINT, IN 46307 PHONE: 219.663-8823 FAX: 219.663-8888

