

FILED

TOWN OF SCHERERVILLE, LAKE COUNTY, INDIANA

DEC 13 2002

ORDINANCE NO.: 2002-1563

PETER BENJAMIN  
LAKE COUNTY AUDITOR

AN ORDINANCE AMENDING TOWN CODE SECTIONS 3-1 AND 3-2 PERTAINING TO THE METHOD BY WHICH TOWN COUNCIL MEMBERS ARE ELECTED AND PERTAINING TO THE GEOGRAPHIC BOUNDARIES OF DISTRICTS (WARDS) IN THE TOWN OF SCHERERVILLE, AND REPEALING ALL TOWN CODE SECTIONS AND ORDINANCES, OR PARTS THEREOF, IN CONFLICT HEREWITH.

WHEREAS, the Town Council of the Town of Schererville, Lake County, Indiana, has reviewed the matters pertaining to Ward Boundary districts for the Town of Schererville as required by the Statutes of the State of Indiana, specifically I.C. §36-5-2-4.1, I.C. §36-5-2-5, and I.C. §3-11-1.5-32; and

WHEREAS, the Town Council of the Town of Schererville, Lake County, Indiana, has reviewed Town Code Section 3-1(c) pertaining to the current method by which Town Council members are elected; and

WHEREAS, the Town Council of the Town of Schererville, Lake County, Indiana, has reviewed Town Code Section 3-2(b) pertaining to the current District (Ward) Boundaries; and

WHEREAS, the Town Council of the Town of Schererville, Lake County, Indiana, has reviewed the current census data recently received relating to the population throughout the Town of Schererville; and

WHEREAS, the Town Council of the Town of Schererville, Lake County, Indiana, has determined that the present Ward Boundary District delineations set forth in Schererville Town Code Section 3-2(b) are inadequate according to the current census data; and

WHEREAS, the Town Council of the Town of Schererville, Lake County, Indiana, has determined it advisable to redistrict the Town of Schererville during the current year in order to comply with the Statutes of the State of Indiana and in order for the Town districts (wards) to be composed of contiguous territory, be reasonably compact, and contain (as nearly as possible) equal population; and

WHEREAS, Town Council of the Town of Schererville, Lake County, Indiana, has determined it advisable to change the method by which Town Council members are elected from individual districts (wards) to at-large (town wide); and

10 E Soliet St  
Schererville, IN 46375

001066

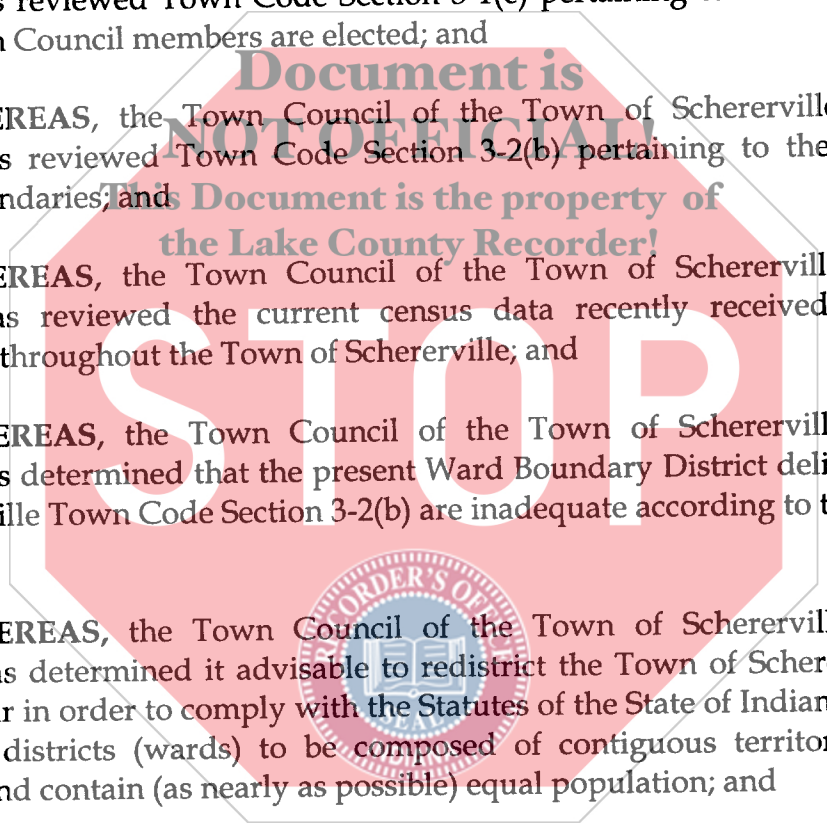

2002 DEC 13 11:12 AM  
LAKE COUNTY RECORDER

30%

WHEREAS, Town Council of the Town of Schererville, Lake County, Indiana, has determined it advisable to adopt and pass this Ordinance in 2002 and to make the effective date of this Ordinance January 1, 2004, in order to not possibly disenfranchise voters for the next municipal election and in order for the Town to comply with the provisions of I.C. §36-5-2-4.1, I.C. §36-5-2-5, and I.C. §3-11-1.5-32; and

WHEREAS, the Town Council of the Town of Schererville, Lake County, Indiana, having reviewed applicable State law and the current Town Code Sections set forth, namely, Sections 3-1(c), 3-1(d), and 3-2(b), now concurs that it is advisable, necessary, and in the best interests of the residents of the Town of Schererville that amendments to said Town Code Sections and Ordinances, or parts thereof, are appropriate.

NOW, THEREFORE, BE IT ORDAINED BY THE TOWN COUNCIL OF THE TOWN OF SCHERERVILLE, LAKE COUNTY, INDIANA, AS FOLLOWS:

**SECTION ONE:** That Town Code Section 3-1(c), entitled **Five (5) Member Council**, of Article 1, entitled **TOWN COUNCIL**, of the Schererville Town Code, be, and the same is amended to read and provide as follows, namely:

**"Sec. 3-1 Five (5) Member Council**

c. The members of the Town Council shall be elected at large by the voters."

**SECTION TWO:** That Town Code Section 3-1(d), entitled **Five (5) Member Council**, of Article 1, entitled **TOWN COUNCIL**, of the Schererville Town Code, be, and the same is amended to read, added, and provide as follows, namely:

**"Sec. 3-1 Five (5) Member Council**

d. The members of the Town Council shall be residents of the district (ward) to which they are elected to represent."

**SECTION THREE:** That Town Code Section 3-2(b), entitled **Five (5) Legislative Districts (Wards)**, of Article 1, entitled **TOWN COUNCIL**, of the Schererville Town Code, be, and the same is amended to read and provide as follows, namely:

**"Sec. 3-2 Five (5) Legislative Districts (Wards).**

b. **Geographic Boundaries.**

The geographical boundaries of the five (5) districts (wards) for the purpose of conducting elections and determining residency of the Town Council Members along with the population of each such district, shall be modified as set forth on the map

attached hereto as Exhibit "A", incorporated herein by reference and specifically made part of this Ordinance.

The District (Ward) Boundaries shall be as set forth hereafter, namely:

1. **District "Ward One"**

Beginning at the Northeast corner of Section 13, Township 35 North, Range 9 West of the Second Principle Meridian, Thence Southerly, a distance of 7304 feet to the centerline of U.S. 30; Thence Westerly along the centerline of U.S. 30, a distance of 6764 feet to the intersection of U.S. 30 and Harvest Dr.; Thence Southerly, along the centerline of Harvest Dr., a distance of 1422 feet to the intersection of Harvest Dr. and Autumn Dr.; Thence Easterly along the centerline of Autumn Dr., a distance of 950 feet; Thence Southerly along the centerline Morningside Dr., a distance of 1368 feet to the intersection of Morningside Dr. and Ridgely St.; Thence Easterly along the centerline of Ridgely St., a distance of 318 feet to the intersection of Ridgely St. and Burge Dr.; Thence Southerly along the centerline of Burge Dr., a distance of 1312 feet to the intersection of Burge Dr. and Justice Dr., Thence westerly along the centerline of justice Dr., a distance of 706 feet; Thence Southeasterly, a distance of 317 feet to the centerline of Krame Dr.; Thence Easterly along the centerline of Krame Dr., a distance of 578 feet to the intersection of Krame Dr. and Burge Dr.; Thence Southerly along the centerline of Burge Dr., a distance of 840 feet to the intersection of Burge Dr. and 85<sup>th</sup> Ave.; Thence Westerly, a distance of 192 feet to the Southwest corner of Section 24; Thence Northerly, a distance of 713 feet; Thence Westerly, a distance of 840 feet to the centerline of Rohrman Rd.; Thence Northwesterly along the centerline of Rohrman Rd., a distance of 1280 feet; Thence Westerly, a distance of 3574 feet to the centerline of Cline Ave.; Thence Southerly along the centerline of Cline Ave., a distance of 184 feet; Thence Westerly, a distance of 2668 feet; Thence Northerly, a distance of 3910 feet to the centerline of 77<sup>th</sup> Ave.; Thence Easterly along the centerline of 77<sup>th</sup> Ave., a distance of 2660 feet to Cline Ave.; Thence Northerly along the centerline of Cline Ave., a distance of 1738 feet to the intersection of Cline Ave. and Newcastle Dr.; Thence Westerly along the centerline of Newcastle Dr., a distance of 713 feet to the centerline of the Turkey Creek Ditch; Thence Southerly along the centerline of the Turkey Creek Ditch; a distance of 520 feet to the centerline of U.S. 30; Thence Westerly along the centerline of U.S. 30, a distance of 758 feet; Thence Northerly along the extended centerline of Govert Dr., a distance of 1052 feet to the intersection of Govert Dr. and Knoxbury Dr.; Thence Easterly along the centerline of Knoxbury Dr., a distance of 1490 feet to the intersection of Knoxbury Dr. and Cline Ave.; Thence Northerly along the centerline of Cline Ave., a distance of 3152 feet; Thence Easterly, a distance of 1000 feet; Thence Southerly, a distance of 338 feet; Thence Easterly, a distance of 327 feet to the centerline of Broad St.; Thence Southerly along the centerline of Broad St., a distance of 218 feet to the intersection of Broad St. and Joliet St.; Thence Easterly along the centerline of Joliet St., a distance of 2672 feet; Thence Southerly, a distance of 2571 feet; Thence Easterly, a distance of 4898 feet to the centerline of Forest Ridge Dr.; Thence Northerly along the centerline of Forest Ridge

Dr., a distance of 333 feet to the intersection of Forest Ridge Dr. and County Road 330, Thence Easterly along the centerline of County Road 330, a distance of 148 feet; Thence Southerly, a distance of 770 feet; Thence Easterly, a distance of 238 feet; Thence Northerly, a distance of 1800 feet; Thence Westerly, a distance of 1753 feet; Thence Northwesterly, a distance of 4941 feet to the centerline of the Turkey Creek Ditch; Thence Easterly along the centerline of the Turkey Creek Ditch, a distance of 3400 feet; Thence Southerly, a distance of 2870 feet; Thence Easterly, a distance of 2616 feet to the point of beginning.

**2. District "Ward Two"**

Beginning at the Northeast corner of Section 10, Township 35 North, Range 9 West of the Second Principle Meridian, Thence Westerly along the centerline of Division St., a distance of 5284 feet; Thence Northerly, a distance of 5510 feet the centerline of Main St.; Thence Westerly along the centerline of Main St., a distance of 10654 feet to the intersection of Main St. and the former Conrail Right-of-Way; Thence Southeasterly along the centerline of the former Conrail Right-of-way, a distance of 1113 feet to the extended intersection of Elm Ct.; Thence Northeasterly along the extended intersection of Elm Ct., a distance of 402 feet to the intersection of Elm Ct. and Woodhollow Dr.; Thence Southeasterly along the centerline of Woodhollow Dr., a distance of 316 feet to the intersection of Woodhollow Dr. and Oak Ct.; Thence Southwesterly along the centerline of Oak Ct. to the centerline of the former Conrail Right-of-way; Thence Southeasterly along the centerline of the former Conrail Right-of-way, a distance of 2070 feet; Thence Northeasterly along the centerline of Cypress Dr., a distance of 560 feet to the intersection of Cypress Dr. and Lisa Ln.; Thence Northwesterly along the centerline of Lisa Ln. a distance of 923 feet to the intersection of Lisa Ln. and Woodhollow Dr.; Thence Easterly along the centerline of Woodhollow Dr., a distance of 3391 feet to the intersection of Woodhollow Dr. and U.S. 41; Thence Southerly along the centerline of U.S. 41, a distance of 9824 feet to the intersection of U.S. 41 and U.S. 30; Thence Easterly along the centerline of U.S. 30, a distance of 2175 feet to the intersection of U.S. 30 and Joliet St.; Thence Easterly along the centerline of Joliet St. a distance of 3708 feet to the centerline of the former Conrail Right-of-Way; Thence Southeasterly along the centerline of the former Conrail Right-of-Way, a distance of 4892 feet to the intersection of U.S. 30 and the former Conrail Right-of-Way; Thence Northerly along the extended intersection of Govert Dr, a distance of 1052 to the intersection of Govert Dr. and Knoxbury Dr.; Thence Easterly along the centerline of Knoxbury Dr., a distance of 1490 feet to the intersection of Knoxbury Dr. and Cline Ave.; Thence Northerly along the centerline of Cline Ave., a distance of 8096 feet to the point of beginning.

**3. District "Ward Three"**

Beginning at the Intersection of Joliet St. and U.S. 30; Thence Westerly along the centerline of U.S. 30, a distance of 871 feet to the intersection of U.S. 30 and the Norfolk Southern Rail Road Right-of-Way; Thence Southerly along Norfolk Southern Rail Road Right-of-Way, a distance of 4267 feet to the intersection of the Norfolk Southern Rail



Road Right-of-Way and 77<sup>th</sup> Ave.; Thence Westerly along the centerline of 77<sup>th</sup> Ave., a distance of 1194 feet to the intersection of 77<sup>th</sup> Ave. and U.S. 41; Thence Southerly along the centerline of U.S. 41, a distance of 2650 feet; Thence Easterly; a distance of 1310 feet to the centerline of Alexander Ave.; Thence Southerly along Alexander Ave., a distance of 1526 feet; Thence Easterly, a distance 1944 feet; Thence Southerly, a distance of 1146 feet to the centerline of 85<sup>th</sup> Ave.; Thence Easterly along the centerline of 85<sup>th</sup> Ave., a distance of 1407 feet; Thence Northerly, a distance of 2344 feet; Thence Easterly, a distance of 630 feet; Thence Northerly, a distance of 2926 feet to the centerline of 77<sup>th</sup> Ave.; Thence Easterly along the centerline of 77<sup>th</sup> Ave., a distance of 5320 feet to Cline Ave.; Thence Northerly along the centerline of Cline Ave., a distance of 1738 feet to the intersection of Cline Ave. and Newcastle Dr.; Thence Westerly along the centerline of Newcastle Dr., a distance of 713 feet to the centerline of the Turkey Creek Ditch; Thence Southerly along the centerline of the Turkey Creek Ditch; a distance of 520 feet to the centerline of U.S. 30; Thence Westerly along the centerline of U.S. 30, a distance of 758 feet to the intersection of U.S. 30 and the former Conrail Right-of-Way; Thence Northwesterly along the former Conrail Right-of-Way, a distance of 4892 feet to the centerline of Joliet St.; Thence Westerly along the centerline of Joliet St., a distance of 3708 feet to the point of beginning.

**4. District "Ward Four"**

Beginning at the intersection of Main St. and the former Conrail Right-of-Way; Thence Southeasterly along the centerline of the former Conrail Right-of-way, a distance of 1113 feet to the extended intersection of Elm Ct.; Thence Northeasterly along the extended intersection of Elm Ct., a distance of 402 feet to the intersection of Elm Ct. and Woodhollow Dr.; Thence Southeasterly along the centerline of Woodhollow Dr., a distance of 316 feet to the intersection of Woodhollow Dr. and Oak Ct.; Thence Southwesterly along the centerline of Oak Ct. to the centerline of the former Conrail Right-of-way; Thence Southeasterly along the centerline of the former Conrail Right-of-way, a distance of 2070 feet; Thence Northeasterly along the centerline of Cypress Dr., a distance of 560 feet to the intersection of Cypress Dr. and Lisa Ln.; Thence Northwesterly along the centerline of Lisa Ln. a distance of 923 feet to the intersection of Lisa Ln. and Woodhollow Dr.; Thence Easterly along the centerline of Woodhollow Dr., a distance of 3391 feet to the intersection of Woodhollow Dr. and U.S. 41; Thence Southerly along the centerline of U.S. 41, a distance of 9824 feet to the intersection of U.S. 41 and U.S. 30; Thence Easterly along the centerline of U.S. 30, a distance of 1280 feet to the intersection of U.S. 30 and the Norfolk Southern Rail Road Right-of-Way; Thence Southerly along Norfolk Southern Rail Road Right-of-Way, a distance of 4267 feet to the intersection of the Norfolk Southern Rail Road Right-of-Way and 77<sup>th</sup> Ave.; Thence Westerly along the centerline of 77<sup>th</sup> Ave., a distance of 1194 feet to the intersection of 77<sup>th</sup> Ave. and U.S. 41; Thence Southerly along the centerline of U.S. 41, a distance of 2650 feet; Thence Westerly, a distance of 280 feet; Thence Northerly, a distance of 471 feet; Thence Westerly, a distance of 144 feet; Thence Northerly, a distance of 510 feet; Thence Westerly, a distance of 135 feet; Thence Northerly, a

distance of 306 feet; Thence Westerly, a distance of 4782 feet; Thence Northerly, a distance of 11961 feet to the centerline of 213<sup>th</sup> Ave.; Thence Easterly along the centerline of 213<sup>th</sup> Ave., a distance of 588 feet; Thence Northerly, a distance of 1411 feet; Thence Northwesterly, a distance of 609 feet to the West line of Section 5, Township 35 North, Range 9 West of the Second Principle Meridian; Thence Northerly along the said West line of Section 5, a distance of 3825 feet to the centerline of the former Conrail Right-of-Way; Thence Northwesterly along the centerline of the former Conrail Right-of-Way, a distance of 129 feet to the point of beginning. Also including the Briar Ridge C.C. Subdivision Additions lying in the East half of the East quarter of Section 6, Township 35 North, Range 9 West of the Second Principle Meridian.

**5. District "Ward Five"**

Beginning at the Southeast corner of Section 25, Township 35 North, Range 9 West of the Second Principle Meridian, Thence Northerly, a distance of 8644 feet to the centerline of U.S. 30; Thence Westerly along the centerline of U.S. 30, a distance of 6764 feet to the intersection of U.S. 30 and Harvest Dr.; Thence Southerly, along the centerline of Harvest Dr., a distance of 1422 feet to the intersection of Harvest Dr. and Autumn Dr.; Thence Easterly along the centerline of Autumn Dr., a distance of 950 feet; Thence Southerly along the centerline Morningside Dr., a distance of 1368 feet to the intersection of Morningside Dr. and Ridgely St.; Thence Easterly along the centerline of Ridgely St., a distance of 318 feet to the intersection of Ridgely St. and Burge Dr.; Thence Southerly along the centerline of Burge Dr., a distance of 1312 feet to the intersection of Burge Dr. and Justice Dr.; Thence westerly along the centerline of justice Dr., a distance of 706 feet; Thence Southeasterly, a distance of 317 feet to the centerline of Krame Dr.; Thence Easterly along the centerline of Krame Dr., a distance of 578 feet to the intersection of Krame Dr. and Burge Dr.; Thence Southerly along the centerline of Burge Dr., a distance of 840 feet to the intersection of Burge Dr. and 85<sup>th</sup> Ave.; Thence Easterly along the centerline of 85<sup>th</sup> Ave., a distance of 734 feet; Thence Northerly a distance of 1801 feet; Thence Easterly, a distance of 396 feet; Thence Northerly, a distance of 849 feet; Thence Easterly, a distance of 1332 feet to the center of Section 24, Township 35 North, Range 9 West of the Second Principle Meridian, which is also the centerline of Burr St.; Thence Southerly along the extended centerline of Burr St., a distance of 7935 feet, Thence Easterly, a distance of 2649 feet to the point of beginning."

**SECTION FOUR:** That all existing Ordinances, or parts thereof, in conflict with the provisions of this Ordinance, are hereby deemed null, void, and of no legal effect, and are specifically repealed.

**SECTION FIVE:** If any section, clause, provision or portion of this Ordinance shall be held to be invalid or unconstitutional by any Court of competent jurisdiction, such decision shall not affect any other section, clause, provision or portion of this Ordinance.

**SECTION SIX:** That this Ordinance shall take effect January 1, 2004, pursuant to I.C §36-5-2-5, from and after its passage by the Town Council of the Town of Schererville, Lake County, Indiana, and recorded in conformance with applicable law.

ALL OF WHICH IS PASSED AND ADOPTED BY THE TOWN COUNCIL OF THE TOWN OF SCHERERVILLE, LAKE COUNTY, INDIANA, THIS 12<sup>th</sup> DAY OF December, 2002.

TOWN OF SCHERERVILLE,  
LAKE COUNTY, INDIANA,  
TOWN COUNCIL

  
MICHAEL A. TROXELL, President

\_\_\_\_\_  
JOHN H. FLADELAND, Vice President

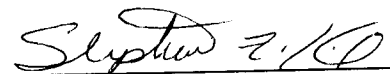
  
STEPHEN Z. KIL, Member

  
ROB GUETZLOFF, Member

\_\_\_\_\_  
EDWARD P. COOK, JR., Member

ATTEST:

  
JANICE M. MALINOWSKI, Clerk-Treasurer



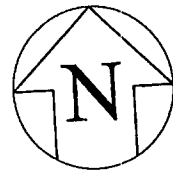

# Town of SCHERERVILLE INDIANA

## Street Map

EXHIBIT A

Document is  
**NOT OFFICIAL!**

This Document is the property of  
the Lake County Recorder!

STOP





FILED

DEC 13 2002

PETER BENJAMIN  
LAKE COUNTY AUDITOR

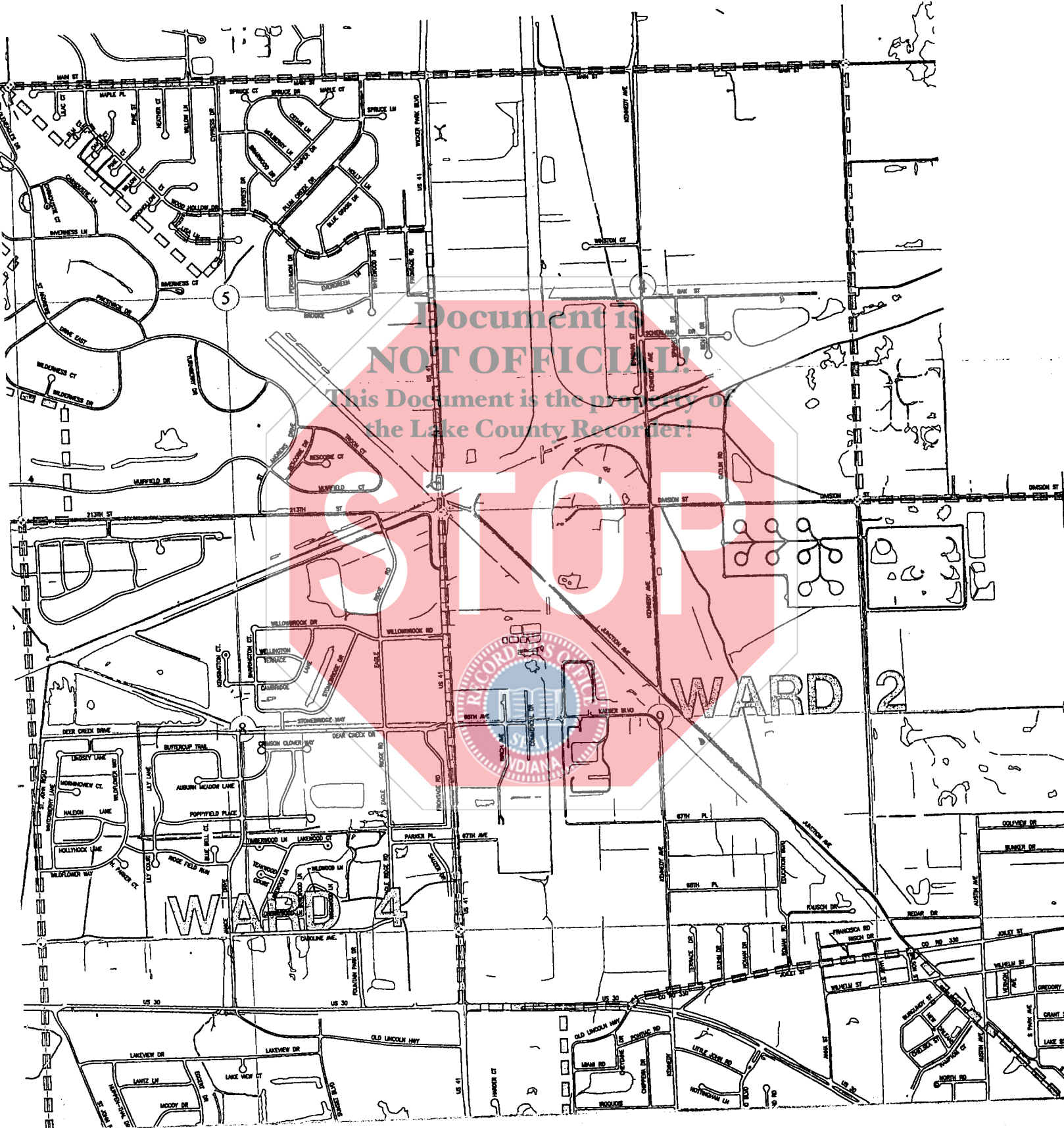

Document is  
 NOT OFFICIAL!  
 This Document is the property of  
 the Lake County Recorder!

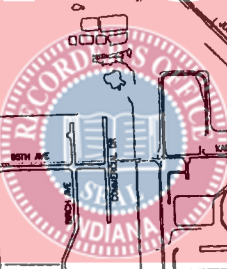
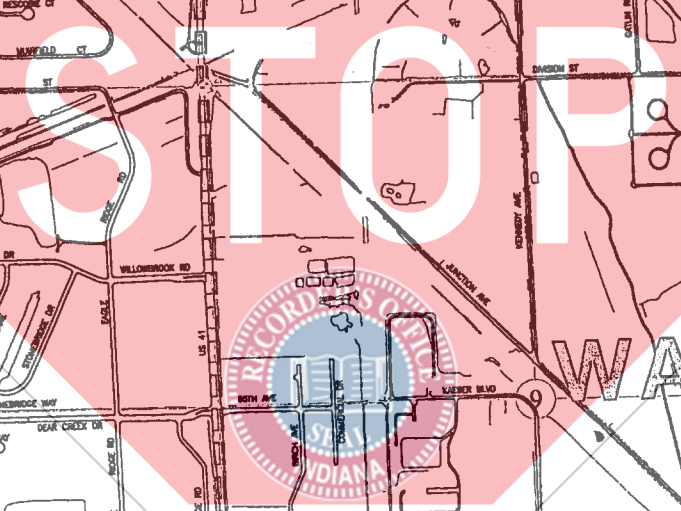

WARD 2

WARD 4



CITY MAP

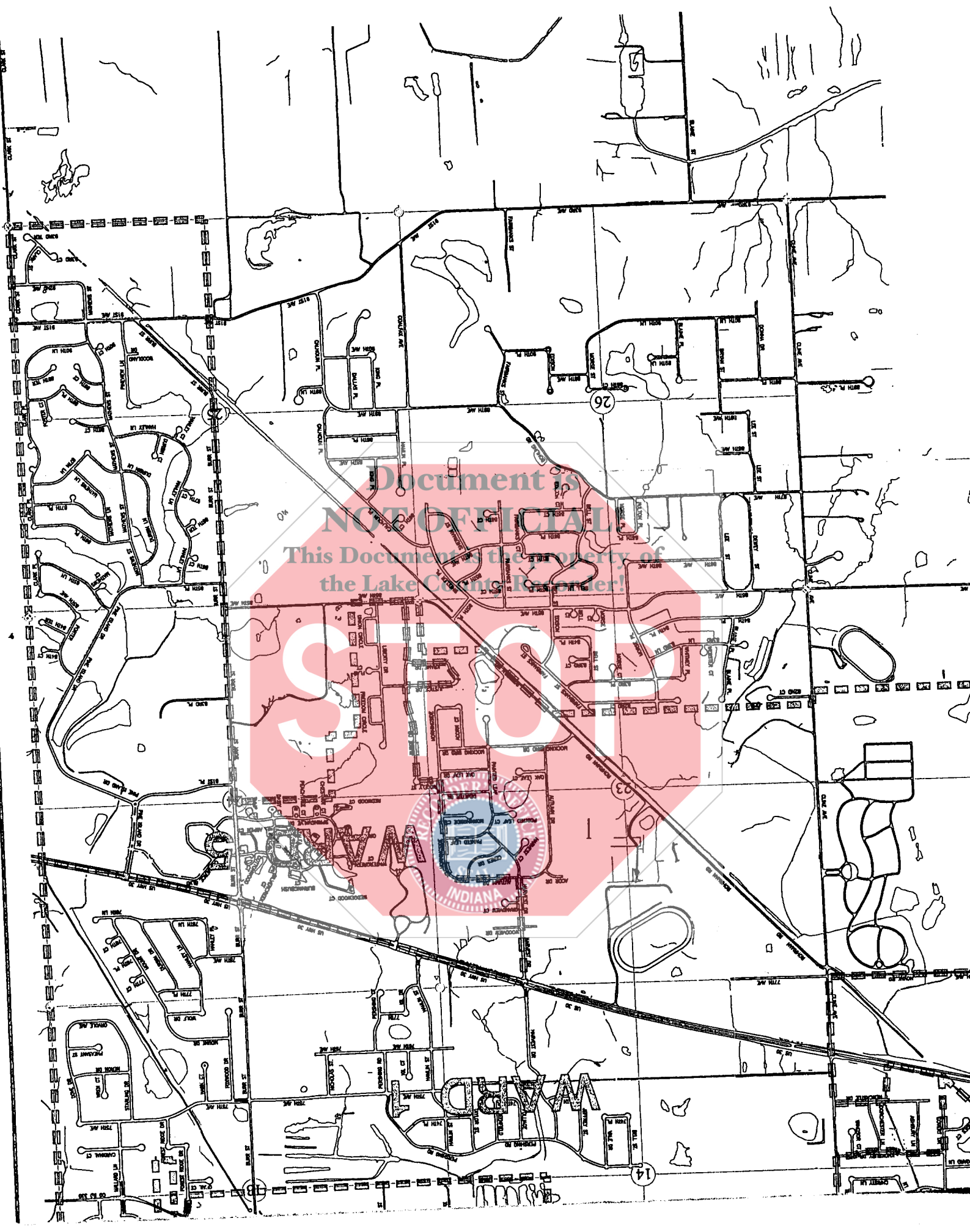

Document is  
 NOT OFFICIAL  
 This Document is the property of  
 the Lake County Recorder

S R

WESTFIELD  
 INDIANA

26

33

14