



TICOR TITLE INSURANCE

Return To: JAMES L. MAVES
5065 Highway 34 Wheatland, WY 82201

WARRANTY

This Indenture Witnesseth

That Elinor A. Maves
of Lake County, and State of Indiana

CONVEY AND WARRANT

To James L. Maves
of Platte County, in the State of Wyoming
for the sum of ten (\$10.00) and other valuable consideration Dollars
the following described REAL ESTATE in Lake County, in the
State of Indiana, to-wit:

The North 50 feet of Lot 3 and the South 50 feet of Lot 4,
Block 11, Jake Kramer, Jr. Addition to Hobart, Indiana, as
shown in Plat Book 11, page 22, in Lake County, Indiana.

commonly known as 1215 Lincoln St. Hobart, IN

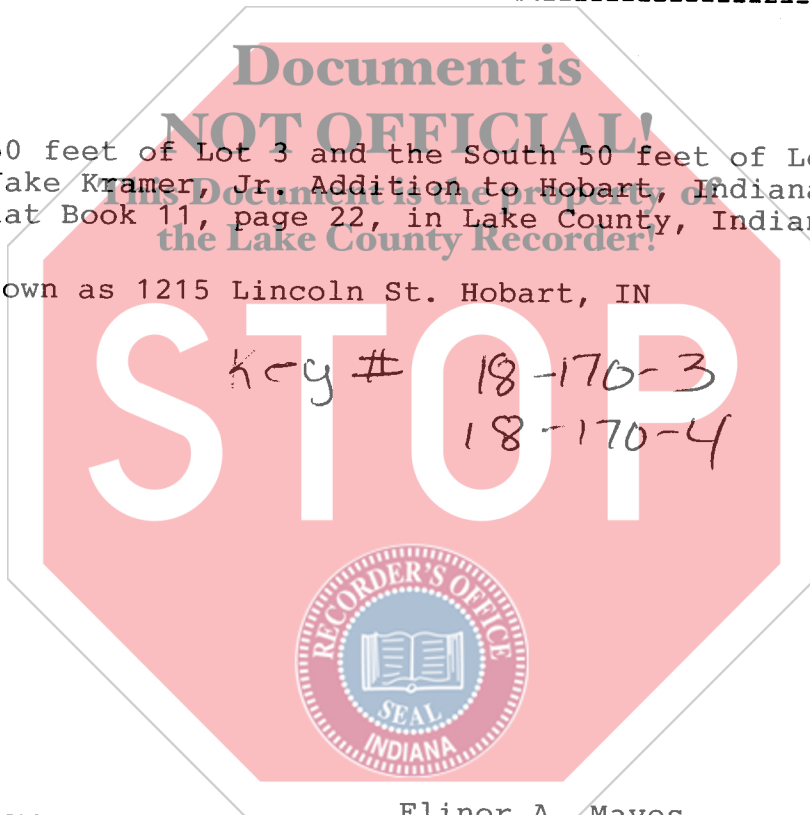

Key # 18-170-3
18-170-4

2002 102983

2002 NOV 12 AM 11:24

STATE OF INDIANA
LAKE COUNTY
FILED
RECORDED
REORDERER
MUNICIPAL CLERK

IN WITNESS WHEREOF, The said Elinor A. Maves

Has hereunto set her Hand and seal this 11th Nov. 2002
Elinor A. Maves (SEAL)

STATE OF INDIANA, Porter County, ss: PETER BENJAMIN LAKE COUNTY AUDITOR (SEAL)

Before me, the undersigned, a Notary Public in and for said County and State, personally appeared the within named Elinor A. Maves

who acknowledged the execution of the foregoing Deed to be her voluntary act and deed.
WITNESS, my hand and Seal this 11th day of November 2002

My commission expires June 30 2008
Geraldine M. Ezell Notary Public
County of Residence Porter Geraldine M. Ezell

Mail Tax Statements to James L. Maves 5065 Highway 34 Wheatland, Wyoming 82201 15.00 RP

This instrument prepared by Jerome L. Ezell Attorney at Law 7992-64
Elinor A. Mave, 1133 Lincoln St, Hobart, In, 46342 000000 cash