

6

The United States of America

002 102890

2002 NOV 12 AM 10: 25

TELETYPE UNIT
RECORDER



STATE OF INDIANA, COUNTY OF LAKE, ss:

I, the undersigned, Clerk of the Lake _____ CIRCUIT _____ Court
of Lake County, and the keeper of the records and files thereof, in the State aforesaid, do
hereby certify that the warrant number 2893812 entitled
State of Indiana vs ME' LANGE & PATRICIA E. GARD
_____,
recorded in Judgment book 97 page 7, was fully
paid and satisfied of recorded on 12-16-98,
as the same appears of record in my office as such Clerk.

IN WITNESS WHEREOF, I have hereunto set my hand and affixed the seal of said
Court, at my office in Crown Point, Indiana in
the said County, this 8TH day of NOVEMBER,
A.D., 2002.

Anna N. Antow

Clerk Lake _____ CIRCUIT _____ Court.

By *Michelle Thomas*
Deputy

20-11-12

HOLD FOR FIRST AMERICAN TITLE

257103

**COUNTY TREASURER'S RECEIPT FOR
PERSONAL PROPERTY TAX JUDGMENT**

Judgment Record No. cp12 2001 Pay 2002 Page 1 Duplicate No. (Col. D, Form 74T) 20961160
 Amount of Taxes, Penalties and Costs (Col. F, Form 74T) For Tax Year 2000 Pay 2001

Taxes
 Penalties 0.00
 Costs 25.00
 Total Taxes, Penalties and Costs 10.00

Interest from 09/03/2002 (Date Certified to Clerk of Circuit Court) to 11/08/2002
 Amount Certified Prior to 9-3-71 @ 6% Paid 35.00 Effective 11/08/2002
 Amount Certified 9-3-71 to 12-31-81 @ 8% Friday, Nov 8 2002 11:03:12 AM
 Amount Certified 1-1-82 to 6-30-88 @ 12% 20-961160
 Amount Certified 7-1-88 to 12-31-1993 @ 10% KathleenII-11082002-103-5
 Amount Certified 1-1-94 to present 35.00 @ 8% Paid 8.75 Effective 11/08/2002
 Total Interest 8.75 Friday, Nov 8 2002 11:03:57 AM
 Additional costs 0.00 20-961160
 KathleenII-11082002-103-6
 Total Taxes, Penalties, Costs, Interest and Additional costs 43.75

Payment Type and Amount

Cash Amount	Check/Draft Amount	MO Amount	Credit Card Bank Card	EFT Amount	Other
-------------	--------------------	-----------	-----------------------	------------	-------

Name and Address of Judgment Debtor: Me'Lange
 1529 Demeter Dr
 Crown Point IN 46307
 Recharged to Property No. 20-961160
 Recharged to Current Tax Duplicate No. 33164

THIS IS A VALID RECEIPT WHEN STAMPED PAID OR RECEIPTED BY THE COUNTY TREASURER



ZD

**COUNTY TREASURER'S RECEIPT FOR
PERSONAL PROPERTY TAX JUDGMENT**

Judgment Record No. cp10 2001 Pay 2002 Page p29 Duplicate No. (Col. D, Form 74T) 20961160
 Amount of Taxes, Penalties and Costs (Col. F, Form 74T) For Tax Year 1997 Pay 1998

Taxes 0.00
 Penalties 25.00
 Costs 5.00
 Total Taxes, Penalties and Costs 30.00

Interest from 11/10/1999 (Date Certified to Clerk of Circuit Court) to 11/08/2002
 Amount Certified Prior to 9-3-71 @ 6%
 Amount Certified 9-3-71 to 12-31-81 @ 8%
 Amount Certified 1-1-82 to 6-30-88 @ 12%
 Amount Certified 7-1-88 to 12-31-1993 @ 10%
 Amount Certified 1-1-94 to present 30.00 @ 8%

Paid 30.00 Effective 11/08/2002
 Friday, Nov 8 2002 10:59:44 AM
 20-961160
 KathleenII-11082002-103-1
 Paid 7.50 Effective 11/08/2002
 Friday, Nov 8 2002 11:01:09 AM
 20-961160
 KathleenII-11082002-103-2

Total Interest 0.00
 Additional costs 7.50 *295*

Total Taxes, Penalties, Costs, Interest and Additional costs 37.50

Payment Type and Amount

Cash Amount	Check/Draft Amount	MO Amount	Credit Card Bank Card	EFT Amount	Other
-------------	--------------------	-----------	-----------------------	------------	-------

Name and Address of Judgment Debtor: Me'Lange
 1529 Demeter Dr
 Crown Point IN 46307

Recharged to Property No. 20-961160
 Recharged to Current Tax Duplicate No. 33164

THIS IS A VALID RECEIPT WHEN STAMPED PAID OR RECEIPTED BY THE COUNTY TREASURER

Lake County
 20-Schererville

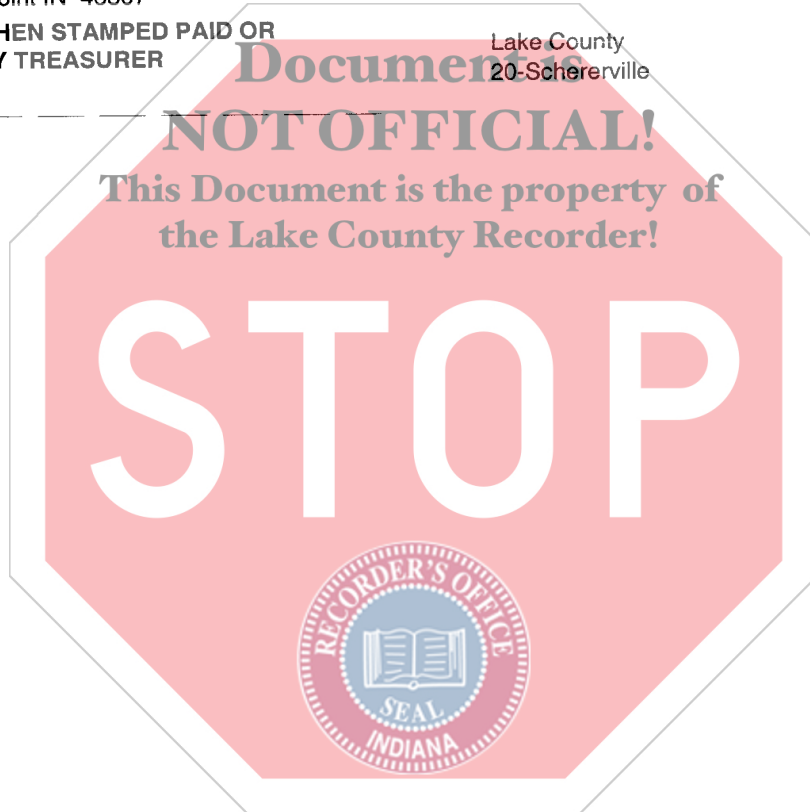

TAXPAYER COPY		DUPLICATE NUMBER		SEE TAX BILL INSTRUCTIONS & IMPORTANT CREDIT INFORMATION ON REVERSE SIDE					B SECOND INSTALLMENT (FALL)			
11/8/02 10:49:35AM 2001 PAYABLE 2002 MAKE ALL CHECKS PAYABLE TO LAKE COUNTY TREASURER 2293 N MAIN ST CROWN POINT IN 46307		33164		PERSONAL PROPERTY TAX STATEMENT APPROVED BY THE STATE BOARD OF ACCOUNTS FOR LAKE COUNTY COUNTY 2001*  +00045200102516035332					TAX RATE 5.14040			
		PARCEL NUMBER 20-961160							HOMESTEAD CREDIT 10.00000			
		TAXING UNIT NAME Schererville							REPLACEMENT CREDIT 13.82230			
	GROSS VALUE	EXEMPT/DED	TAXABLE VALUE	GROSS TAX	HOMESTEAD SPTRC	NET TAX	OTHER TAX, FEES & PENALTIES	DELINQUENT TAX	DELINQUENT PENALTY	TOTAL		
R	0	0	0	0.00	0.00	19.93			0.00	19.93		
N	900	0	900	23.13	3.20							
SPECIAL ASSESSMENTS												
DEDUCTIONS BREAKDOWN		Me'Lange Patricia E. Gard 1529 Demeter Dr Crown Point IN 46307				CURRENT TAX BREAKDOWN		DESCRIPTION	NET TAX EACH INSTALLMENT	DELINQUENT TAX OR PENALTY	Pre-Paid	TOTAL
						CoGen 3.26						
		Park 0.25										
		State 0.01										
		Welfare 3.26										
		County 0.78										
		Twp-SJ2 0.19										
		Corp-SC 3.38										
		Sch-LC 8.01										
		Lib-LC 0.69										
		Spe-SC 0.10										
		TOTAL 19.93										
LEGAL DESCRIPTION		MAP NUMBER				DUE DATE		TOTAL DUE		19.93		
PERSONAL PROPERTY		03				11/12/2002						
DEEDED OWNER		Patricia E. Gard				ACRES						



TAXPAYER COPY
 11/8/02 10:48:35AM
 2001 PAYABLE 2002
 MAKE ALL CHECKS PAYABLE TO
 LAKE COUNTY TREASURER
 2293 N MAIN ST
 CROWN POINT IN 46307

DUPLICATE NUMBER: 33164
 PARCEL NUMBER: 20-961160
 TAXING UNIT NAME: Schererville

SEE TAX BILL INSTRUCTIONS & IMPORTANT CREDIT INFORMATION ON REVERSE SIDE
PERSONAL PROPERTY TAX STATEMENT
 APPROVED BY THE STATE BOARD OF ACCOUNTS FOR LAKE COUNTY COUNTY 2001*

+00045200102516035331

A FIRST INSTALLMENT (SPRING)

TAX RATE	5.14040
HOMESTEAD CREDIT	10.00000
REPLACEMENT CREDIT	13.82230
TOTAL	205.17

	GROSS VALUE	EXEMPT/DED	TAXABLE VALUE	GROSS TAX	HOMESTEAD SPTRC	NET TAX	OTHER TAX, FEES & PENALTIES	DELINQUENT TAX	DELINQUENT PENALTY	
R	0	0	0	0.00	0.00	19.93	183.25	0.00	1.99	0.00
N	900	0	900	23.13	3.20					

DEDUCTIONS BREAKDOWN

Me'Lange
 Patricia E. Gard
 1529 Demeter Dr
 Crown Point IN 46307

CURRENT TAX BREAKDOWN

CoGen	3.26
Park	0.25
State	0.01
Welfare	3.26
County	0.78
Two-SJ2	0.19
Corp-SC	3.38
Sch-LC	8.01
Lib-LC	0.69
Spe-SC	0.10
TOTAL	19.93

SPECIAL ASSESSMENTS

DESCRIPTION	NET TAX EACH INSTALLMENT	DELINQUENT TAX OR PENALTY	Pre-Paid	TOTAL

LEGAL DESCRIPTION
 PERSONAL PROPERTY

DEEDED OWNER Patricia E. Gard

MAP NUMBER 03

ACRES

DUE DATE 05/10/2002

TOTAL DUE 205.17

ADD 10% PENALTY AFTER DUE DATE
 If less than \$25, then all due in 1st installment

C copy - Adjusted Bill
 46.72

