

2

2002 NOV 12 AM 10:20  
LAKE COUNTY  
FILED

2002 102832

2002 NOV 12 AM 10:20

MORRIS W. CARTER  
RECORDER

After Recording Return To:  
COUNTRYWIDE HOME LOANS, INC.  
MS SV-79 DOCUMENT PROCESSING  
1800 Tapo Canyon  
Simi Valley, CA 93063-6712

[Space Above This Line For Recording Data]

IN1516946478703  
[Case #]

2285LK02  
[Escrow/Closing #]

0002162498654209  
[Doc ID #]

### ASSIGNMENT OF MORTGAGE

KNOW ALL MEN BY THESE PRESENTS That  
COUNTRYWIDE HOME LOANS, INC.  
4500 Park Granada, Calabasas, CA 91302-1613  
organized and existing under the laws of NEW YORK, party of the first part, for  
value received, has granted, bargained, sold, assigned, transferred and set over, and by these presents does  
grant, sell, assign, transfer and set over unto

THE LEADER MORTGAGE COMPANY

organized and existing under the laws of OHIO, whose location and mailing  
address (if different) is

1015 EUCLID AVENUE, CLEVELAND, OH, 44115

party of the second part, its successors and assigns, a certain indenture of mortgage dated  
NOVEMBER 05, 2002, made by  
WILLIAM J BRADFORD, SOLE

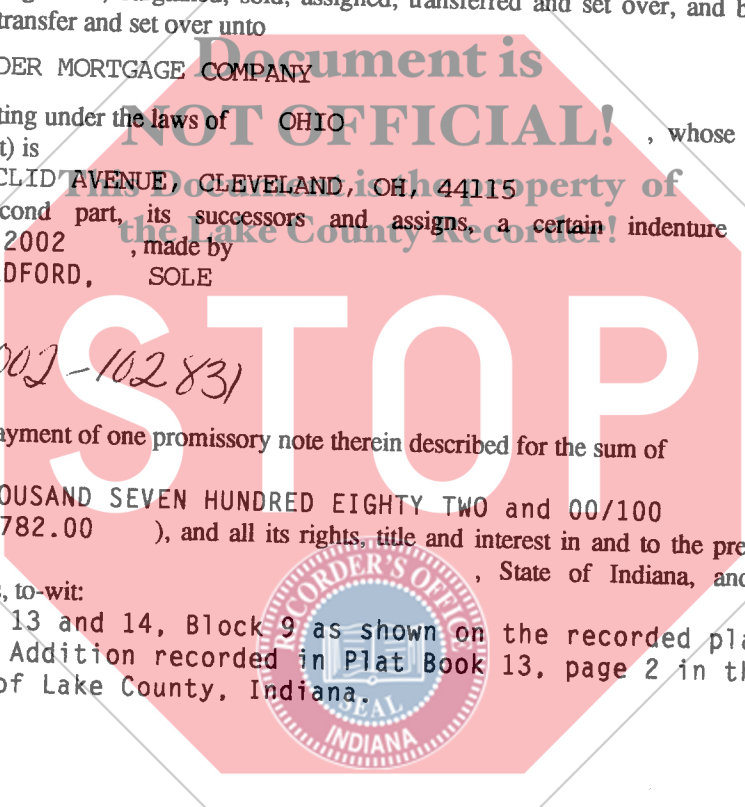

mtz # 2002-102831

to it, securing the payment of one promissory note therein described for the sum of

EIGHTY SIX THOUSAND SEVEN HUNDRED EIGHTY TWO and 00/100  
Dollars (\$ 86,782.00 ), and all its rights, title and interest in and to the premises situated in the  
county of LAKE, State of Indiana, and described in said  
mortgage as follows, to-wit:

Lots Numbered 13 and 14, Block 9 as shown on the recorded plat of F.D.  
Barnes Second Addition recorded in Plat Book 13, page 2 in the Office of  
the Recorder of Lake County, Indiana.

Indiana Assignment of Mortgage

Page 1 of 2

VMP-995(IN) (0001).01 CHL (12/00)

VMP MORTGAGE FORMS - (800)521-7291

Initials: *ML*

1/00



HOLD FOR MERIDIAN TITLE CORP.

12.00  
XP  
MT

CASE #: IN1516946478703

DOC ID # 0002162498654209

which said mortgage is recorded in the office of the Recorder of

County, in the State of Indiana, in Book No.

LAKE

together with the said note therein described

at Page

as Document No.

and the money due or to grow due thereon, with the interest:

TO HAVE AND TO HOLD the same unto the said party of the second part, its successors and assigns, forever, subject only to the provisions in the said indenture of mortgage contained.

IN WITNESS WHEREOF, the party of the first part has caused this instrument to be executed in its name

by MICHAEL LUGAR  
its BRANCH MANAGER

, and attested by VALERIE NEFF

ASSISTANT BRANCH MANAGER  
FIFTH day of NOVEMBER, A.D. 2002.  
ATTEST:

, its  
and its corporate seal to be hereunto affixed this

COUNTRYWIDE HOME LOANS, INC.

Document is

NOT OFFICIAL

*Michael Lugar*  
MICHAEL LUGAR, BRANCH MANAGER

By: *Valerie Neff*  
VALERIE NEFF, ASSISTANT BRANCH MANAGER

STATE OF INDIANA  
COUNTY OF LAKE

This Document is the property of  
the Lake County Recorder!

On *11/5/02*, before me *A Notary Michael Lugar*, personally appeared

, personally known to me (or proved to me on the basis of satisfactory evidence) to be the person(s) whose name(s) is/are subscribed to the within instrument and acknowledged to me that he/she/they executed the same in his/her/their authorized capacity(ies), and that by his/her/their signature(s) on the instrument the person(s), or the entity upon behalf of which the person(s) acted, executed the instrument.

WITH THIS MY HAND AND OFFICIAL SEAL.  
CHERYL CUMMINGS  
Notary Public  
SEAL  
State of Indiana  
My Commission Expires March 22, 2008



*Cheryl Cummings* (Seal)

This form was Prepared By: J. BELICEK  
COUNTRYWIDE HOME LOANS, INC.  
address:  
1525 US HIGHWAY 41 SUITE C-26, SCHERERVILLE, IN 46375-  
tel. no.: (219)322-2802