

2

2002 100232

STATE OF INDIANA
LAKE COUNTY
FILED FOR RECORD
2002 NOV -4 PM 2: 01
MORRIS W. CARTER
RECORDER

QUITCLAIM DEED

THIS QUITCLAIM DEED, Executed this 1st day of November ,
2002 (year),

by first party, Grantor, Wade M. Weber
whose post office address is 1338 S. Wabash St., Hobart, In 46342
to second party, Grantee, Wade M. Weber and Donna J. Weber (Husband & Wife)
whose post office address is 1338 S. Wabash St., Hobart, In 46342

WITNESSETH, That the said first party, for good consideration and for the sum of
ten Dollars (\$10.00) paid by the said second party, the receipt whereof
is hereby acknowledged, does hereby remise, release and quitclaim unto the said second party
forever, all the right, title, interest and claim which the said first party has in and to the following
described parcel of land, and improvements and appurtenances thereto in the County of
Lake , State of Indiana to wit:
Lake estates Subdivision, Lot 10, Block 5, in the City of Gary, Lake County, Indiana

Commonly known as 1133 Greene Place, Gary, Indiana
Key No. 25-45-0455-0010

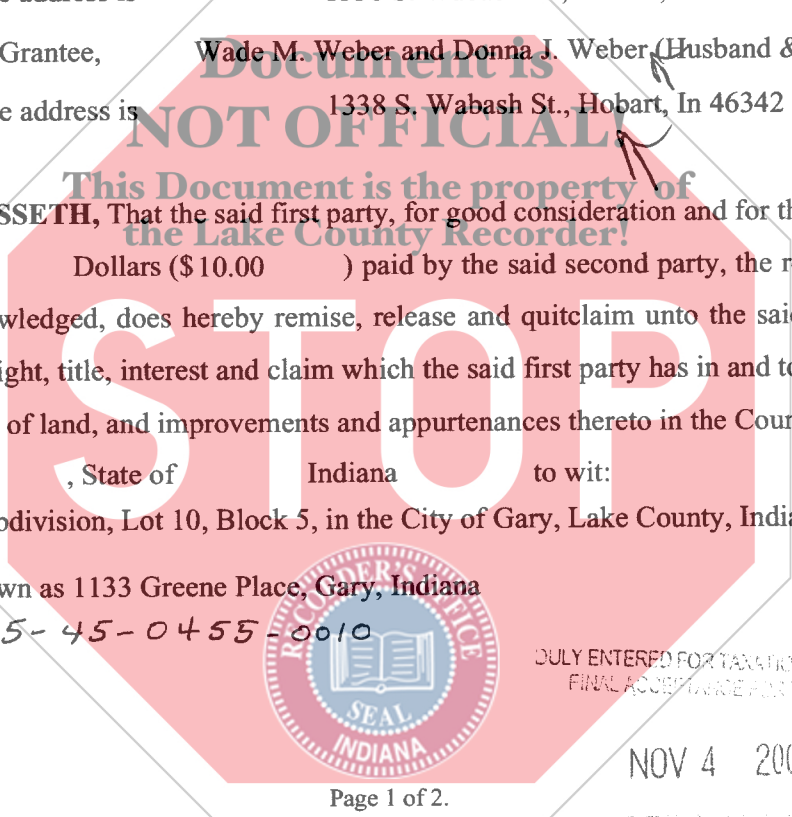

Page 1 of 2.

[Signatures on following page.]

NOV 4 2002
PETER BERGMAN
LAKE COUNTY Recorder
Initials of First Party

AHAAZZAB

00024:
16.00
257
CK# 5048

IN WITNESS WHEREOF, The said first party has signed and sealed these presents the day and year first above written. Signed, sealed and delivered in presence of:

Carol Luken

Signature of Witness

CAROL LUKEN

Print name of Witness

x Wade M Weber

Signature of First Party, Grantor

WADE M. WEBER

Print name of First Party

Signature of Witness

Signature of First Party, Grantor

Print name of Witness

Print name of First Party

STATE OF Indiana }
COUNTY OF Lake }

On Nov. 1, 2002 before me,
appeared Wade m. Weber

personally known to me (or proved to me on the basis of satisfactory evidence) to be the person(s) whose name(s) is/are subscribed to the within instrument and acknowledged to me that he/she/they executed the same in his/her/their authorized capacity(ies), and that by his/her/their signature(s) on the instrument the person(s), or the entity upon behalf of which the person(s) acted, executed the instrument.

WITNESS my hand and official seal.

Betty Hendley
Signature of Notary

(Seal)

Affiant Known _____ Produced ID
Type of ID _____

x Wade M Weber
Signature of Preparer

WADE M. WEBER
Print Name of Preparer

1338 S. WABASH ST., NOBART, IN
Address of Preparer



Page 2 of 2.

WMW
Initials of First Party

AHAAZZAB