

2

2002 100230

STATE OF INDIANA
LAKE COUNTY
FILED FOR RECORD

2002 NOV -4 PM 2: 01

MORRIS W. CARTER
RECORDER

QUITCLAIM DEED

THIS QUITCLAIM DEED, Executed this 1st day of November ,

2002 (year),

by first party, Grantor,

Wade M. Weber

whose post office address is

1338 S. Wabash St., Hobart, IN 46342

to second party, Grantee,

Wade M. Weber and Donna J. Weber (Husband & Wife)

whose post office address is

1338 S. Wabash St., Hobart, IN 46342

WITNESSETH, That the said first party, for good consideration and for the sum of

ten Dollars (\$10.00) paid by the said second party, the receipt whereof

is hereby acknowledged, does hereby remise, release and quitclaim unto the said second party forever, all the right, title, interest and claim which the said first party has in and to the following described parcel of land, and improvements and appurtenances thereto in the County of

Lake , State of Indiana to wit:

Lot 4 in aetna Manor sixth Subdivision, in the City of Gary, as shown in Plat book 31, page 49, Lake County, Indiana

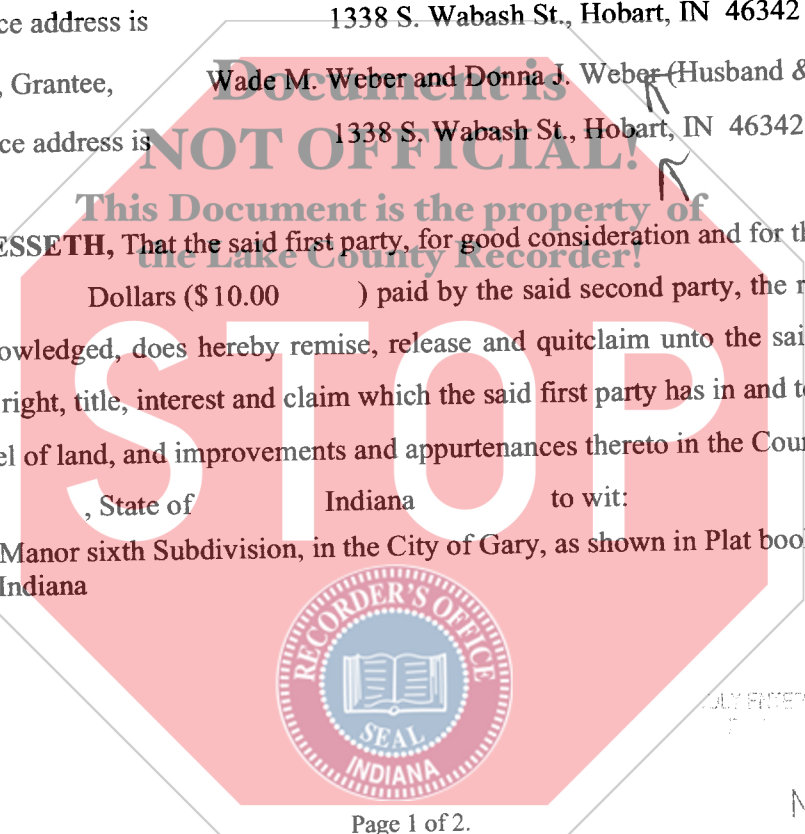

Page 1 of 2.

[Signatures on following page.]

AHAAZZAB

FILED FOR RECORD NOV 4 2002

NOV 4 2002

Initials of First Party

LAKE COUNTY INDIANA

00024.

Handwritten notes: 16.00 X/M CK# 3048

IN WITNESS WHEREOF, The said first party has signed and sealed these presents the day and year first above written. Signed, sealed and delivered in presence of:

Carol Luken
Signature of Witness

CAROL LUKEN
Print name of Witness

Signature of Witness

Print name of Witness

x Wade M Weber
Signature of First Party, Grantor

WADE M. WEBER
Print name of First Party

Signature of First Party, Grantor

Print name of First Party

STATE OF Indiana }
COUNTY OF Lake
On Nov 1, 2002 before me,
appeared Wade M. Weber

personally known to me (or proved to me on the basis of satisfactory evidence) to be the person(s) whose name(s) is/are subscribed to the within instrument and acknowledged to me that he/she/they executed the same in his/her/their authorized capacity(ies), and that by his/her/their signature(s) on the instrument the person(s), or the entity upon behalf of which the person(s) acted, executed the instrument.

WITNESS my hand and official seal.

Betty J Henley
Signature of Notary

(Seal)

Affiant Known _____ Produced ID
Type of ID _____

x Wade M Weber
Signature of Preparer

WADE M. WEBER
Print Name of Preparer

1338 S Wabash St. Hobart, IN
Address of Preparer



Page 2 of 2.

W/MW
Initials of First Party