

2

2002 100223

STATE OF INDIANA  
LAKE COUNTY  
FILED FOR RECORD

2002 NOV -4 PM 2: 00

MORRIS W. CARTER  
RECORDER

**QUITCLAIM DEED**

**THIS QUITCLAIM DEED**, Executed this 1st day of November , 2002 (year),

by first party, Grantor, Wade M. Weber  
whose post office address is 1338 S. Wabash St., Hobart, In 46342  
to second party, Grantee, Wade M. Weber and Donna J. Weber (Husband & Wife)  
whose post office address is 1338 S. Wabash St., Hobart, In 46342

**WITNESSETH**, That the said first party, for good consideration and for the sum of ten Dollars (\$10.00 ) paid by the said second party, the receipt whereof is hereby acknowledged, does hereby remise, release and quitclaim unto the said second party forever, all the right, title, interest and claim which the said first party has in and to the following described parcel of land, and improvements and appurtenances thereto in the County of

Lake , State of Indiana to wit:  
Lot Numbered 15, Block 1 as shown on the recorded plat of Aetna Manor Second Subdivision recorded in Plat Book 28 page 39 in the office of the recorder of Lake County, Indiana

Key No. 41-0265-0015

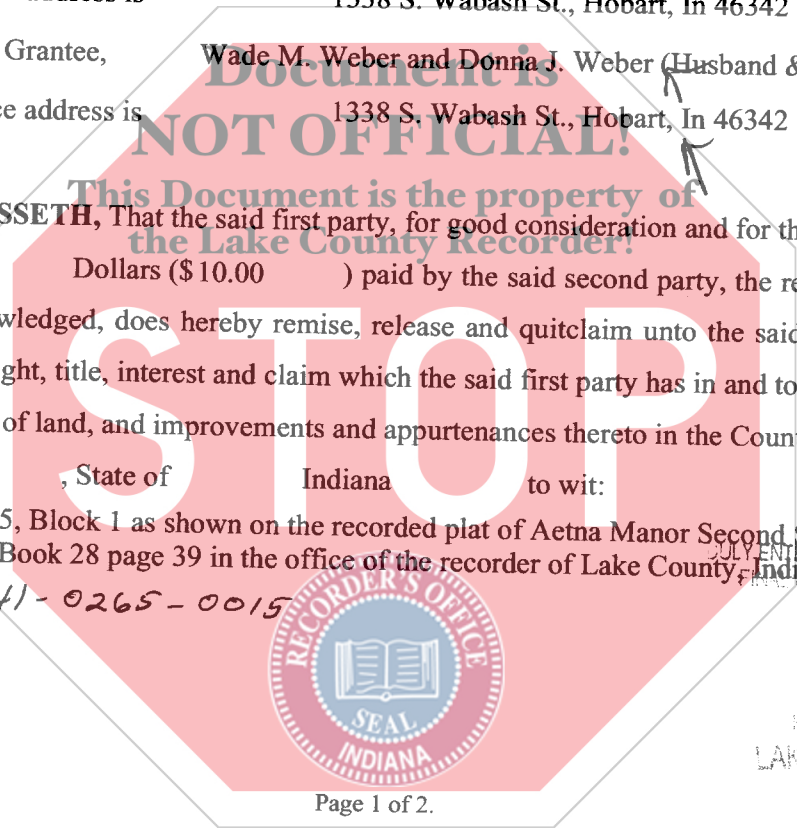

NOV 4 2002

LAKE COUNTY AUDITOR

*MMW*  
Initials of First Party

[Signatures on following page.]

AHAAZZAB

234 1600  
C# 5048

IN WITNESS WHEREOF, The said first party has signed and sealed these presents the day and year first above written. Signed, sealed and delivered in presence of:

Carol Luken  
Signature of Witness

CAROL LUKEN  
Print name of Witness

\_\_\_\_\_  
Signature of Witness

\_\_\_\_\_  
Print name of Witness

x Wade M Weber  
Signature of First Party, Grantor

WADE M. WEBER  
Print name of First Party

\_\_\_\_\_  
Signature of First Party, Grantor

\_\_\_\_\_  
Print name of First Party

STATE OF Indiana }  
COUNTY OF Lake }  
On Nov. 1, 2002 before me,  
appeared Wade m. Weber

personally known to me (or proved to me on the basis of satisfactory evidence) to be the person(s) whose name(s) is/are subscribed to the within instrument and acknowledged to me that he/she/they executed the same in his/her/their authorized capacity(ies), and that by his/her/their signature(s) on the instrument the person(s), or the entity upon behalf of which the person(s) acted, executed the instrument.

WITNESS my hand and official seal.

Beth Henley  
Signature of Notary

(Seal)

Affiant  Known  Produced ID  
Type of ID \_\_\_\_\_

x Wade M Weber  
Signature of Preparer

WADE M. WEBER  
Print Name of Preparer

1338 S. Wabash St., Hobart, IN  
Address of Preparer



WMW  
Initials of First Party