

2

Chicago Title Insurance Company

STATE OF INDIANA  
LAKE COUNTY  
FILED FOR RECORD

2002 099410

2002 NOV 1 AM 9:48

MORRIS W. CARTER  
RECORDER

3 3

After Recording Return To:  
COUNTRYWIDE HOME LOANS, INC.  
MS SV-79 DOCUMENT PROCESSING  
1800 Tapo Canyon  
Simi Valley, CA 93063-6712

620027522

[Space Above This Line For Recording Data]

IN1516866103703  
[Case #]

620027522  
[Escrow/Closing #]

0002042859754079  
[Doc ID #]

### ASSIGNMENT OF MORTGAGE

KNOW ALL MEN BY THESE PRESENTS That  
COUNTRYWIDE HOME LOANS, INC.  
4500 Park Granada, Calabasas, CA 91302-1613  
organized and existing under the laws of NEW YORK

, party of the first part, for

value received, has granted, bargained, sold, assigned, transferred and set over, and by these presents does grant, sell, assign, transfer and set over unto

THE LEADER MORTGAGE COMPANY

organized and existing under the laws of  
address (if different) is

1015 EUCLID AVENUE  
CLEVELAND, OH 44115  
OHIO

, whose location and mailing

party of the second part, its successors and assigns, a certain indenture of mortgage dated  
OCTOBER 29, 2002, made by  
SANDRA A KOLBERT,

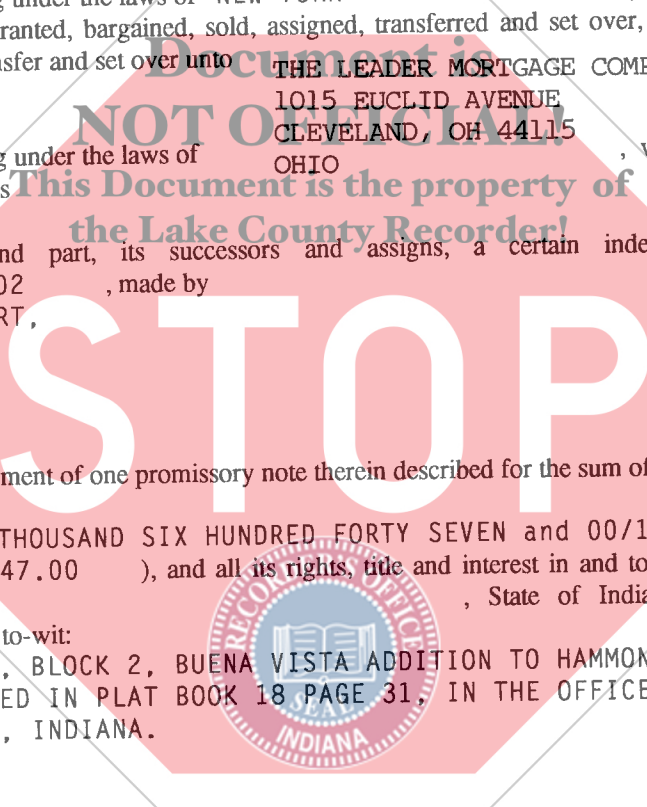

to it, securing the payment of one promissory note therein described for the sum of

SEVENTY SEVEN THOUSAND SIX HUNDRED FORTY SEVEN and 00/100  
Dollars (\$ 77,647.00 ), and all its rights, title and interest in and to the premises situated in the  
county of LAKE

, State of Indiana, and described in said

mortgage as follows, to-wit:

LOTS 11 AND 12, BLOCK 2, BUENA VISTA ADDITION TO HAMMOND, AS PER PLAT  
THEREOF RECORDED IN PLAT BOOK 18 PAGE 31, IN THE OFFICE OF THE RECORDER  
OF LAKE COUNTY, INDIANA.

2002-099410

Indiana Assignment of Mortgage

Page 1 of 2

1/00

VMP-995(IN) (0001).01 CHL (12/00)

VMP MORTGAGE FORMS - (800)521-7291

Initials:   



12  
M  
H  
21

CASE #: IN1516866103703

DOC ID # 0002042859754079

which said mortgage is recorded in the office of the Recorder of

LAKE

County, in the State of Indiana, in Book No.

at Page

as Document No.

together with the said note therein described

and the money due or to grow due thereon, with the interest:

TO HAVE AND TO HOLD the same unto the said party of the second part, its successors and assigns, forever, subject only to the provisions in the said indenture of mortgage contained.

IN WITNESS WHEREOF, the party of the first part has caused this instrument to be executed in its name by DIANE SWEENEY its ASST VICE PRESIDENT

, and attested by VALERIE M NEFF ASST BRANCH MANAGER, its and its corporate seal to be hereunto affixed this

TWENTY-NINTH day of OCTOBER, A.D. 2002.

ATTEST:

COUNTRYWIDE HOME LOANS, INC.

*Diane Sweeney*  
DIANE SWEENEY/ASST VICE PRESIDENT  
STATE OF INDIANA  
COUNTY OF LAKE

By: *Valerie M Neff*  
VALERIE M NEFF/ASST BRANCH MANAGER

Document is NOT OFFICIAL!  
This Document is the property of the Lake County Recorder!

On *10/29/02*, before me *a notary Diane Sweeney*, personally appeared

, personally known to me (or proved to me on the basis of satisfactory evidence) to be the person(s) whose name(s) is/are subscribed to the within instrument and acknowledged to me that he/she/they executed the same in his/her/their authorized capacity(ies), and that by his/her/their signature(s) on the instrument the person(s), or the entity upon behalf of which the person(s) acted, executed the instrument.

WITNESS my hand and official seal.  
CHERYL CUMMINGS  
Notary Public  
SEAL  
State of Indiana  
My Commission Expires March 22, 2008



*Cheryl Cummings* (Seal)

This form was Prepared By: V. NEFF  
COUNTRYWIDE HOME LOANS, INC.

address:

1525 US HIGHWAY 41 SUITE C-26, SCHERERVILLE, IN 46375-

tel. no.: (219)322-2802