

2002 092197

2002 OCT 11 1:26

RECORDED

QUITCLAIM DEED

THIS QUITCLAIM DEED, executed this 11th day of October 2002

F.M
2m.

by first party, Grantor, ~~Shirley~~ Fletcher MANGUM
whose post office address is 9846 SO. King DR. 60628
Chicago, IL

to second party, Grantee, MARY JORDAN
whose post office address is 318 ELLSWORTH ST, Gary, IN 46404

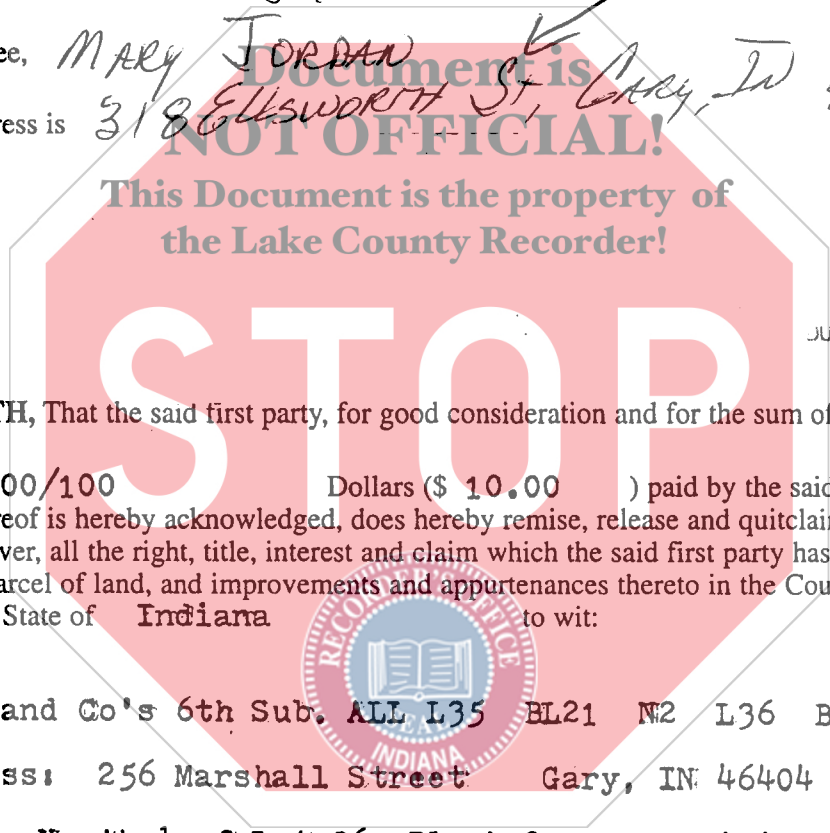

NOT OFFICIAL!
This Document is the property of the Lake County Recorder!

WITNESSETH, That the said first party, for good consideration and for the sum of

OCT 11 2002

Ten and 00/100 Dollars (\$ 10.00) paid by the said second party, the receipt whereof is hereby acknowledged, does hereby remise, release and quitclaim unto the said second party forever, all the right, title, interest and claim which the said first party has in and to the following described parcel of land, and improvements and appurtenances thereto in the County of Lake, State of Indiana to wit:

PETER BENJAMIN
LAKE COUNTY AUDITOR

Resub. Gary Land Co's 6th Sub. ALL L35 BL21 N2 L36 BL21
Mailing Address: 256 Marshall Street Gary, IN 46404 /

Lot 35 and the North 1/2 of Lot 36, Block 21, Resubdivision of Gary Land Company's 6th Subdivision as shown in Plat Book 14, page 21 in Lake County, Indiana.
25-44-0236-0027

000980

16.00
M.V.
CASH

IN WITNESS WHEREOF, The said first party has signed and sealed these presents the day and year first above written. Signed, sealed and delivered in presence of:

Meredith J. Stamps
Signature of Witness
Meredith J. Stamps
Print name of Witness

Signature of Witness

Print name of Witness

Shirley Mangum
Signature of First Party
SHIRLEY MANGUM
Print name of First Party

Fletcher Mangum
Signature of First Party
Fletcher Mangum
Print name of First Party

State of Indiana
County of Spice

On October 11, 2012 before me, Fletcher & Shirley Mangum appeared personally known to me (or proved to me on the basis of satisfactory evidence) to be the person(s) whose name(s) is/are subscribed to the within instrument and acknowledged to me that he/she/they executed the same in his/her/their authorized capacity(ies), and that by his/her/their signature(s) on the instrument the person(s), or the entity upon behalf of which the person(s) acted, executed the instrument. WITNESS my hand and official seal.

Shirley L. Dowd
Signature of Notary
SHIRLONDA L. DOWD
NOTARY PUBLIC STATE OF INDIANA
LAKE COUNTY
MY COMMISSION EXP. AUG. 17, 2008

State of _____
County of _____
On _____
appeared

personally known to me (or proved to me on the basis of satisfactory evidence) to be the person(s) whose name(s) is/are subscribed to the within instrument and acknowledged to me that he/she/they executed the same in his/her/their authorized capacity(ies), and that by his/her/their signature(s) on the instrument the person(s), or the entity upon behalf of which the person(s) acted, executed the instrument. WITNESS my hand and official seal.

Signature of Notary

Affiant _____ Known _____ Produced ID _____
Type of ID _____
(Seal)

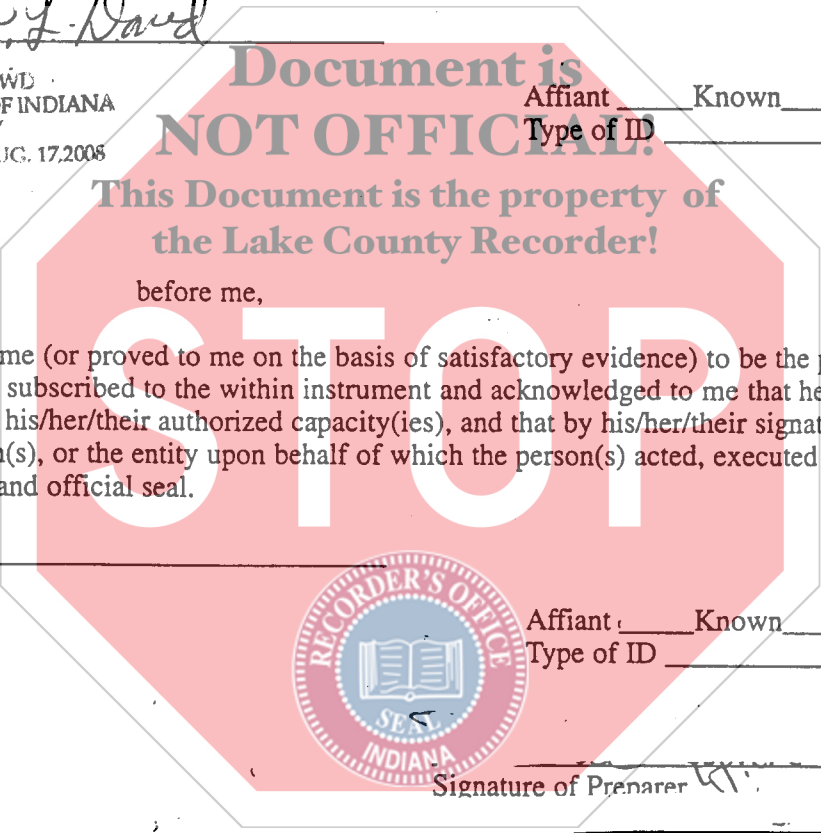

Affiant _____ Known _____ Produced ID _____
Type of ID _____
(Seal)

[Signature]
Signature of Preparer

Print Name of Preparer

Address of Preparer