

S PL

STATE OF INDIANA  
LAKE COUNTY  
FILED FOR RECORD

2002 072359

2002 AUG 13 AM 9:00

MORRIS W. CARTER  
RECORDER

Prescribed by the State Board of Accounts

# TAX TITLE DEED TO COUNTY

Whereas the Lake County Board of Commissioners did the 25th day of June, 2002 produced to the County of Lake, in the State of Indiana, a certificate of sale dated the 27th day of September, 2001, signed by PETER BENJAMIN who, at the date of sale, was Auditor of the County, from which it appears that said County on the 27th day of September, 2001, obtained, pursuant to law, the real property described in this indenture for the sum of EIGHT HUNDRED FOURTY-SEVEN AND 61/100 DOLLARS (\$847.61) being the amount due on the following tracts of land returned delinquent in the name LOWERY, CHARLES E & VERONICA H for 2000 and prior years, namely:

Property ID: 25-46-0148-0047  
Property Address: 2505-07 CONNECTICUT ST, GARY, IN 46407  
LOT 47, EXCEPT THAT PART OFF THE REAR OF SAID LOT TAKEN FOR ALLEY PURPOSES, BLOCK 20, CHICAGO-TOLLESTON LAND AND INVESTMENT COMPANY'S OAK PARK ADDITION TO TOLLESTON, IN THE CITY OF GARY, AS PER PLAT THEREOF, RECORDED IN PLAT BOOK 2, PAGE 35, IN THE OFFICE OF THE RECORDER OF LAKE COUNTY, INDIANA.

Such real property has been recorded in the Office of the Lake County Auditor as delinquent for the nonpayment of taxes and proper notice of the sale has been given. It appearing that Lake County is the owner of the certificate of sale, that the time of redeeming such real property has expired, that the property has not been redeemed, that the Lake County Commissioners have demanded a deed for the real property described in the certificate of sale, that the records of Lake County Auditor's Office state that the real property was legally liable for taxation, and the real property has been duly assessed and properly charged on the duplicate with the taxes and special assessments for 2000 and prior years:

Therefore, this indenture, made this 25th day of June, 2002 between the State of Indiana by Peter Benjamin, Auditor of Lake County, of the first part, and Lake County of the second part, witnesseth; That the party of the first part, for and in consideration of the premises, has granted and bargained and conveyed to the party of the second part, the real property described in the certificate of sale, situated in the County of Lake, and the State of Indiana, namely and more particularly described as follows:

Property ID: 25-46-0148-0047  
Property Address: 2505-07 CONNECTICUT ST, GARY, IN 46407  
LOT 47, EXCEPT THAT PART OFF THE REAR OF SAID LOT TAKEN FOR ALLEY PURPOSES, BLOCK 20, CHICAGO-TOLLESTON LAND AND INVESTMENT COMPANY'S OAK PARK ADDITION TO TOLLESTON, IN THE CITY OF GARY, AS PER PLAT THEREOF, RECORDED IN PLAT BOOK 2, PAGE 35, IN THE OFFICE OF THE RECORDER OF LAKE COUNTY, INDIANA.

to have and to hold such real property, with the appurtenances belonging thereto, in as full and ample a manner as the Auditor of said County is empowered by law to convey the same.

In testimony where of Peter Benjamin, Auditor of Lake County, has hereunto set his hand, and affixed the seal of the Board of County Commissioners, the day and year last above mentioned.

Witness: Peter Benjamin (L.S)  
PETER BENJAMIN, Auditor of Lake County

Peggy Katona  
Attest: PEGGY KATONA  
Treasurer: Lake County

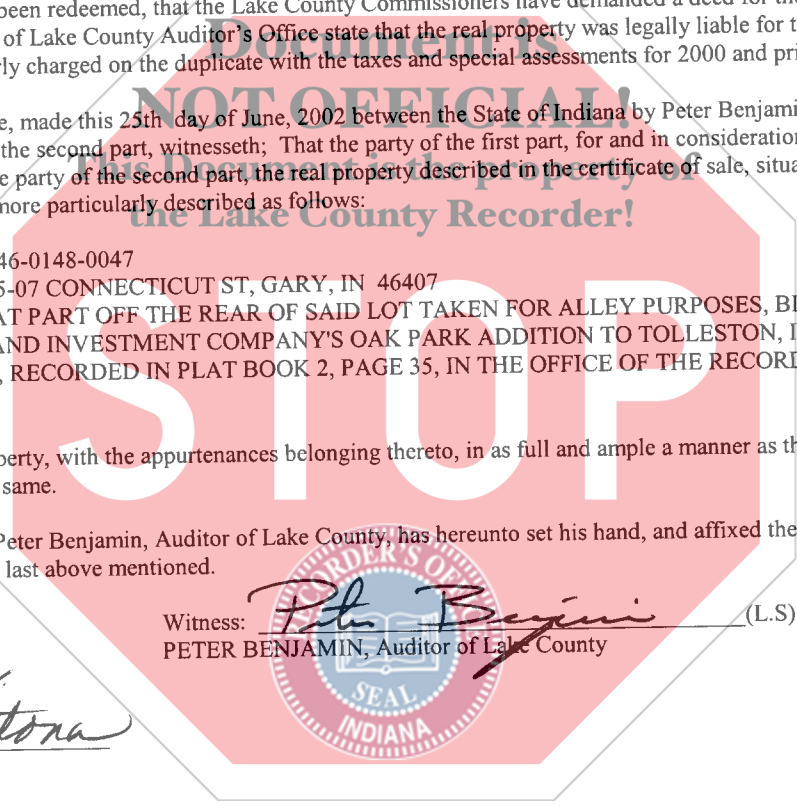

State of INDIANA }  
                                  }SS.  
County of LAKE        }

Before me, the undersigned, Anna N. Anton in and for said County, this day, personally came the above name Peter Benjamin of said County, and acknowledged that he signed and sealed the foregoing deed for the users and purposes therein mentioned.

In witness whereof, I have hereunto set my hand and seal this 9 day of AUG 9, 2002.

Anna N. Anton  
ANNA N. ANTON, Clerk of Lake County

This instrument prepared by Lee J. Christakis, Attorney  
7870 Broadway, Suite G.  
Merrillville, IN 46410

Post Office Address of grantee: 2293 N. Main Street  
Crown Point, IN 46307

**NOT-TAXABLE**  
AUG 09 2002  
PETER BENJAMIN  
LAKE COUNTY AUDITOR

02319

W/C