

2002 066520

2002 JUN 25 AM 9:41

SW

Prescribed by the State Board of Accounts

RECORDER

TAX TITLE DEED TO COUNTY

Whereas the Lake County Board of Commissioners did the 18th day of June, 2002 produced to the County of Lake, in the State of Indiana, a certificate of sale dated the 9/27/2001, signed by Peter Benjamin who, at the date of sale, was Auditor of the County, from which it appears that said County on the 9/27/2001, obtained, pursuant to law, the real property described in this indenture for the sum of ONE THOUSAND, ONE HUNDRED THIRTY-SIX AND 62/100 DOLLARS (\$1,136.62) being the amount due on the following tracts of land returned delinquent in the name MARSH, ROBERT C. for 2000 and prior years, namely:

Property ID: 14-20-0080-0024
Property Address: 4900 BL CENTRAL, LAKE STATION, IN 46405
LOT 24, BLOCK 8, IN PARK RIDGE ADDITION TO THE CITY OF EAST GARY, NOW IN THE CITY OF LAKE STATION, IN LAKE COUNTY, INDIANA.

Such real property has been recorded in the Office of the Lake County Auditor as delinquent for the nonpayment of taxes and proper notice of the sale has been given. It appearing that Lake County is the owner of the certificate of sale, that the time of redeeming such real property has expired, that the property has not been redeemed, that the Lake County Commissioners have demanded a deed for the real property described in the certificate of sale, that the records of Lake County Auditor's Office state that the real property was legally liable for taxation, and the real property has been duly assessed and properly charged on the duplicate with the taxes and special assessments for 2000 and prior years:

Therefore, this indenture, made this 18th day of June, 2002 between the State of Indiana by Peter Benjamin, Auditor of Lake County, of the first part, and Lake County of the second part, witnesseth; That the party of the first part, for and in consideration of the premises, has granted and bargained and conveyed to the party of the second part, the real property described in the certificate of sale, situated in the County of Lake, and the State of Indiana, namely and more particularly described as follows:

Property ID: 14-20-0080-0024
Property Address: 4900 BL CENTRAL, LAKE STATION, IN 46405
LOT 24, BLOCK 8, IN PARK RIDGE ADDITION TO THE CITY OF EAST GARY, NOW IN THE CITY OF LAKE STATION, IN LAKE COUNTY, INDIANA.

to have and to hold such real property, with the appurtenances belonging thereto, in as full and ample a manner as the Auditor of said County is empowered by law to convey the same.

In testimony where of Peter Benjamin, Auditor of Lake County, has hereunto set his hand, and affixed the seal of the Board of County Commissioners, the day and year last above mentioned.

Witness: Peter Benjamin (L.S)
PETER BENJAMIN, Auditor of Lake County

Peggy M Katona
Attest: PEGGY KATONA
Treasurer: Lake County

State of INDIANA }
 }SS.
County of LAKE }

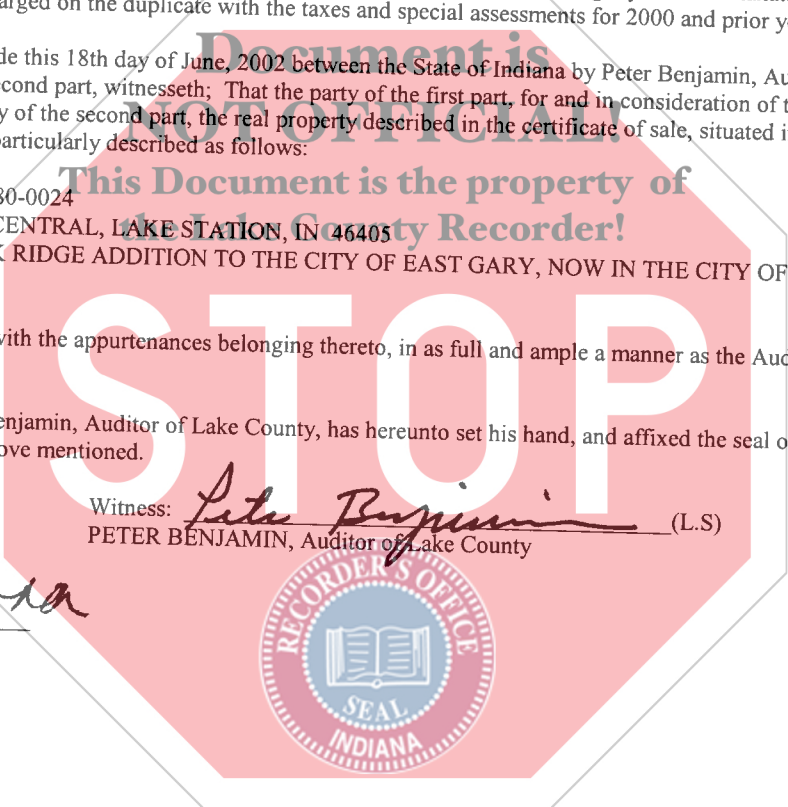

Before me, the undersigned, Anna N. Anton in and for said County, this day, personally came the above name Peter Benjamin of said County, and acknowledged that he signed and sealed the foregoing deed for the users and purposes therein mentioned.

In witness whereof, I have hereunto set my hand and seal this JUN 18 day of 2002.

Anna N. Anton
ANNA N. ANTON, Clerk of Lake County

This instrument prepared by Lee J. Christakis, Attorney
7870 Broadway, Suite G.
Merrillville, IN 46410

Post Office Address of grantee: 2293 N. Main Street
Crown Point, IN 46307

NOT-TAXABLE

JUL 23 2002

PETER BENJAMIN
LAKE COUNTY AUDITOR

02079 *M.V. Mc*