

2

2002 065430

2002 JUL 22 AM 10:52

MONROE COUNTY RECORDER

LF298-04
R298-04

QUITCLAIM DEED

THIS QUITCLAIM DEED, executed this 22nd day of July, 2002,
 by first party, Grantor, Tarin C. Serbenta (aka. Tarin E. Evacko)
 whose post office address is 702 W. Cline Ave. Griffith, IN 46319
 to second party, Grantee, Jeffrey J. Serbenta and Tarin C. Serbenta-HW
 whose post office address is 702 N. Cline Ave. Griffith, IN 46319

WITNESSETH, That the said first party, for good consideration and for the sum of
none Dollars (\$- NONE ->)
 paid by the said second party, the receipt whereof is hereby acknowledged, does hereby remise, release
 and quitclaim unto the said second party forever, all the right, title, interest and claim which the said first
 party has in and to the following described parcel of land, and improvements and appurtenances thereto in
 the County of Lake, State of Indiana to wit:

Lot 10 in Block 1 in Park Manor Third Addition to
 Griffith, as per plat therefore, recorded in Plat
 Book 30, page 30, in the Office of the Recorder of
 Lake County, Indiana.

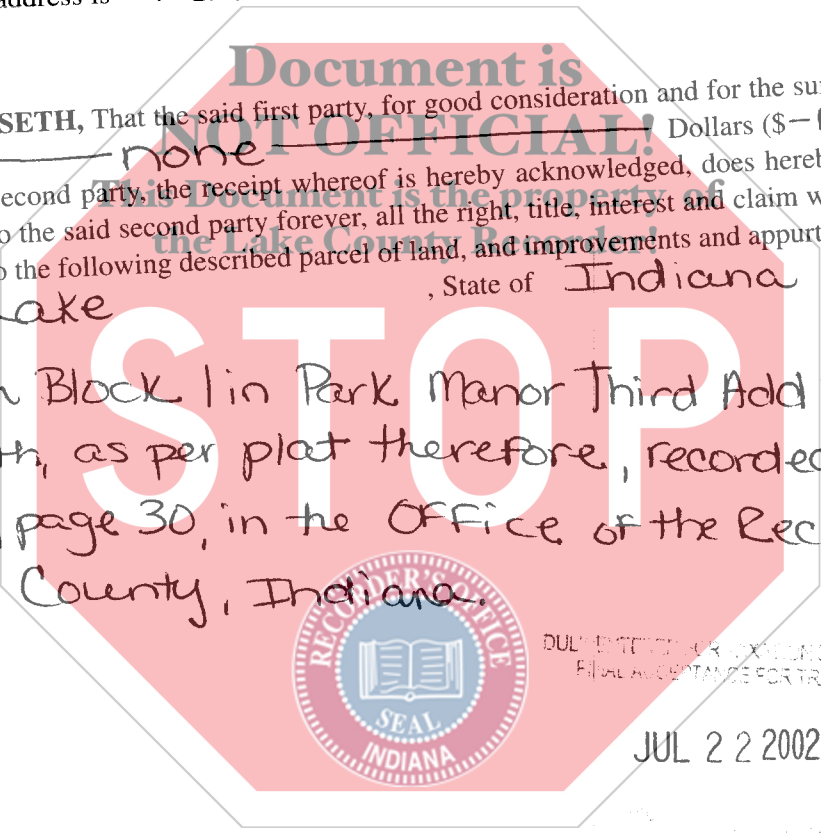

DULY TESTED AND ACCEPTED SUBJECT TO FIDELITY ACCEPTANCE FOR TRANSFER

JUL 22 2002

LAND GRANTOR

1438

16-00
OK
CAF

IN WITNESS WHEREOF, The said first party has signed and sealed these presents the day and year first above written. Signed, sealed and delivered in presence of:

Signature of Witness

Print name of Witness

Signature of Witness

Print name of Witness

X Jarin C. Serbenta AKA Jarin C. Evacko
Signature of First Party
X Tarin C. Serbenta AKA Tarin C. Evacko
Print name of First Party

Signature of First Party

Print name of First Party

State of INDIANA
County of LAKE

On 22-July-2002 before me, Louise P Carter
appeared TARIN C SERBENTA (AKA) TARIN C EVACKO
personally known to me (or proved to me on the basis of satisfactory evidence) to be the person(s) whose name(s) is/are subscribed to the within instrument and acknowledged to me that he/she/they executed the same in his/her/their authorized capacity(ies), and that by his/her/their signature(s) on the instrument the person(s), or the entity upon behalf of which the person(s) acted, executed the instrument.
WITNESS my hand and official seal.

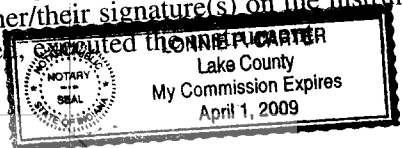

Louise P Carter
Signature of Notary

Affiant Known Produced ID
Type of ID DRIVERS (Seal)

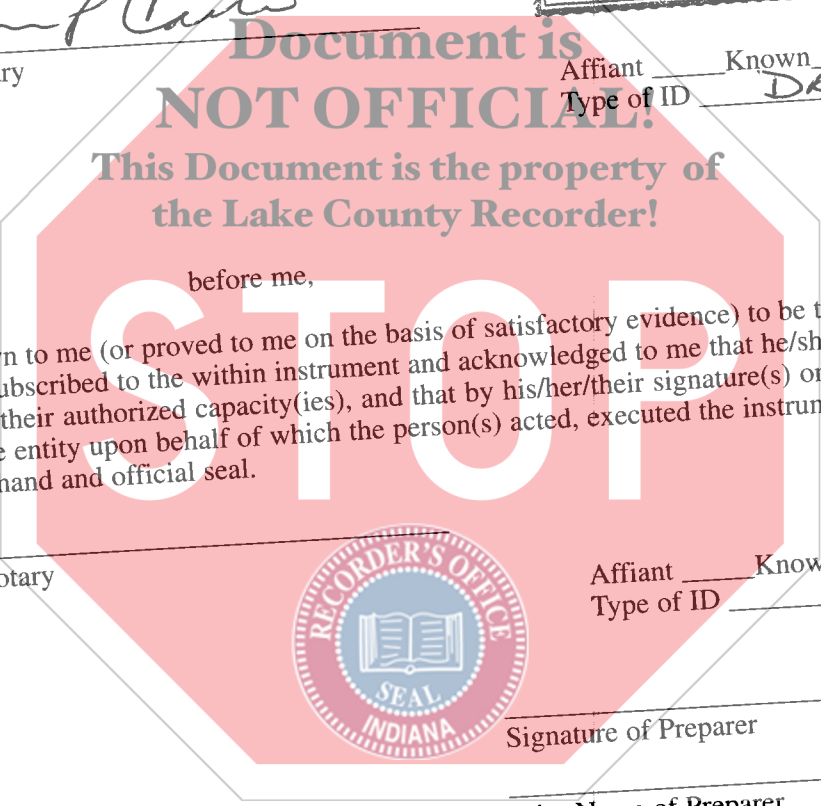

State of _____
County of _____
On _____

appeared _____
personally known to me (or proved to me on the basis of satisfactory evidence) to be the person(s) whose name(s) is/are subscribed to the within instrument and acknowledged to me that he/she/they executed the same in his/her/their authorized capacity(ies), and that by his/her/their signature(s) on the instrument the person(s), or the entity upon behalf of which the person(s) acted, executed the instrument.
WITNESS my hand and official seal.

Signature of Notary

Affiant Known Produced ID
Type of ID _____ (Seal)

Signature of Preparer

Print Name of Preparer

Address of Preparer