

2

FILED
L. A. T. W.
FILED

2002 060350

2002 JUL -5 PM 4: 22

MORRIS W. CARTER
RECORDER

A298-10
R298-04

QUITCLAIM DEED

THIS QUITCLAIM DEED, executed this 5 day of July, (year), 2002
 by first party, Grantor, JAMES E. DAVIS, Willard A. DAVIS, & GREGORY D. DAVIS
 whose post office address is 1201 E. 19th Ave. GARY, IN. 46407
 to second party, Grantee, BEATRICE PITTMAN
 whose post office address is 5600 E. 10th Ave. GARY, IN. 46403

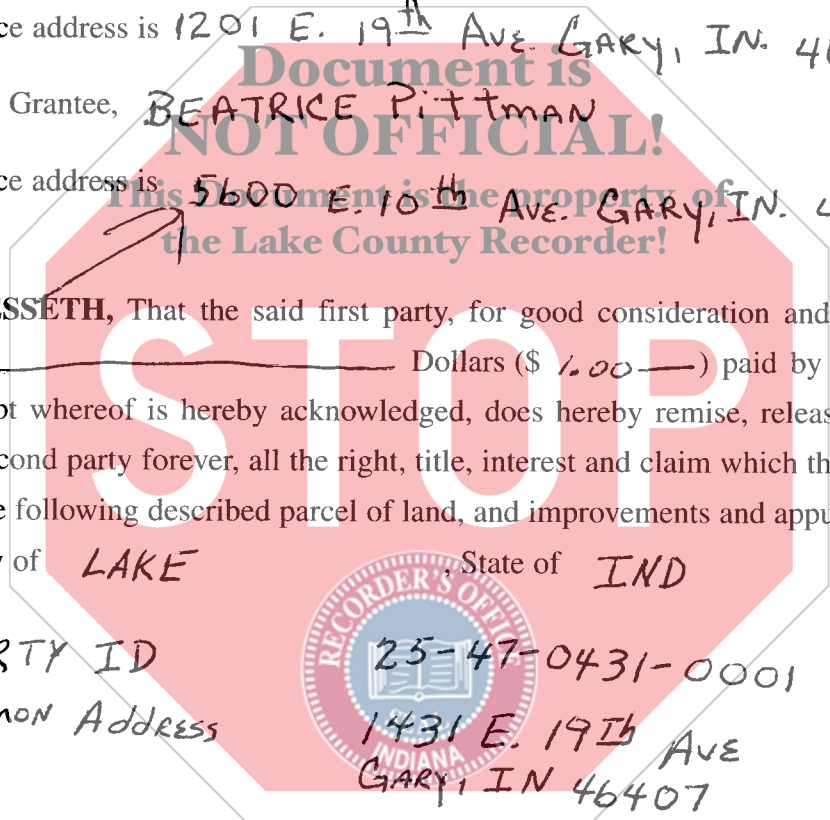

WITNESSETH, That the said first party, for good consideration and for the sum of
 ONE Dollars (\$ 1.00) paid by the said second
 party, the receipt whereof is hereby acknowledged, does hereby remise, release and quitclaim
 unto the said second party forever, all the right, title, interest and claim which the said first party
 has in and to the following described parcel of land, and improvements and appurtenances there-
 to in the County of LAKE, State of IND to wit:

PROPERTY ID

Common Address

Legal Description

25-47-0431-0001

1431 E. 19th Ave
GARY, IN 46407

LOTS ONE (1) IN BLOCK THREE (3),
IN SECOND ADDITION TO PULASKI
VILLAGE, IN GARY, LAKE COUNTY IND.

(1)
AKAZ

© 1992-2000 E-Z Legal Forms, Inc.

Rev. 6/00

This product does not constitute the rendering of legal advice or services. This product is intended for informational use only and is not a substitute for legal advice. State laws vary, so consult an attorney on all legal matters. This product was not necessarily prepared by a person licensed to practice law in this state.

If your state requires 8 1/2" x 11" forms, cut off the bottom of this page at the dotted line.

DULY REGISTERED FOR RECORDING SUBJECT TO
FIELD ACCEPTANCE FOR TRANSFER

JUL 5 2002

PETER BENJAMIN
LAKE COUNTY AUDITOR

16-
S. J.
Q.S

1100346

IN WITNESS WHEREOF, The said first party has signed and sealed these presents the day and year first above written. Signed, sealed and delivered in presence of:

Signature of Witness

James E. Davis
Signature of First Party

Print name of Witness

JAMES E. DAVIS
Print name of First Party

Signature of Witness

Gregory D. Davis
Signature of First Party

Print name of Witness

GREGORY D. DAVIS
Print name of First Party

State of _____ }
County of Lake }
On _____ before me,
appeared

personally known to me (or proved to me on the basis of satisfactory evidence) to be the person(s) whose name(s) is/are subscribed to the within instrument and acknowledged to me that he/she/they executed the same in his/her/their authorized capacity(ies), and that by his/her/their signature(s) on the instrument the person(s), or the entity upon behalf of which the person(s) acted, executed the instrument.
WITNESS my hand and official seal.

Marguerite Montgomery
Signature of Notary Marguerite Montgomery
5-28-08

Affiant _____ Known _____ Produced ID _____
Type of ID DL's (Seal)

State of _____ }
County of Lake }
On _____ before me,
appeared

personally known to me (or proved to me on the basis of satisfactory evidence) to be the person(s) whose name(s) is/are subscribed to the within instrument and acknowledged to me that he/she/they executed the same in his/her/their authorized capacity(ies), and that by his/her/their signature(s) on the instrument the person(s), or the entity upon behalf of which the person(s) acted, executed the instrument.
WITNESS my hand and official seal.

Marguerite Montgomery
Signature of Notary Marguerite E. Montgomery
5-28-08

Affiant _____ Known _____ Produced ID _____
Type of ID DL (Seal)

Willard A. Davis
Signature of Preparer

Willard A. DAVIS
Print Name of Preparer

1201 E. 19th Ave
Address of Preparer

GARY, IN. 46407

(2)

If your state requires 8 1/2" x 11" forms, cut off the bottom of this page at the dotted line.