

1

2002-06-158

2002 JUL -5 AM 9:56

Mail tax bills to: 241 Mill St., Lowell, IN 46356
L 620023652LO

MURKIN B. CARTER
RECORDER

WARRANTY DEED

Chicago Title Insurance Company

THIS INDENTURE WITNESSETH, That MARK DREXLER and SUSAN H. DREXLER, HUSBAND and WIFE

("Grantor") of LAKE County in the State of INDIANA CONVEY(S) AND WARRANT(S) TO JAMES LaCOSSE, JR. and ELIZABETH LaCOSSE, HUSBAND and WIFE A. E. JL

("Grantee") of LAKE County in the State of INDIANA in consideration of One Dollar and other valuable consideration, the receipt and sufficiency of which are hereby acknowledged, the following described real estate in LAKE County in the State of Indiana:

Lots A9 and A10 in Halsted's Second Addition to Lowell, as per plat thereof, recorded in Miscellaneous Record "A", Page 516, in the Office of the Recorder of Lake County, Indiana, more commonly known as:

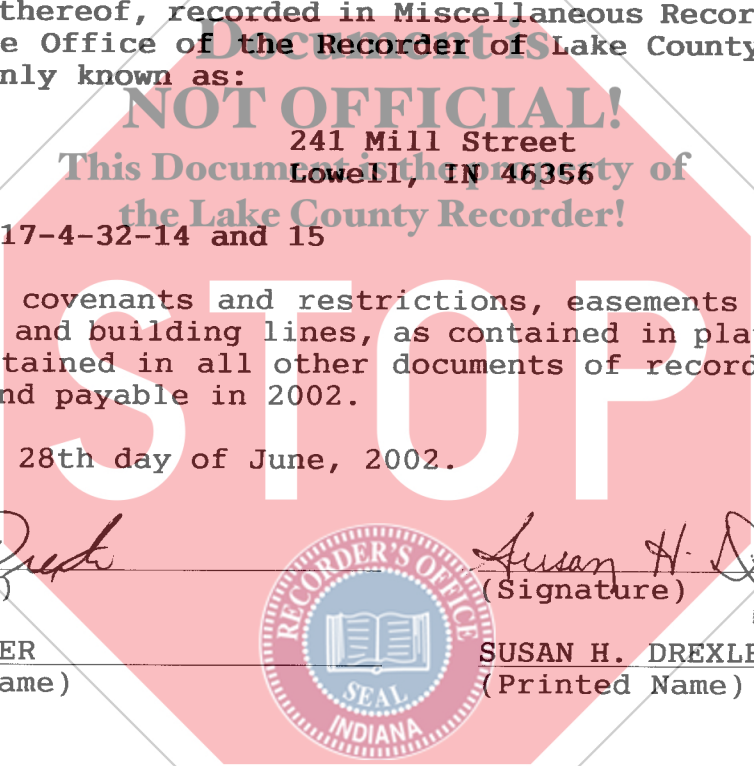

Tax Key # 17-4-32-14 and 15

Subject to covenants and restrictions, easements for streets and utilities, and building lines, as contained in plat of subdivision and as contained in all other documents of record; and taxes for 2001 due and payable in 2002.

Dated this 28th day of June, 2002.

Mark Drexler
(Signature)

Susan H. Drexler
(Signature)

MARK DREXLER
(Printed Name)

SUSAN H. DREXLER
(Printed Name)

DULY ENTERED FOR TAXATION SUBJECT TO FINAL ADJUSTMENT FOR TRANSFER

JUL 3 2002

**STATE OF INDIANA)
) SS:
COUNTY OF LAKE)**

**PETER BENJAMIN
LAKE COUNTY AUDITOR**

Before me, the undersigned, a Notary Public in and for said County and State, this 28th day of June, 2002, personally appeared:

**MARK DREXLER and SUSAN H. DREXLER,
HUSBAND and WIFE**

and acknowledged the execution of the foregoing deed. In witness whereof I have hereunto subscribed my name and affixed my official seal.

My Comm. Exp.: 25 March, 2008
Resident of Porter County

Signature *Marie R. Thompson*
Printed **MARIE R. THOMPSON**

This instrument prepared by ATTY. JOSEPH S. IRAK, 9219 Broadway, M'ville, IN 46410 Atty. I.D. #4851-45 (219) 769-4552

MAIL TO:

15.00
m.v.
CT