

LAKE COUNTY
FILED FOR RECORD

2002 059730

2002 JUL -3 AM 9:40

ADMINIS W. CARTER
RECORDER

MAIL TAX BILLS TO:
P.O. BOX 898
SCHERERVILLE, IN 46375

RETURN TO: GLENN R. PATTERSON, ESQ.
TAUBER & WESTLAND, P.C.
9211 BROADWAY
MERRILLVILLE, IN 46410

CORPORATE WARRANTY DEED

THIS INDENTURE WITNESSETH THAT MEYERS DEVELOPMENT CORP. (the "Grantor") **CONVEYS AND WARRANTS** to **DENNIS E. MEYERS and BARBARA A. MEYERS, husband and wife as tenants by the entireties**, in consideration of the sum of Ten Dollars (\$10.00) and other good and valuable consideration, the receipt and sufficiency of which is hereby acknowledged, the following described real estate situated in Lake County, in the State of Indiana, to-wit:

Lot 24, First Amended Plat of Meyers Addition, a Planned Unit Development in St. John, Indiana, as shown in Plat Book 89, page 37, in Lake County, Indiana.

Commonly known as 8315 Meadow Lane, St. John, Indiana.

Tax Key No.:

Tax Unit No.: 22

SUBJECT, NEVERTHELESS, TO THE FOLLOWING:

1. Taxes for 2002, payable in 2003, and for all years thereafter.
2. All covenants, easements, rights of way, building lines, highways, roads, streets, alleys and other restrictions of beneficial use and enjoyment of record, and all facts and matters affecting legal and equitable ownership and possession of the real estate which would be, or should have been, revealed and disclosed by an accurate survey of the real estate described above.

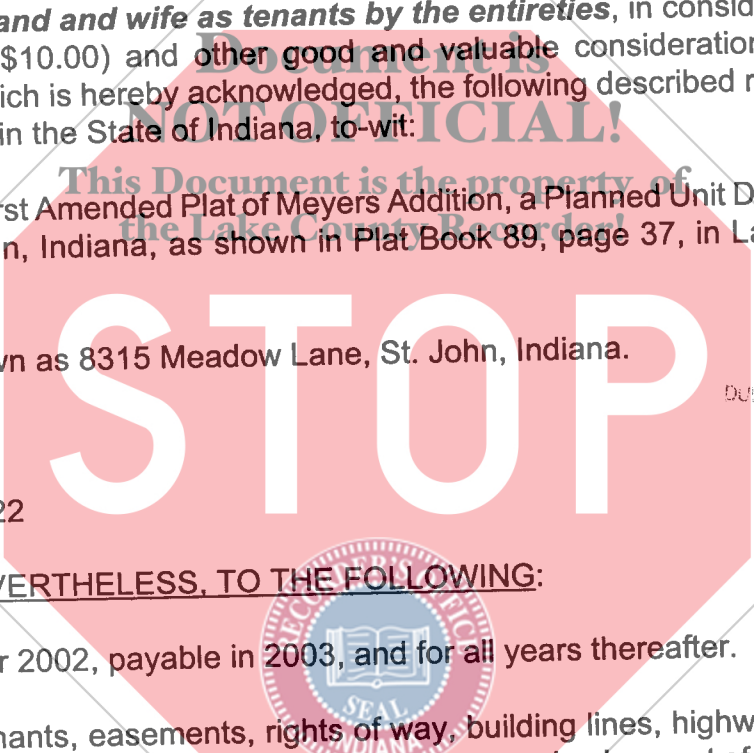

DUP... SUBJECT TO
ACCEPTANCE FOR TRANSFER

JUL 3 2002

PETER BENJAMIN
LAKE COUNTY AUDITOR

Handwritten initials: 16, n.f., CS

