

2

OFFICE OF THE
LAKE COUNTY
RECORDER
FILED FOR RECORD

2002 059549

2002 JUL -2 PM 1:53

MORRIS W. CARTER
RECORDER

LF298-04
R298-04

QUITCLAIM DEED

THIS QUITCLAIM DEED, executed this *2nd* day of *July*, 20 *02*,
by first party, Grantor, *Sina Michele*
whose post office address is *3917 Bayberry Lane, Highland, IN 46322*
to second party, Grantee, *Sina Michele Pilacek + Charles Scott Pilacek*
whose post office address is *3917 Bayberry Lane, Highland, IN 46322*

WITNESSETH, That the said first party, for good consideration and for the sum of _____ Dollars (\$ *10.00*)
paid by the said second party, the receipt whereof is hereby acknowledged, does hereby remise, release
and quitclaim unto the said second party forever, all the right, interest and claim which the said first
party has in and to the following described parcel of land, and improvements and appurtenances thereto in
the County of *Lake*, State of *Indiana* to wit:

*Lot forty-six (46) in Sandalwood subdivision, Phase
Two, an addition to the town of Highland, as per plat
thereof recorded in Plat Book 82, Page 91, in the Office
of the Recorder of Lake County, Indiana. 16-21-642-22*

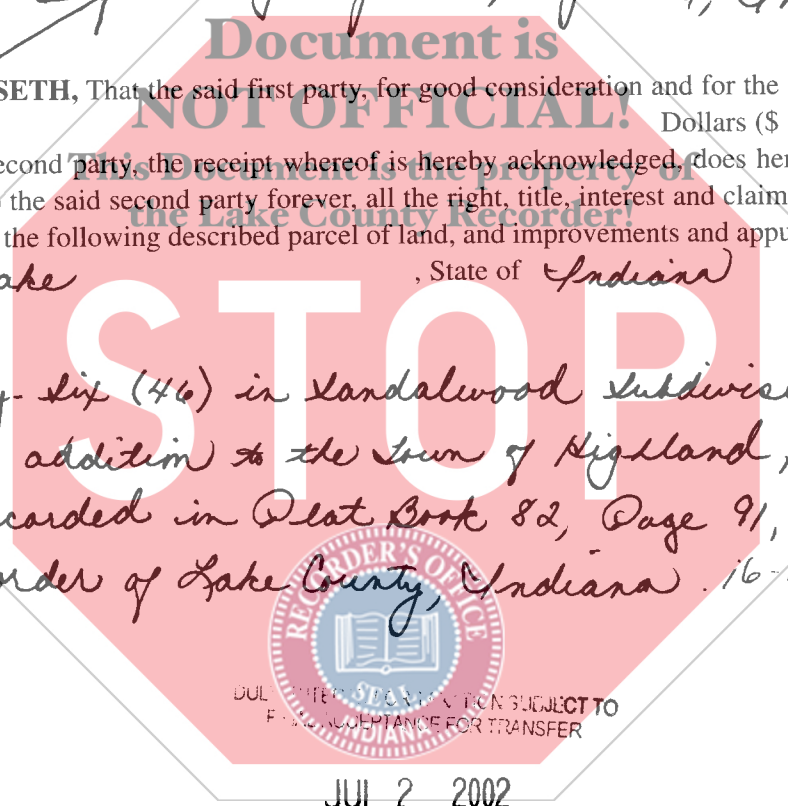

JUL 2 2002
PETER BENJAMIN
LAKE COUNTY AUDITOR

*16-
M.H.
CS*

AKAB

IN WITNESS WHEREOF, The said first party has signed and sealed these presents the day and year first above written. Signed, sealed and delivered in presence of:

Signature of Witness

**Gina Micheletto Rihacek*
Signature of First Party

Print name of Witness

X Gina Micheletto Rihacek
Print name of First Party

Signature of Witness

Signature of First Party

Print name of Witness

Print name of First Party

State of INDIANA
County of LAKE

On 2-July-2002 before me, Lonnie P Carter
appeared Gina Micheletto AKA GINA Micheletto Rihacek
personally known to me (or proved to me on the basis of satisfactory evidence) to be the person(s) whose name(s) is/are subscribed to the within instrument and acknowledged to me that he/she/they executed the same in his/her/their authorized capacity(ies), and that by his/her/their signature(s) on the instrument the person(s), or the entity upon behalf of which the person(s) acted, executed the instrument.
WITNESS my hand and official seal.

Lonnie P Carter
Signature of Notary

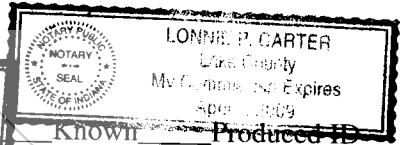
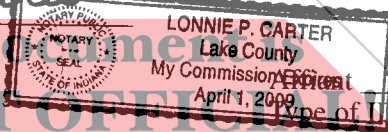

Known _____ Produced ID _____
DRIVER'S
(Seal)

State of _____
County of _____
On _____

appeared _____
personally known to me (or proved to me on the basis of satisfactory evidence) to be the person(s) whose name(s) is/are subscribed to the within instrument and acknowledged to me that he/she/they executed the same in his/her/their authorized capacity(ies), and that by his/her/their signature(s) on the instrument the person(s), or the entity upon behalf of which the person(s) acted, executed the instrument.
WITNESS my hand and official seal.

Signature of Notary

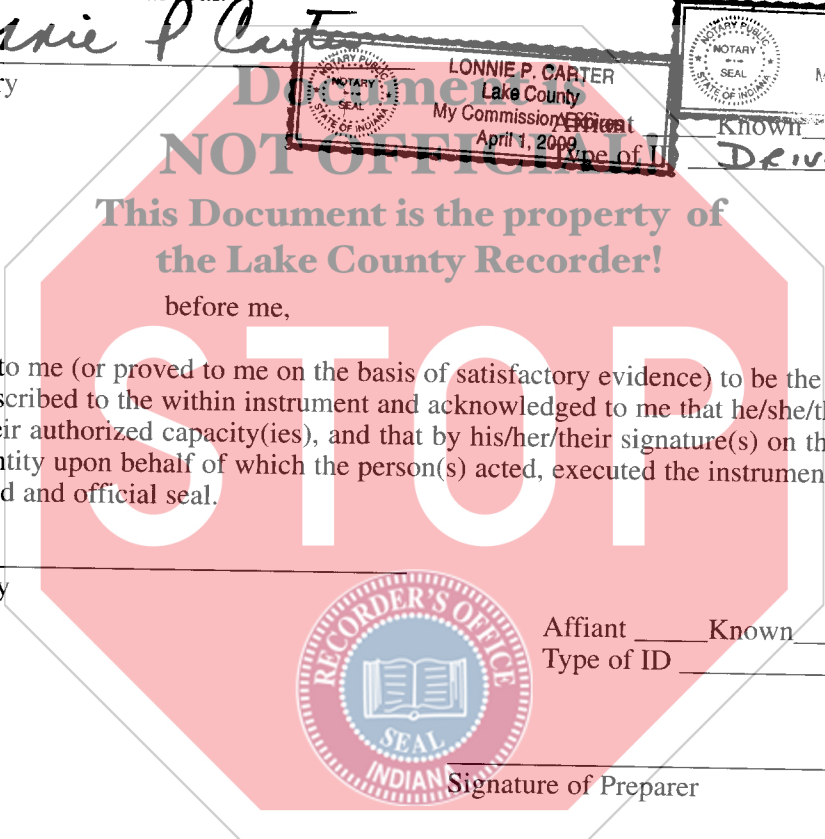

Affiant _____ Known _____ Produced ID _____
Type of ID _____
(Seal)

Signature of Preparer

Print Name of Preparer

Address of Preparer