

3

Form QCD-1  
8/98

2002 058285

LAKE COUNTY  
QUIT CLAIM DEED  
2002 JUN 27 AM 11:49

MORRIS W. CARTER  
RECORDER

Project: NH-019-4(014)  
Code: 3847  
Parcel: 31SA ✓  
Page: 1 of 2

THIS INDENTURE WITNESSETH, That Shreeji Hospitality, Inc., a INDIANA  
Corporation

the Grantor(s), of LAKE County, State of INDIANA Release(s) and Quit  
Claim(s) to the STATE OF INDIANA, the Grantee, for and in consideration of the sum of Three Thousand  
Four Hundred Dollars (\$ 3,400.00 ) (of which said sum \$ -0-  
represents land and improvements and \$ 3,400.00 represents damages) and other valuable consideration, the  
receipt of which is hereby acknowledged, certain Real Estate situated in the County of Lake, State of Indiana, and being more  
particularly described in the legal description attached hereto as Exhibit "A" and depicted upon the Right of Way Parcel Plat  
attached hereto as Exhibit "B," both of which exhibits are incorporated herein by reference.

The Grantor(s) hereby specifically acknowledge(s) and agree(s) that the Real Estate conveyed herein is conveyed in  
fee simple and that no reversionary rights whatsoever shall remain with the Grantor(s), or any successors in title to the  
abutting lands of the Grantor(s), notwithstanding any subsequent abandonment, vacation, disuse, nonuse, change of use,  
conveyance, lease and/or transfer by the Grantee or its successors in title, of a portion or all of the said Real Estate or any  
right of way, roadway or roadway appurtenances established thereupon. This acknowledgement and agreement is a covenant  
running with the land and shall be binding upon the Grantor(s) and all successors and assigns.

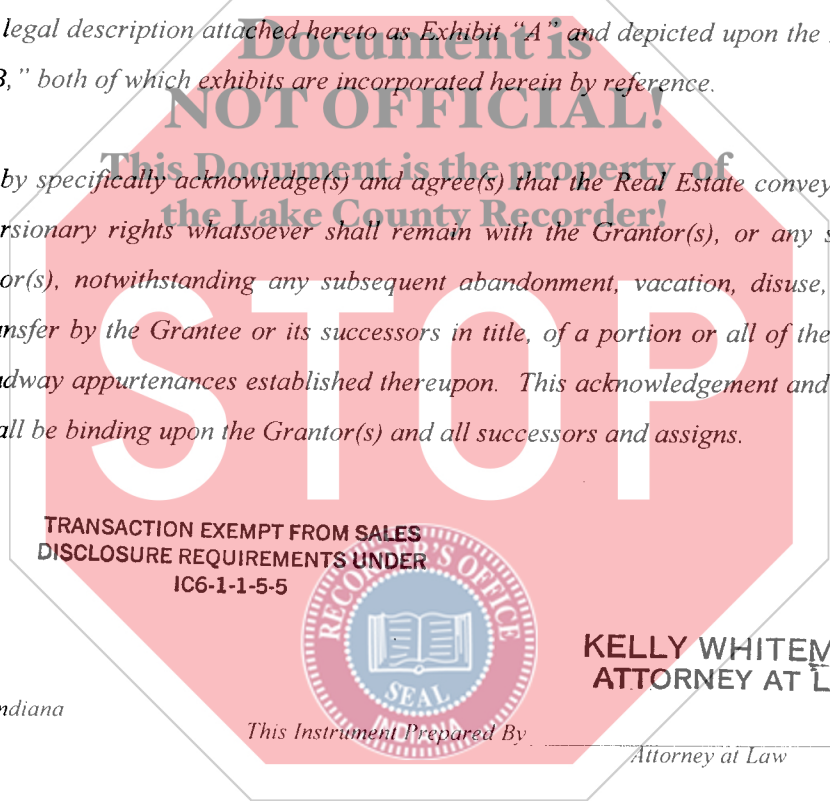

TRANSACTION EXEMPT FROM SALES  
DISCLOSURE REQUIREMENTS UNDER  
IC6-1-1-5-5



KELLY WHITEMAN  
ATTORNEY AT LAW

This Instrument Prepared By \_\_\_\_\_  
Attorney at Law

Interests in land acquired by the Indiana  
Department of Transportation  
Grantee mailing address:  
100 North Senate Avenue  
Indianapolis, IN 46204-2219  
I.C. 8-23-7-31

DULY ENTERED FOR TAXATION SUBJECT TO  
FINAL ACCEPTANCE FOR TRANSFER

JUN 25 2002

PETER BENJAMIN  
LAKE COUNTY AUDITOR

0001-198

N/C  
S.H.

Project: NH-019-4(014)  
Code: 3847  
Parcel: 31SA  
Page: 2 of 2

The undersigned persons executing this deed represent and certify on behalf of the Grantor, that he/she is a duly elected officer of the Grantor and has been fully empowered by proper resolution, or the by-laws of the Grantor, to execute and deliver this deed; that the Grantor is a corporation in good standing in the State of its origin and, where required, in the State where the subject real estate is situate; that the Grantor has full corporate capacity to convey the real estate described; and that all necessary corporate action for the making of this conveyance has been duly taken.

IN WITNESS WHEREOF, the said Grantor(s) ha s executed this instrument this 7 day of May, 2002.  
Shreeji Hospitality, Inc.

By: [Signature] (Seal) \_\_\_\_\_ (Seal)  
Signature \_\_\_\_\_ Signature \_\_\_\_\_

Jay Patel, President  
Printed Name \_\_\_\_\_ Printed Name \_\_\_\_\_

Attest: [Signature] (Seal) \_\_\_\_\_ (Seal)  
Signature \_\_\_\_\_ Signature \_\_\_\_\_

Vijay Patel, Secretary  
Printed Name \_\_\_\_\_ Printed Name \_\_\_\_\_

STATE OF IN :  
COUNTY OF LAKE : SS:

Before me, a Notary Public in and for said State and County, personally appeared Jay Patel, President and Vijay Patel, Secretary of Shreeji Hospitality, Inc.

the Grantor(s) in the above conveyance, and acknowledged the execution of the same on the date aforesaid to be its voluntary act and deed and who, being duly sworn, stated that any representations contained therein are true.

Witness my hand and Notarial Seal this 7 day of May, 2002.  
[Signature] \_\_\_\_\_ CHARLOTTE THOMAS  
Signature \_\_\_\_\_ Printed \_\_\_\_\_ Notary Public

My Commission Expires January 29, 2003 I am a resident of LAKE County.

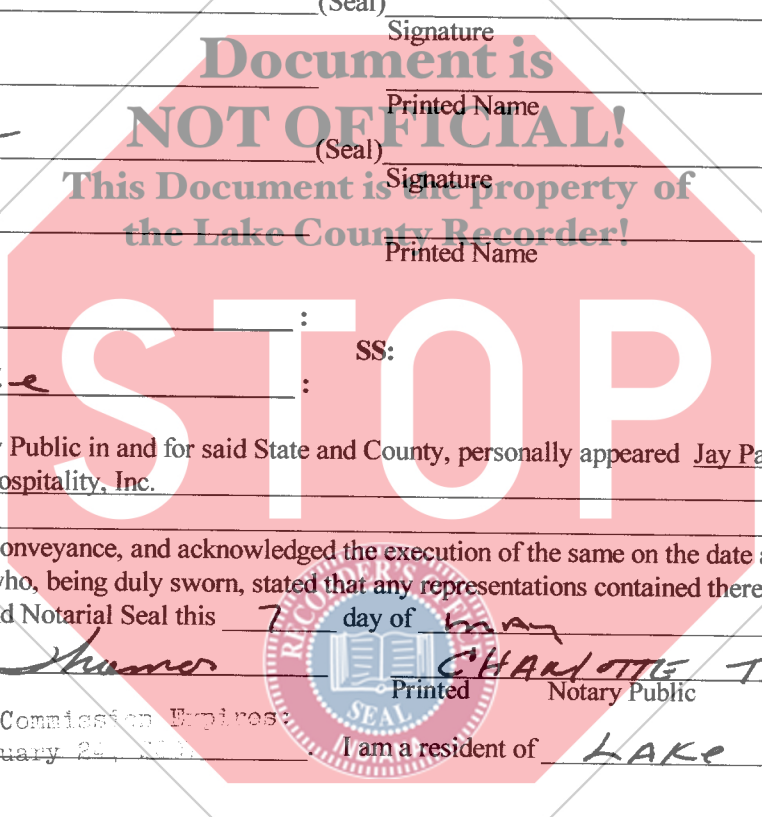

EXHIBIT "A"

Project: NH-019-4(014)

Sheet 1 of 1

Code: 3847

Parcel: 31SA

A part of Lot 1 in Schultz Addition, Unit 1, an addition to the Town of Schererville, Indiana, the plat of which is recorded in Plat Book 47, page 145, in the Office of the Recorder of Lake County, Indiana, and being that part of the grantors' land lying within the right-of-way lines depicted on the attached Right-of-Way Parcel Plat marked as Exhibit "B", described as follows: Beginning at the northwest corner of said lot; thence South 89 degrees 29 minutes 26 seconds East 9.032 meters (29.63 feet) along the north line of said lot to point "3031" designated on said parcel plat; thence South 16 degrees 07 minutes 32 seconds West 5.752 meters (18.87 feet) to point "3030" designated on said parcel plat; thence South 4 degrees 13 minutes 15 seconds East 30.000 meters (98.43 feet) to point "3029" designated on said parcel plat; thence South 9 degrees 13 minutes 39 seconds East 22.917 meters (75.19 feet) to the south line of said lot at point "3028" designated on said parcel plat; thence North 89 degrees 29 minutes 26 seconds West 9.217 meters (30.24 feet) along said south line to the southwest corner of said lot; thence North 4 degrees 02 minutes 20 seconds West 58.208 meters (190.97 feet) along the western line of said lot to the point of beginning and containing 441.2 square meters (4,749 square feet), more or less.

This description was prepared for the Indiana Department of Transportation by Lawrence C. Suhre, Indiana Registered Land Surveyor, License Number 910018, on the 31<sup>st</sup> day of October, 2000.

This description was written from information obtained from the recorder's office and other sources which were not necessarily checked by a field survey.



*Lawrence C. Suhre*