

3

STATE OF INDIANA
LAKE COUNTY
FILED FOR RECORD

Mail Tax Bills to:
John F. Scheuer and Francis C. Scheuer
1930 RIVERLANE DR.
LAKE STATION, IN 46405

2002 048518

2002 MAY 28 AM 8:48 Key # 20-133-11

MORRIS W. CARTER
RECORDER

TICOR HBT 920022018

STATE OF INDIANA)
) SS: IN THE SUPERIOR COURT
COUNTY OF LAKE)
) SITTING AT EAST CHICAGO, INDIANA

IN THE MATTER OF THE ESTATE)
OF:)
) ESTATE NO. 45D02-0201-ES-0031
ANNA J. HARMAN, Deceased.) **Filed in Open Court**

PERSONAL REPRESENTATIVE'S DEED

MAY 08 2002

Harry D. Harman, as executor of the estate of Anna J. Harman, deceased, which estate is under the supervision of the Superior Court of Lake County, Indiana, pursuant to an Order of the Superior Court of Lake County, Clerk of the Superior Court of Lake County, Indiana, dated the 2nd day of May, 2002, hereby conveys to John F. Scheuer and Francis C. Scheuer, Husband and Wife, of Lake County, State of Indiana, for the sum of One Dollar (\$1.00), the receipt of which is hereby acknowledged, the following described real estate in Lake County, State of Indiana, to-wit:

Lot 11 and 12, except the East 10 feet thereof, in Block 1, in Yonan Air-Park Homesites, in the City of Lake Station, as per plat thereof, recorded in Plat Book 27 page 22, in the Office of the Recorder of Lake County, Indiana.

Commonly known as: 1930 Riverlane Drive, Lake Station IN

Subject to the following:

- 1. Real Estate taxes, beginning with the installment due and payable in May, 2002, and taxes for all subsequent years, not yet due and payable.

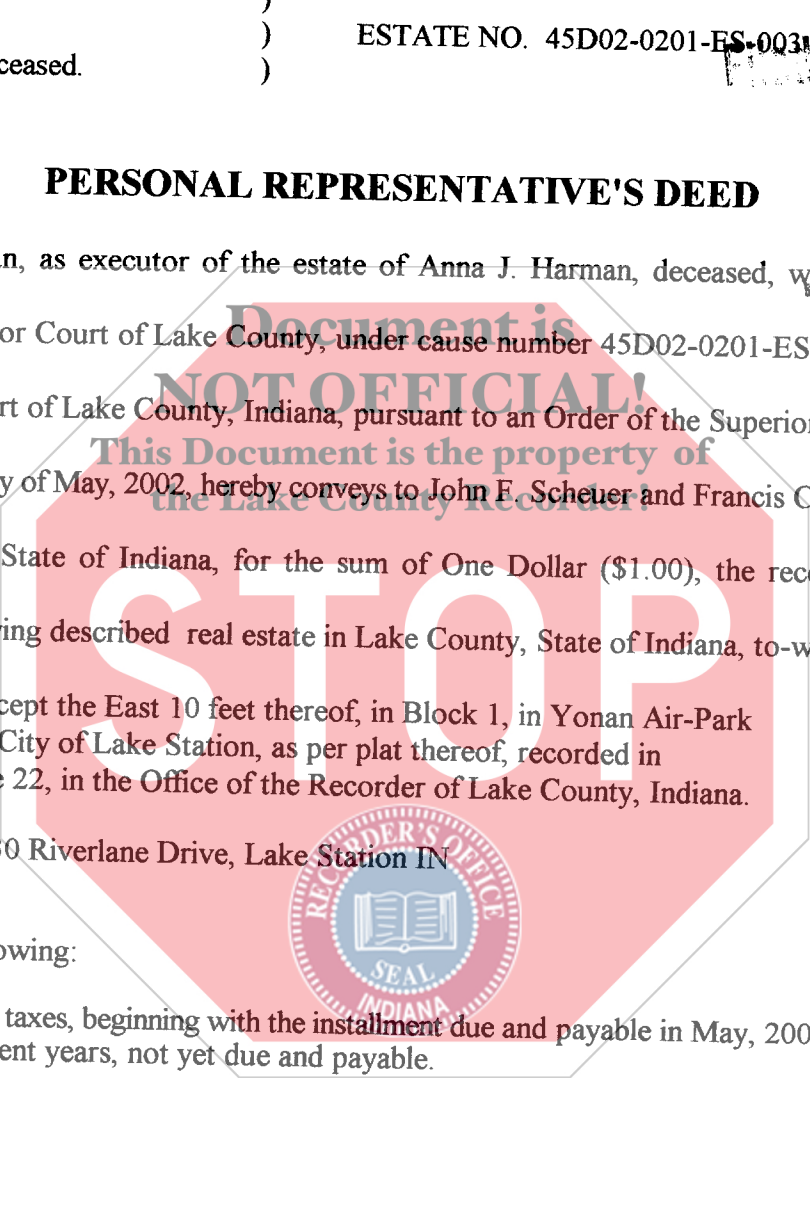

William C. Davis
SUPERIOR COURT CLERK
CIVIL DIVISION, COURT ROOM

MAY 24 2002

MAY 24 2002

MAY 24 2002

M-H
M-H
H-H

2. Easements, covenants and restrictions contained in prior instruments of record; all building and zoning laws, ordinances, legal drains, right-of-way, and other matters which would be disclosed by an accurate survey of the premises.
3. Liens and encumbrances, if any, created by the acts of the herein grantees.

IN WITNESS WHEREOF, said Harry D. Harman, executor of the estate of Anna J. Harman, has hereunto set his hand and seal this 2 day of May, 2002.

Harry D. Harman
 Harry D. Harman, Executor
 of the Estate of Anna J. Harman

STATE OF ILLINOIS)
) SS:
 COUNTY OF McHenry)

Before me, the undersigned, a Notary Public in and for said county and state, personally appeared Harry D. Harman, and being first duly sworn by me upon his oath, says that the facts alleged in the foregoing instrument are true.

Signed and sealed this 2nd day of May, 2002.



Deborah Finn
 ALL OF WHICH IS FOUND AND RECOMMENDED this 8th day of May, 2002.

ITSIA D. RIVERA
 Probate Commissioner

ALL OF WHICH IS ORDERED AND APPROVED this 8th day of May, 2002.

William E. Davis
 WILLIAM E. DAVIS
 Judge, Lake Superior Court

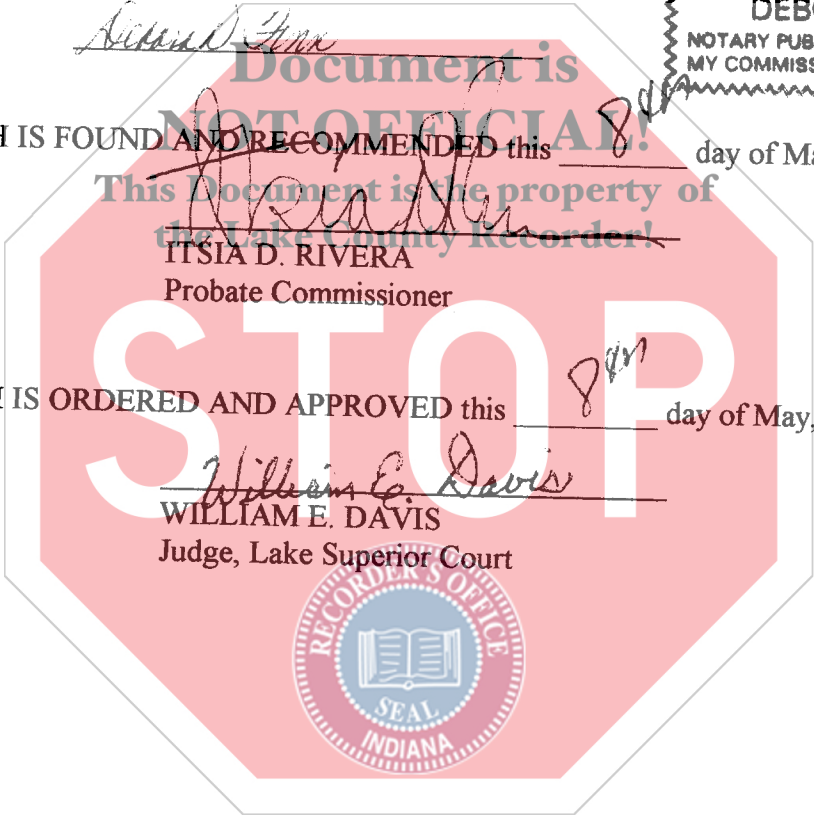

*This instrument prepared by Patricia A. Rees
 5341 Central Avenue, Portage, IN 46368 (219) 947-1692*