

# QUIT - CLAIM DEED

*This Indenture Witnesseth*, That Donors, Benigene Allen and Margie L. Allen of Porter County, in the State of Indiana, *release and Quit-Claim* to Trustees of The Allen Charitable Remainder Trust of Porter County, in the State of Indiana, for and in consideration of \$10.00 (Ten) Dollars, and other valuable consideration, the receipt whereof is hereby acknowledged, the following described Real Estate in Lake County in the State of Indiana, to-wit.

Commonly known as 2522 Fairview, Lake Station, Indiana, 46405.

Described as follows:

Lots 3 and 4 except the North 52 feet thereof, Block 5 Lake Station Addition to East Gary, recorded in Plat Book 11, page 26, in the Office of the Recorder of Lake County, Indiana, except the Easterly 16 feet of lot 3 except the north 52 feet thereof, Block 5, Lake Station Addition to East Gary, as per Plat thereof, recorded in Plat Book 11, page 26, in the Office of the Recorder in Lake County, Indiana.

In Witness Whereof, The said Benigene Allen and Margie L. Allen

has hereunto set their hand and seal, this 24th day of May

Benigene Allen (Seal)

Margie L. Allen (Seal)

\_\_\_\_\_ (Seal)

STATE OF INDIANA, Porter COUNTY, ss: \_\_\_\_\_

Before me, the undersigned, a Notary Public in and for said County, this \_\_\_\_\_ day of May

Benigene Allen & Margie L. Allen, and acknowledged the execution of the foregoing instrument.

Witness my hand and official seal.

My Commission expires 10/25/09

Wilma J. Parker Notary Public.  
Wilma J. Parker  
Resident of Porter County

Prepared by Benigene Allen

CRUTQUITCLAIM

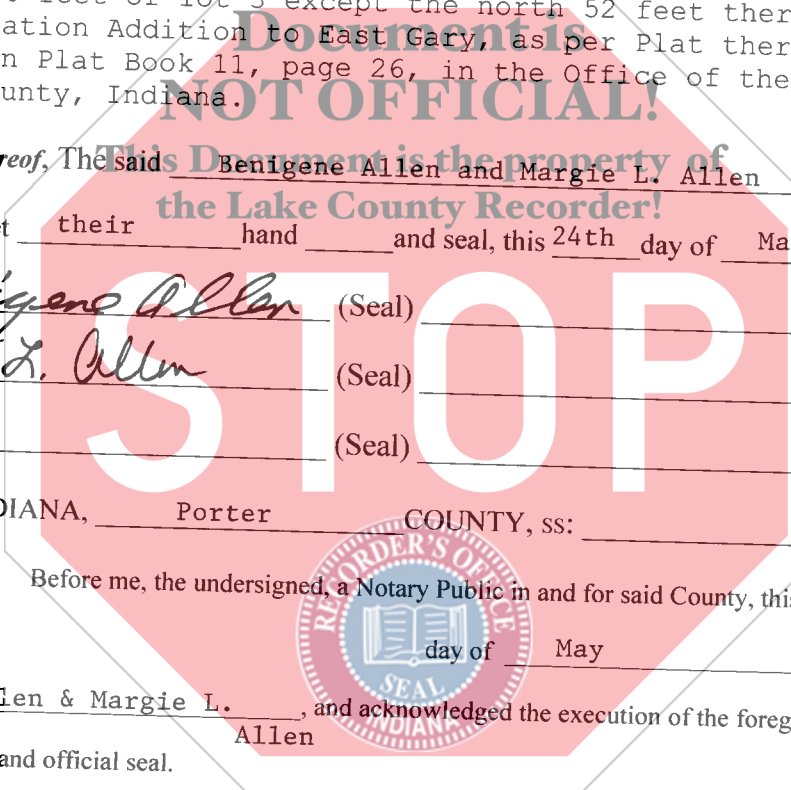

MAY 24 2002

2002 0481992  
2002 MAY 24 PM 3:22

STATE OF INDIANA  
LAKE COUNTY  
FILED FOR RECORD  
MORRIS R. CARTER  
RECORDER

15-  
NOT  
CS  
002001