

MAY 22 2002

2002 047735

2002 NOV 14 AM 11:32

RECORDER'S OFFICE
LAKE COUNTY AUDITOR

LAKE COUNTY RECORDER

Loan #

A298-10
R298-04

QUITCLAIM DEED

8300000261

THIS QUITCLAIM DEED, Executed this 14th day of November, 2000 (year),

by first party, Grantor, Mable Roddy

whose post office address is 844 Fillmore Street Gary, IN 46402

to second party, Grantee, Florine Gray

whose post office address is 980 Clark Road Gary, IN 46404

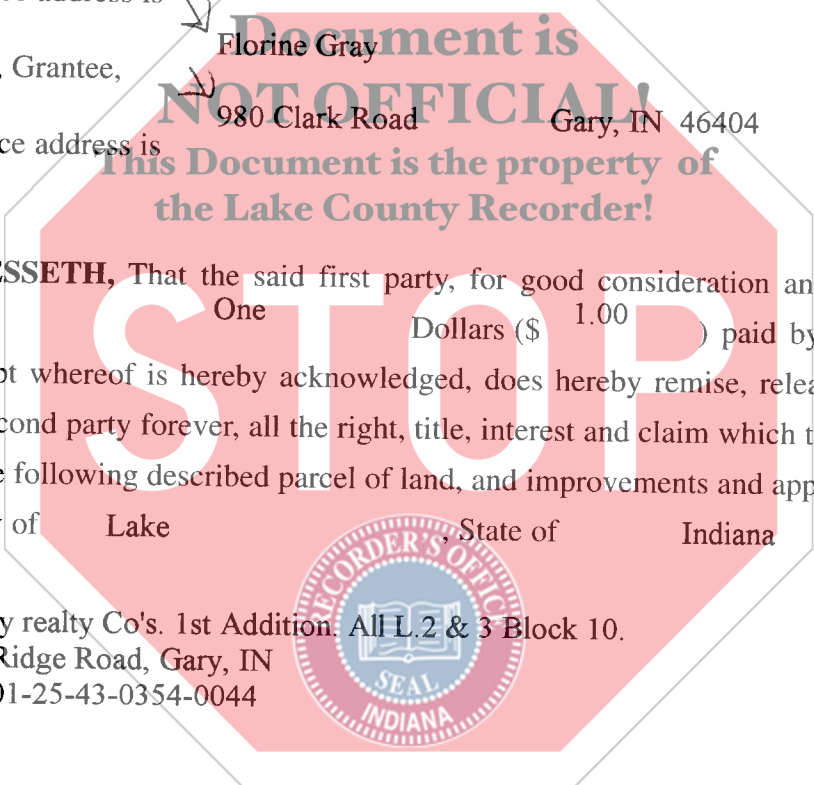

WITNESSETH, That the said first party, for good consideration and for the sum of One Dollars (\$ 1.00) paid by the said second party, the receipt whereof is hereby acknowledged, does hereby remise, release and quitclaim unto the said second party forever, all the right, title, interest and claim which the said first party has in and to the following described parcel of land, and improvements and appurtenances there- to in the County of Lake, State of Indiana to wit:

Great Gary realty Co's. 1st Addition. All L. 2 & 3 Block 10.
933 East Ridge Road, Gary, IN
Parcel #001-25-43-0354-0044

If your state requires 8 1/2" x 11" forms, cut off the bottom of this page at the dotted line.



16.00
M
EAST

002793

IN WITNESS WHEREOF, The said first party has signed and sealed these presents the day and year first above written. Signed, sealed and delivered in presence of:

Signature of Witness

Mable Roddy
Signature of First Party

Print name of Witness

MABLE Roddy
Print name of First Party

Signature of Witness

Mable Roddy
Signature of First Party

Print name of Witness

MABLE Roddy
Print name of First Party

State of INDIANA }

County of LAKE

On NOVEMBER 14, 2000 before me, MABLE Roddy

appeared personally known to me (or proved to me on the basis of satisfactory evidence) to be the person(s) whose name(s) is/are subscribed to the within instrument and acknowledged to me that he/she/they executed the same in his/her/their authorized capacity(ies), and that by his/her/their signature(s) on the instrument the person(s), or the entity upon behalf of which the person(s) acted, executed the instrument.
WITNESS my hand and official seal.

Signature of Notary

Hail James

Affiant Known Produced ID
Type of ID DRIVER'S LICENSE
(Seal)

State of _____ }
County of _____
On _____ before me,
appeared

personally known to me (or proved to me on the basis of satisfactory evidence) to be the person(s) whose name(s) is/are subscribed to the within instrument and acknowledged to me that he/she/they executed the same in his/her/their authorized capacity(ies), and that by his/her/their signature(s) on the instrument the person(s), or the entity upon behalf of which the person(s) acted, executed the instrument.
WITNESS my hand and official seal.

Signature of Notary

Affiant _____ Known _____ Produced ID
Type of ID _____
(Seal)

Signature of Preparer

Print Name of Preparer

Address of Preparer

(2)

If your state requires 8 1/2" x 11" forms, cut off the bottom of this page at the dotted line.