

2

2002 044680

GRANT OF EASEMENT

FILED FOR RECORD
2002 MAY 14 AM 10:12

This Indenture witnesseth that Thomas M. Wachowski and Pamela R. Wachowski (Grantors) being over the age of eighteen years of age, of Lake County, in the State of Indiana, convey and grant to James A. Ison and Janille Scheeringa-Ison (Grantees) of Lake County, in the State of Indiana, for and in consideration of the payment of One Dollar (\$1.00) and other valuable consideration, the receipt and sufficiency of which is hereby acknowledged, an easement for and limited to ingress and egress over an existing driveway over the property more fully described as follows:

LOT NUMBER 2 IN THE RESUBDIVISION OF LOT 3, TOWER OAKS, SECOND SUBDIVISION, AS PER PLAT THEREOF RECORDED IN PLAT BOOK 87, PAGE 79 IN THE OFFICE OF THE RECORDER OF LAKE COUNTY, INDIANA.

More commonly known as 5150 Chase Street, Gary, Indiana 46408.

The easement which is above-described is appurtenant and servient to the real estate constituting the dominant estate, which is described as:

LOT NUMBER 1 IN TOWER OAKS SECOND SUBDIVISION, AS PER PLAT THEREOF, RECORDED IN PLAT BOOK 79, PAGE 55 IN THE OFFICE OF THE RECORDER OF LAKE COUNTY, INDIANA.

More commonly known as 5140 Chase Street, Gary, Indiana 46408.

IN WITNESS WHEREOF, we, the undersigned Grantors have executed this Grant of Easement this 14th day of April, 2002.

Thomas M. Wachowski
Thomas M. Wachowski

Pamela R. Wachowski
Pamela R. Wachowski

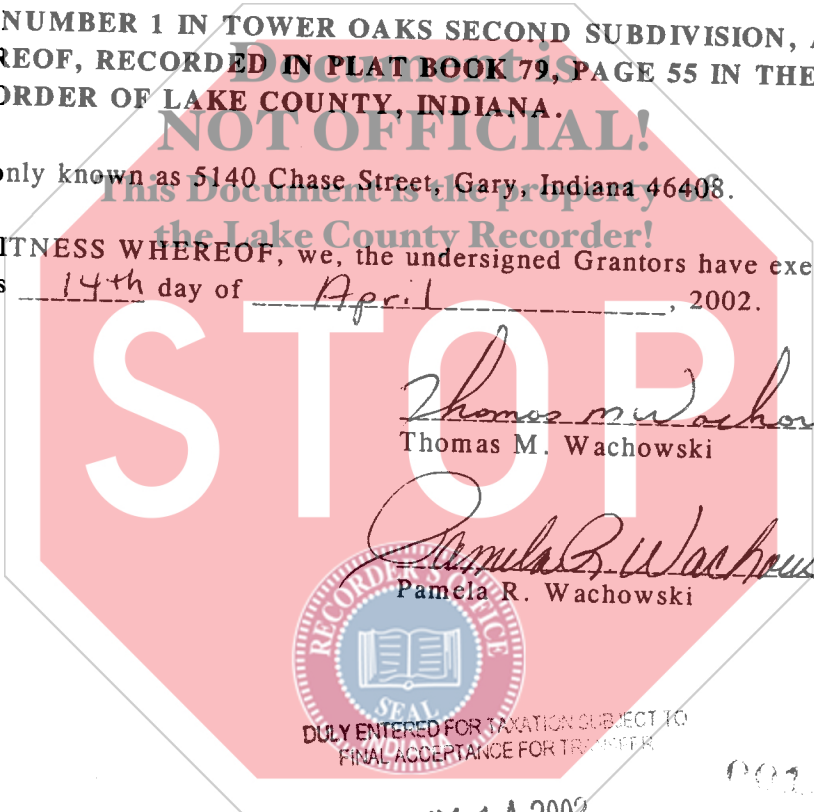

MAY 14 2002

PETER BENJAMIN
LAKE COUNTY AUDITOR

002220

100
100 Ask
ch # 6173
12⁰⁰ 12

STATE OF INDIANA)
) SS: 317-52-8921
COUNTY OF Lake)

Subscribed and sworn to before me, a Notary Public, in said County and State, this
14th day of April, 2002.

William Skof
NOTARY PUBLIC

My Commission Expires:

January 22, 2010

Lake
County of Residence

THIS INSTRUMENT WAS PREPARED BY: MURRAY J. FEIWELL, FEIWELL & HANNOY, P.C., 251 N. Illinois Street, #1700, Indianapolis, Indiana 46204.

**This Document is the property of
the Lake County Recorder!**

Return To:
Contract Processing & Title
Agency, Inc.
6353 Presidential Gateway, Suite 210
Columbus, OH 43231

