

2002 042771

2002 JUN 11 10:26

THIS FORM HAS BEEN PREPARED FOR USE IN THE STATE OF INDIANA BY LAWYERS ONLY. THE SELECTION OF A FORM OF INSTRUMENT, FILLING IN BLANK SPACES, STRIKING OUT PROVISIONS, AND INSERTION OF SPECIAL CLAUSES, MAY CONSTITUTE THE PRACTICE OF LAW WHICH SHOULD ONLY BE DONE BY A LAWYER.

MAIL TAX BILLS TO:

QUITCLAIM DEED

THIS INDENTURE WITNESSETH, that SHIRLEY M. BARBEAU

GRANTOR(S) of Cook

County in the State of Illinois

QUITCLAIM(S) to JAMES STUART SHANNON ←

GRANTEE(S) of Lake

County in the State of Indiana

in consideration of One Dollar (\$1.00) and other valuable consideration, the receipt and sufficiency of which are hereby acknowledged, the following described real estate in Lake County, in the State of Indiana:

Hollywood of Hammond, the North 8 feet of Lot 27 and the South 24 feet of Lot 28, in Block 3, in the Town of Munster, as per plat thereof, recorded in Plat Book 19, page 21, in the Office of the Recorder of Lake County, Indiana.

Commonly known as: 7634 Manor, Munster, Indiana. ←

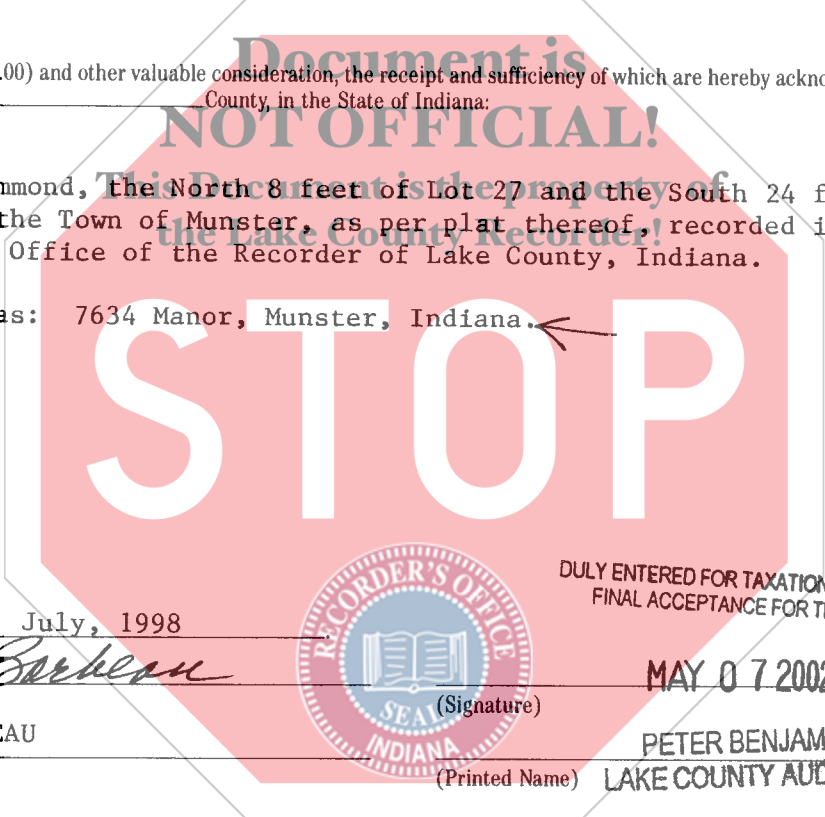

Dated this 21ST day of July, 1998

Shirley Barbeau
(Signature)
SHIRLEY M. BARBEAU

(Printed Name)

(Signature)

(Printed Name)



DULY ENTERED FOR TAXATION SUBJECT TO FINAL ACCEPTANCE FOR TRANSFER

MAY 07 2002

(Signature)

(Printed Name)

PETER BENJAMIN
LAKE COUNTY AUDITOR

(Signature)

(Printed Name)

STATE OF INDIANA, COUNTY OF LAKE SS:

Before me, the undersigned, a Notary Public in and for said County and State, this 21st day of July 1998, personally appeared:

and acknowledged the execution of the foregoing deed. In witness whereof, I have hereunto subscribed my name and affixed my official seal.

My commission expires: 2/12/01

Signature *Susan Miller*

Resident of LAKE County

Printed SUSAN MILLER, Notary Public

This instrument prepared by Lowell E. Enslin, Attorney at Law, Attorney No. 6721-45

142 Rimbach
Hammond, IN 46320
(219) 931-1700

MAIL TO:

© COPYRIGHT, THE ALLEN COUNTY INDIANA BAR ASSOCIATION, INC. (REV. 2/97)

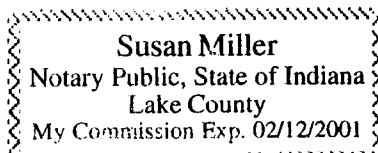

000589

BD.
14.00
cash