

Send tax bill to 2002 042755  
9025 Park Valley Court  
Hobart, Indiana 46342

2002 APR 7 12:35  
File No: 200202845

### WARRANTY DEED

**This Indenture Witnesseth**, That **Steve Kljajich and Juanita Kljajich, husband and wife**, (Grantor) of Lake County, in the State of Indiana,

**Conveys and Warrants to**

**Dimce Ivanoski**, (Grantee) of Lake County, in the State of Indiana,



for the sum of Ten & 00/100 Dollars (\$10.00) and other valuable consideration, the receipt and sufficiency of which is hereby acknowledged, the following described real estate in Lake County, in the State of Indiana:

**SEE ATTACHED EXHIBIT A FOR COMPLETE LEGAL DESCRIPTION MADE A PART HEREOF.**

Parcel No. 08-15-0651-0037

**Subject To** any and all easements, agreements, and restrictions of record. The address of such real estate is commonly known as: 9025 Park Valley Court  
Hobart, IN 46342

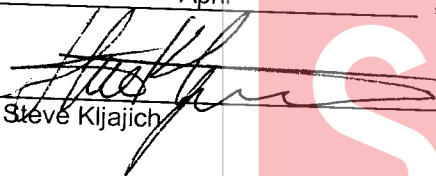
**In Witness Whereof**, Grantors have executed this deed this \_\_\_\_\_ 29th \_\_\_\_\_ day of April, 2002

 (Seal)  (Seal)  
Steve Kljajich Juanita Kljajich  
\_\_\_\_\_  
(Seal) \_\_\_\_\_ (Seal)

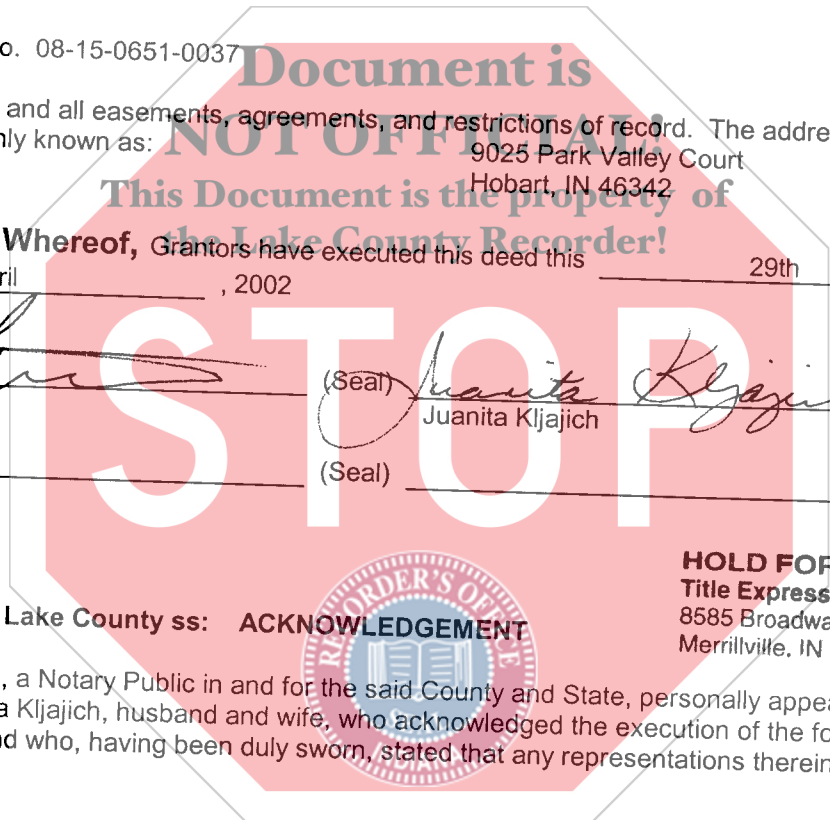

State of Indiana, Lake County ss: **ACKNOWLEDGEMENT**

**HOLD FOR**  
**Title Express, Inc.**  
8585 Broadway • Ste. 680  
Merrillville, IN 46410

Before me, a Notary Public in and for the said County and State, personally appeared Steve Kljajich and Juanita Kljajich, husband and wife, who acknowledged the execution of the foregoing Warranty Deed, and who, having been duly sworn, stated that any representations therein contained are true.

Witness my hand and notarial seal this \_\_\_\_\_ 29th \_\_\_\_\_ day of \_\_\_\_\_ April \_\_\_\_\_, 2002

My Commission Expires:  
6/13/2008

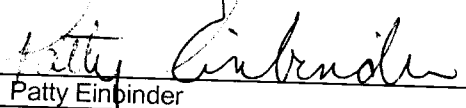
  
Patty Einbinder \_\_\_\_\_, Notary Public  
Residing in \_\_\_\_\_ Porter \_\_\_\_\_ County, Indiana

This instrument prepared by: Timothy L. Claxton, Attorney at Law.  
Attorney Identification No. 14523-02  
**Return to:**

TE Rep.  
Merrillville

**HOLD FOR**  
**Title Express, Inc.**  
8585 Broadway • Ste. 680  
Merrillville, IN 46410



PATTY EINBINDER  
Res. of Porter Co.  
Comm. Exp. 6-13-08

DULY ENTERED FOR TAXATION SUBJECT TO  
FINAL ACCEPTANCE FOR TRANSFER

MAY 07 2002

PETER BENJAMIN  
LAKE COUNTY AUDITOR

000571

CK# 2684  
1500  
M