

2002 042527

2002 MAY 7 10:13

THIS FORM HAS BEEN PREPARED FOR USE IN THE STATE OF INDIANA BY LAWYERS ONLY. THE SELECTION OF A FORM OF INSTRUMENT, FILLING IN BLANK SPACES, STRIKING OUT PROVISIONS, AND INSERTION OF SPECIAL CLAUSES, MAY CONSTITUTE THE PRACTICE OF LAW WHICH SHOULD ONLY BE DONE BY A LAWYER.

MAIL TAX BILLS TO:

# QUIT-CLAIM DEED

THIS INDENTURE WITNESSETH, **KIRK L. WILLIAMS,**

GRANTOR(S) of Lake County in the State of Indiana

QUITCLAIM(S) to WING POINTE HOLDINGS, LLC

GRANTOR(S) of HENRY County in the State of Georgia

in consideration of One Dollar (\$1.00) and other valuable consideration, the receipt and sufficiency of which are hereby acknowledged, the following described real estate in Lake County, in the State of Indiana: 10046 Polk Court, Crown Point, IN 46307

Lot 7 in Indian Ridge Addition, Unit 3, Block 4, in the City of Crown Point, as per plat thereof, recorded in Plat Book 67 Page 10, and amended by corrected plat recorded in Plat Book 68, Page 56, in the Office of the Recorder of Lake County, Indiana.

Subject to all real estate taxes payable.

Subject to any and all easements, agreements and restrictions of record.

Dated this 7<sup>TH</sup> day of May, 2002.

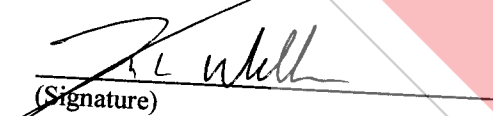
  
(Signature)

KIRK L. WILLIAMS  
(Printed Name)

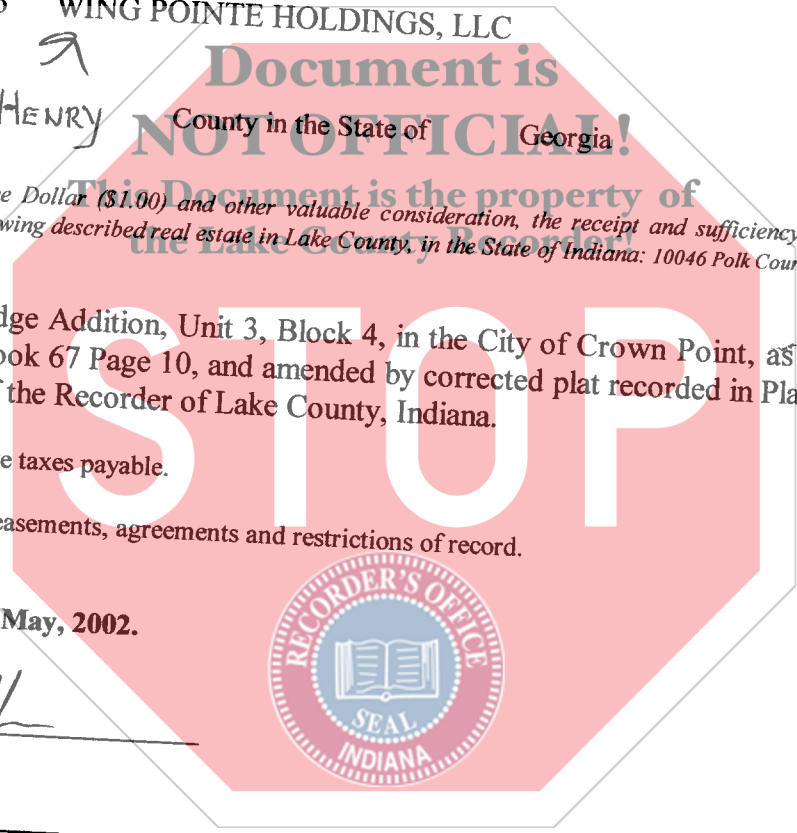

## STATE OF INDIANA, COUNTY OF PORTER

SS:

Before me, the undersigned, a Notary Public in and for said County and State, this 7<sup>TH</sup> day of May, 2002, personally appeared: KIRK L. WILLIAMS, and acknowledged the execution of the foregoing deed. In witness whereof, I have hereunto subscribed my name and affixed my official seal.

My commission expires: 1-25-08

Resident of Porter County Porter

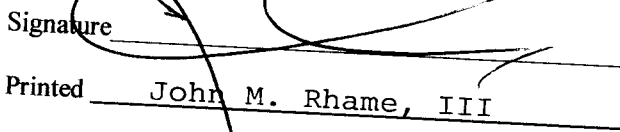
Signature   
Printed John M. Rhame, III

This instrument prepared by: John M. Rhame, III, 2684 Willowcreek Road, Portage, Indiana, 46368, Attorney at Law.  
762-0494

DULY ENTERED FOR TAXATION SUBJECT TO FINAL ACCEPTANCE FOR TRANSFER

MAY 07 2002

PETER BENJAMIN  
LAKE COUNTY AUDITOR

P.O. Box 1438 McDonough GA. 30253 ←

006532

1400  
SS  
CS