

2

WHEN RECORDED RETURN TO:

Towne Mortgage Company  
13325 E. Fourteen Mile  
Sterling Heights, MI 48312

CERTIFIED as a true and exact  
copy of this original document.  
Community Title Co.

2002 041436

By *[Signature]*

APR 1 2002 10:43

Loan No.: 244145

This form was prepared by: Towne Mortgage Company  
address: 13325 E. Fourteen Mile, Sterling Heights, MI 48312  
tel. no: 586-979-2100

### ASSIGNMENT OF MORTGAGE

For Value Received, the undersigned holder of a Mortgage (herein "Assignor") whose address is 151 Joliet Street, Dyer, IN 46311

, does hereby grant, sell, assign, transfer and convey, unto the Towne Mortgage Company, a Michigan corporation

, a corporation (herein "Assignee"), organized and existing under the laws of Michigan whose address is 13325 East Fourteen Mile, Sterling Heights, MI 48312 a certain Mortgage, dated April 26, 2002, made and executed by Adeline Castillo, A Married Woman

to and in favor of First United Mortgage, an Indiana corporation upon the following described property situated in Lake County, State of Indiana : PARCEL # 15-332-52

Lot 128 in Turkey Creek Meadows, Unit No.2, as per Plat thereof, recorded November 4, 1959 in Plat Book 33 Page 73, in the Office of the Recorder of Lake County, Indiana. Commonly known as: 6801 Harrison St., Merrillville, In.

Mtg # 2002-041435

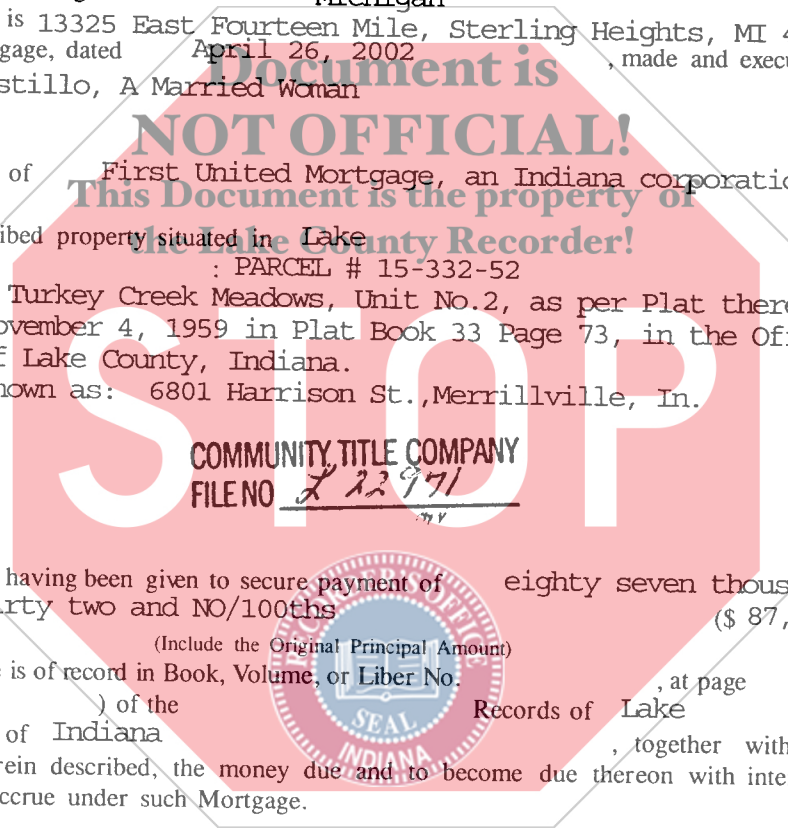

such Mortgage having been given to secure payment of eighty seven thousand one hundred thirty two and NO/100ths (\$ 87,132.00 ) (Include the Original Principal Amount) which Mortgage is of record in Book, Volume, or Liber No. , at page (or as No. ) of the Records of Lake County, State of Indiana , together with the note(s) and obligations therein described, the money due and to become due thereon with interest, and all rights accrued or to accrue under such Mortgage.

*Cm 1200 op*

TO HAVE AND TO HOLD the same unto Assignee, its successor and assigns, forever, subject only to the terms and conditions of the above-described Mortgage.

IN WITNESS WHEREOF, the undersigned Assignor has executed this Assignment of Mortgage on April 26, 2002

Tiffany Hunt  
Witness Tiffany Hunt

First United Mortgage, an Indiana corporation  
\_\_\_\_\_  
(Assignor)

Pamela Terry  
Witness Pamela Terry

By: Mary Seibel  
Mary Seibel  
Closing Supervisor

Attest \_\_\_\_\_

By: \_\_\_\_\_

[Space Below is Reserved for Acknowledgement Information ]

STATE OF MICHIGAN Macomb County ss:

On this 26th day of April, 2002 before me, the undersigned, a Notary Public in and for said County, personally appeared Mary Seibel

and acknowledged the execution of the foregoing instrument.  
WITNESS my hand and official seal.

My Commission Expires:

Rony J. Burt  
Notary Public  
Resident of \_\_\_\_\_ County

RONY J. BURT  
NOTARY PUBLIC MACOMB CO., MI  
MY COMMISSION EXPIRES Aug 22, 2005

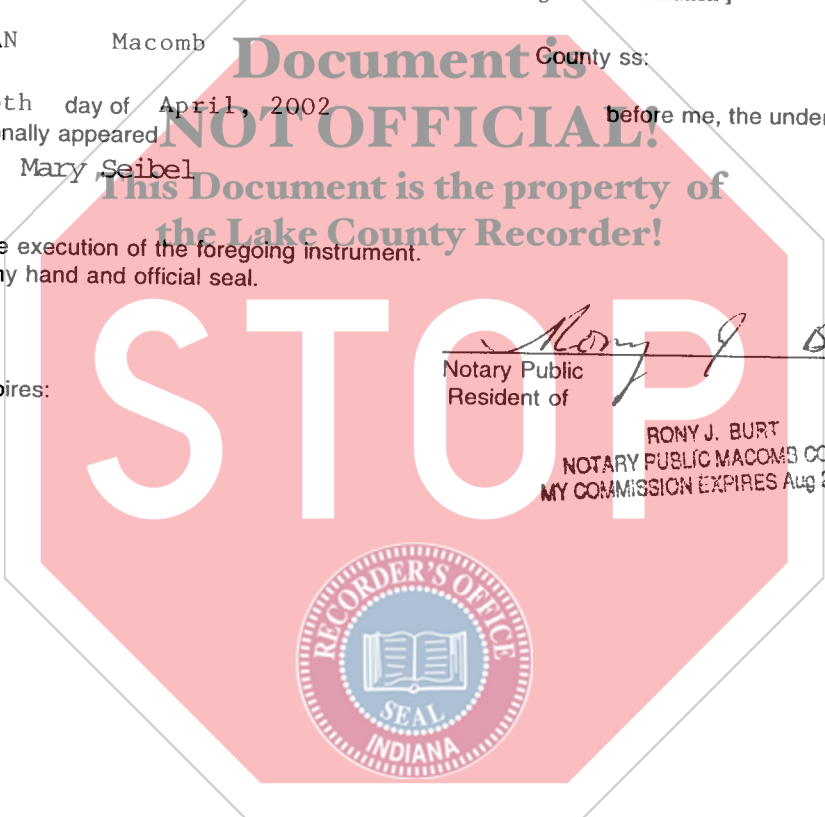

2