

2002 041322

2002 APR 26 9:58

H62-2278340

Tax Key No.: 12-14-65-7

Mail tax bills to:

2446 Lakewood Dr  
Dyer In

WARRANTY DEED

This indenture witnesseth that PATRICIA MARKHAM

Lake County in the State of Indiana  
E. ANN

Convey and warrant to DAVID VORWALD and LORI VORWALD,  
Husband and Wife

of Lake County in the State of Indiana

for and in consideration of Ten Dollars and other valuable consideration the receipt whereof is hereby acknowledged, the following Real Estate in Lake County in the State of Indiana, to wit:

Lot 7, in Plum Creek Annex in the Town of Dyer, as per plat thereof, recorded in Plat Book 29, page 23, in the Office of the Recorder of Lake County, Indiana

- This conveyance is made subject to:
1. Real Estate taxes for the year 2001 payable in 2002 and subsequent years.
  2. All applicable subdivision, building and zoning laws of the governmental bodies having jurisdiction of the above described realty.
  3. The terms, covenants, easements, limitations and restrictions contained in any instrument of record affecting the use and occupancy of said real estate.

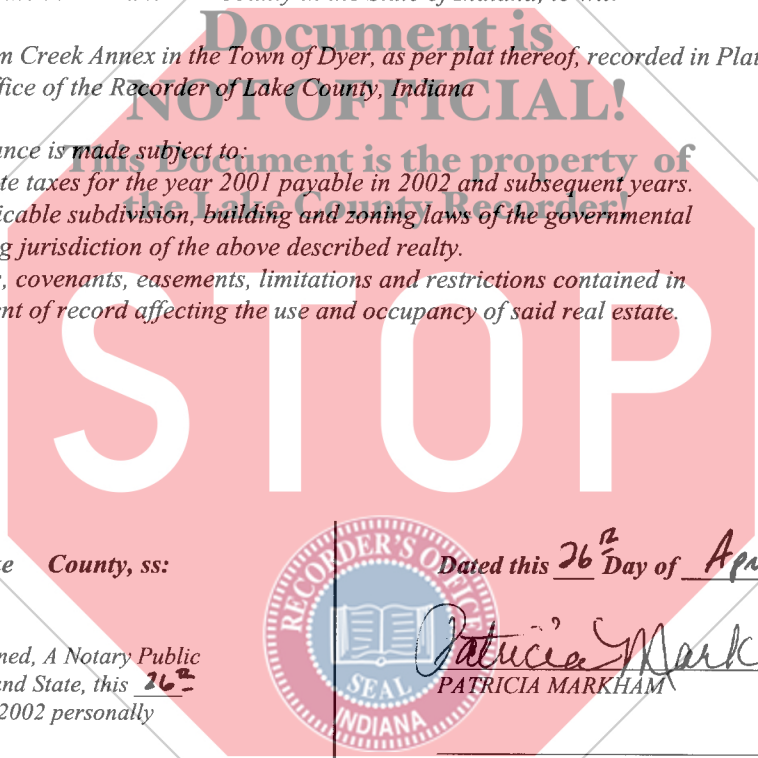

State of Indiana, Lake County, ss: Dated this 26<sup>th</sup> Day of April, 2002.

Before me, the undersigned, A Notary Public in and for said County and State, this 26<sup>th</sup> April, 2002 personally appeared:



*Patricia Markham*  
PATRICIA MARKHAM

PATRICIA MARKHAM

And acknowledged the execution of the foregoing deed. In witness whereof, I have hereunto subscribed my name and affixed my official seal. My commission expires:

2002.  
*Katherine E. Adams*  
Notary Public

KATHERINE E. ADAMS  
Notary Public, State of Indiana  
County of Lake  
My Commission Expires ~~Dec 31 2002~~ **DULY ENTERED FOR TAXATION SUBJECT TO FINAL ACCEPTANCE FOR TRANSFER**

Resident of LAKE County.

This instrument prepared by Thomas C. O'Donnell, Attorney at Law  
9729 Prairie Avenue, Highland, Indiana 46322 (219) 922-1010

MAY 01 2002  
PETER BENJAMIN  
LAKE COUNTY AUDITOR

000053

14.00 JP  
CT

Chicago Title Insurance Company