

2

LF298-04

2002 040560

2002 MAR -1 AM 8:45

RECORDER

QUITCLAIM DEED

THIS QUITCLAIM DEED, executed this 12 day of MARCH, 2002 (year),

by first party, Grantor, ANNA L. HITTLE

whose post office address is 3314 MIDDLE ROAD
DAVENPORT, IA 52803

to second party, Grantee, DENNIS M. HITTLE

whose post office address is 3314 MIDDLE ROAD
DAVENPORT, IA 52803

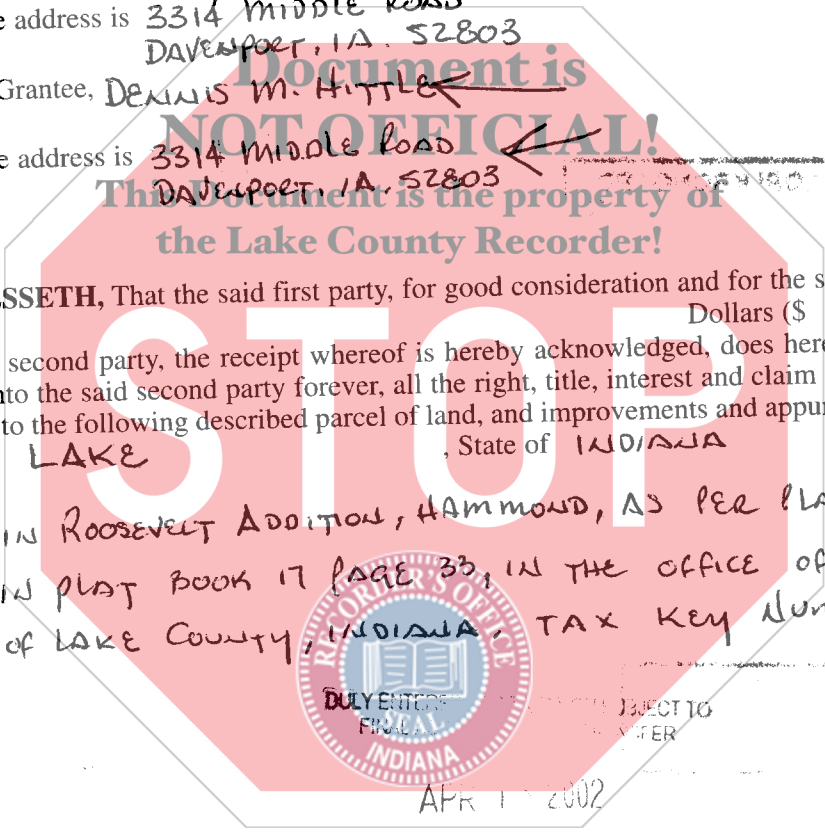

WITNESSETH, That the said first party, for good consideration and for the sum of ONE Dollars (\$ 1.00) paid by the said second party, the receipt whereof is hereby acknowledged, does hereby remise, release and quitclaim unto the said second party forever, all the right, title, interest and claim which the said first party has in and to the following described parcel of land, and improvements and appurtenances thereto in the County of LAKE, State of INDIANA to wit:

LOT "H" IN ROOSEVELT ADDITION, HAMMOND, AS PER PLAT THEREOF, RECORDED IN PLAT BOOK 17 PAGE 33, IN THE OFFICE OF THE RECORDER OF LAKE COUNTY, INDIANA, TAX KEY NUMBER 35-331.8.

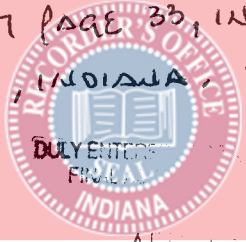

001070

16-
cm

911922846

IN WITNESS WHEREOF, The said first party has signed and sealed these presents the day and year first above written. Signed, sealed and delivered in presence of:

Constance Hittle
Signature of Witness

CONSTANCE HITTLE
Print name of Witness

Tara Hanson
Signature of Witness

TARA HANSON
Print name of Witness

Anna L. Hittle
Signature of First Party

ANNA L. HITTLE
Print name of First Party

Anna Hittle
Signature of First Party

ANNA L. HITTLE
Print name of First Party

State of Iowa
County of Scott

On March 13, 2002 before me, Anna L. Hittle
appeared

personally known to me (or proved to me on the basis of satisfactory evidence) to be the person(s) whose name(s) is/are subscribed to the within instrument and acknowledged to me that he/she/they executed the same in his/her/their authorized capacity(ies), and that by his/her/their signature(s) on the instrument the person(s), or the entity upon behalf of which the person(s) acted, executed the instrument. WITNESS my hand and official seal.

Lori Krongard
Signature of Notary



Affiant _____ Known _____ Produced ID _____

Type of ID _____ (Seal)

State of Iowa
County of Scott

On March 13, 2002 before me, Anna L. Hittle
appeared

personally known to me (or proved to me on the basis of satisfactory evidence) to be the person(s) whose name(s) is/are subscribed to the within instrument and acknowledged to me that he/she/they executed the same in his/her/their authorized capacity(ies), and that by his/her/their signature(s) on the instrument the person(s), or the entity upon behalf of which the person(s) acted, executed the instrument. WITNESS my hand and official seal.

Lori Krongard
Signature of Notary



Affiant _____ Known _____ Produced ID _____

Type of ID _____ (Seal)

Dennis M. Hittle
Signature of Preparer

DENNIS M. HITTLE
Print Name of Preparer

3314 Middle Road
Address of Preparer

DAVENPORT, IA - 52803