

FILED

2002 018411

2002 FEB 21 AM 9:33

DIANE E. SARTOR
RECORDER

H620017813

McCaughan Loan No: 69037 P/O: DEC/2001
Prepared by and return to:
McCaughan Mortgage Company, Inc.
PO Box 141429
Coral Gables, Florida 33114-9973
Diane E. Sartor
PIN No: 162703040008

DISCHARGE OF MORTGAGE FOR CORPORATIONS

KNOW ALL MEN BY THESE PRESENTS, That a certain Indenture of Mortgage, bearing the date February 26, 1992 made and executed Michael J. Klocek, a single person of the first part, to Suburban Mortgage Company, Inc., an Indiana Corporation, of the second part, and recorded in the Office of the Register of Deeds for the County of LAKE COUNTY, State of INDIANA in Liber/Volume N/A of LAKE COUNTY RECORDS Page N/A Document No. 92-012024.

Property Address: 3345 Grand Blvd., Highland, IN. 46322

Lot 8, Block 17, HOMESTEAD GARDENS Master Addition, Blocks 16 and 17, in the Town of Highland, as shown in Plat Book 33, Page 35, in Lake County, Indiana.

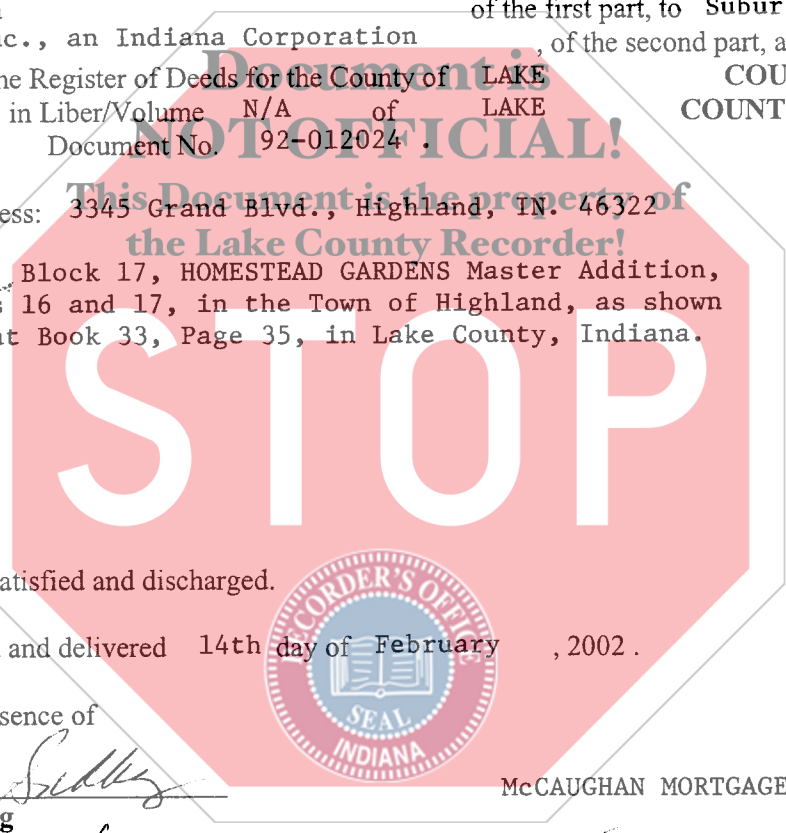

Is fully paid, satisfied and discharged.

Signed, sealed and delivered 14th day of February, 2002.

In Presence of
Vivien Sabbag
Vivien Sabbag

McCAUGHAN MORTGAGE COMPANY, INC.

Ana De La Torre
Ana De La Torre

Patricia E. Davis
Patricia E. Davis, Vice President
Judy Henry
Judy Henry, Assistant Secretary

STATE OF FLORIDA
COUNTY OF DADE

On this February 14, 2002 before me, the subscriber, a Notary Public in and for said county, personally appeared Patricia E. Davis and Judy Henry, to me personally known, who being by me duly sworn, did say that they are respectively, the Vice President and Assistant Secretary of McCaughan Mortgage Company, Inc., A Florida Corporation, and that said instrument was signed on behalf of said corporation, by authority of its Board of Directors, and Vice President and Assistant Secretary acknowledged said instrument to be the free act and deed of said corporation.

NOTARY

Diane E. Sartor

OFFICIAL NOTARY SEAL
DIANE E SARTOR
NOTARY PUBLIC STATE OF FLORIDA
COMMISSION NO. CC1000811
MY COMMISSION EXP. MAR. 2, 2005

Chicago Title Insurance Company

10-
D.E.
CC #
60172