

STATE OF INDIANA
LAKE COUNTY
FILED FOR RECORD

2002 015493

2002 FEB 13 AM 8:42

MORRIS W. CARTER
RECORDER

ASSIGNMENT OF REAL ESTATE MORTGAGE

KNOW ALL MEN BY THESE PRESENTS: THAT SMH FCU, 131 RIDGE ROAD, MUNSTER, IN. 46321, A CREDIT UNION ORGANIZED AND EXISTING UNDER AND BY VIRTUE OF THE LAWS OF STATE OF INDIANA AND HAVING ITS OFFICE AND PRINCIPAL PLACE OF BUSINESS IN THE CITY OF MUNSTER AND STATE OF INDIANA, PARTY OF THE FIRST PART, FOR VALUE RECEIVED, HAS GRANTED, BARGAINED, SOLD, ASSIGNED, TRANSFERRED AND SET OVER AND BY THESE PRESENTS DOES GRANT, BARGAIN, SELL, ASSIGN, TRANSFER AND SET OVER UNTO:

CU MORTGAGE SERVICE

PARTY OF THE SECOND PART, ITS SUCCESSORS AND ASSIGNS, A CERTAIN INDENTURE OF MORTGAGE DATED THE 28th DAY OF April A.D. 2001 MADE BY
KENNETH C SMITH and LUCRETIA A SMITH, HUSBAND AND WIFE

TO IT, SECURING THE PAYMENT OF ONE PROMISSORY NOTE THEREIN DESCRIBED FOR THE SUM OF One Hundred Eighteen Thousand Six Hundred and no/100 DOLLARS (\$ 118600.00) AND ALL ITS RIGHTS, TITLE AND INTEREST IN AND TO THE PREMISES SITUATED IN THE COUNTY OF LAKE, STATE OF INDIANA, AND DESCRIBED IN SAID MORTGAGE AS FOLLOWS, TOWIT:

LOT 128 IN SOUTHWOOD ESTATES 4TH ADDITION TO THE TOWN OF GRIFFITH, AS PER PLAT THEREOF, RECORDED IN PLAT BOOK 52 PAGE 24, IN THE OFFICE OF THE RECORDER OF LAKE COUNTY, INDIANA.

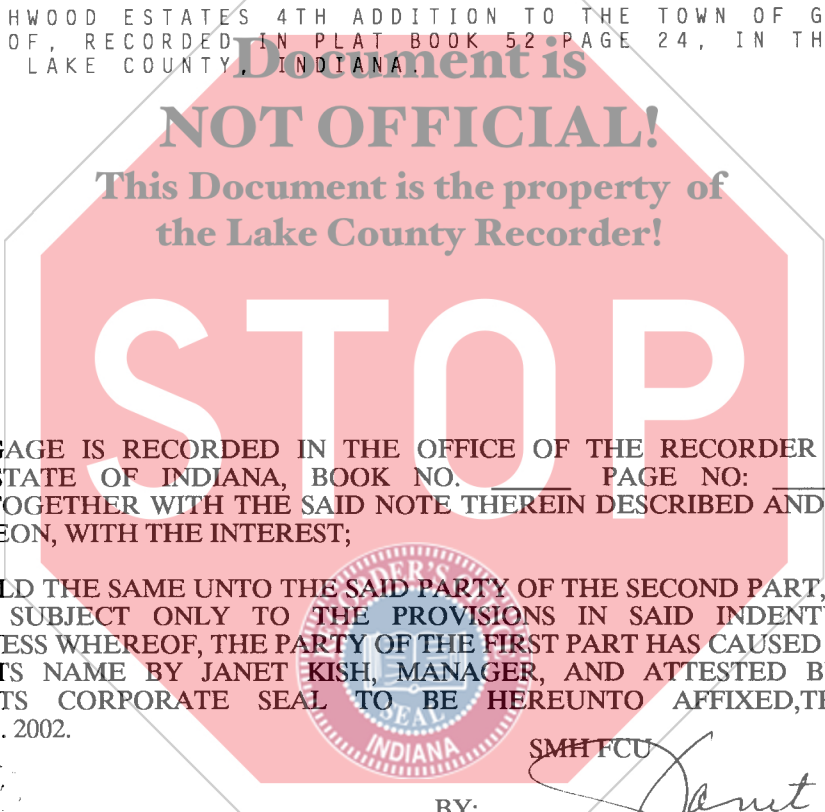

WHICH SAID MORTGAGE IS RECORDED IN THE OFFICE OF THE RECORDER OF LAKE COUNTY, IN THE STATE OF INDIANA, BOOK NO. PAGE NO: DOCUMENT NO. 2001 033157 TOGETHER WITH THE SAID NOTE THEREIN DESCRIBED AND THE MONEY DUE OR TO GROW DUE THEREON, WITH THE INTEREST;

TO HAVE AND TO HOLD THE SAME UNTO THE SAID PARTY OF THE SECOND PART, ITS SUCCESSORS AND ASSIGNS, FOREVER; SUBJECT ONLY TO THE PROVISIONS IN SAID INDENTURE OF MORTGAGE CONTAINED. IN WITNESS WHEREOF, THE PARTY OF THE FIRST PART HAS CAUSED THIS INSTRUMENT TO BE EXECUTED IN ITS NAME BY JANET KISH, MANAGER, AND ATTESTED BY SHERRY L TRAPP, PROCESSOR AND ITS CORPORATE SEAL TO BE HEREUNTO AFFIXED, THIS 31st DAY OF January A.D. 2002.

SMH FCU

BY:

Janet Kish
JANET KISH

STATE OF INDIANA)
) SS:
COUNTY OF LAKE)

ATTEST:

Sherry L. Trapp
SHERRY L TRAPP

BEFORE ME THE UNDERSIGNED, A NOTARY PUBLIC IN AND FOR THE COUNTY AND STATE AFORESAID, THIS 31st DAY OF January, 2002, PERSONALLY APPEARED JANET KISH, MANAGER AND SHERRY L. TRAPP RESPECTIVELY, AND ACKNOWLEDGED THE EXECUTION OF THE FOREGOING INSTRUMENT.

MY COMMISSION EXPIRES 4/12/07
COUNTY OF RESIDENCE: LAKE

Shirley L Haney
NOTARY PUBLIC
SHIRLEY L HANEY

THIS INSTRUMENT PREPARED BY: LINDA MENDEZ
RETURN TO: CU MORTGAGE SERVICE
1583 E. 85TH AVE.
MERRILLVILLE, IN. 46410

7

10. TR
21058