

2

2002 011964

2002

11:00

AVE.
R

After Recording Return To:

PEELLE MANAGEMENT CORPORATION
ASSIGNMENT JOB #90603
P.O. BOX 1710
CAMPBELL, CA 95009-1710
1-408-866-6868

WAUWATOSA, WI 53226



Order No.
Escrow No.
Application No.
Loan No. 5408

5099516 4540

SPACE ABOVE THIS LINE FOR RECORDER'S USE

Corporation Assignment of Mortgage

FOR VALUE RECEIVED, BWM MORTGAGE, LLC

13-089

Document is NOT OFFICIAL!

having its principal place of business at 10425 W NORTH AVE #246, WAUWATOSA, WISCONSIN 53226 ("Assignor"),

hereby grants, assigns and transfers to **BANKERS TRUST COMPANY AS TRUSTEE**
8 Park Plaza, Sixteenth Floor, Irvine, California 92714

all of Assignor's rights, title and interest in, to, and under that certain Mortgage dated JUNE 15, 2001 executed and delivered by GEORGE W BETZ AND NENITA A BETZ, HUSBAND AND WIFE ("Assignee")

and recorded either
 concurrently herewith; or
 as Instrument No. 2001048953 on 6/22/01 [redacted] [redacted]
of Official Records in the County Recorder's office of LAKE [redacted] - IN [redacted] County,
covering certain real estate and other property described therein, more particularly described as follows:
SITUATED IN LAKE COUNTY, INDIANA, TO-WIT: LOT 100 SUBJECT TO RIGHT A WAY, IN ROBERT BARTLETT'S EAST GARY SMALL FARMS

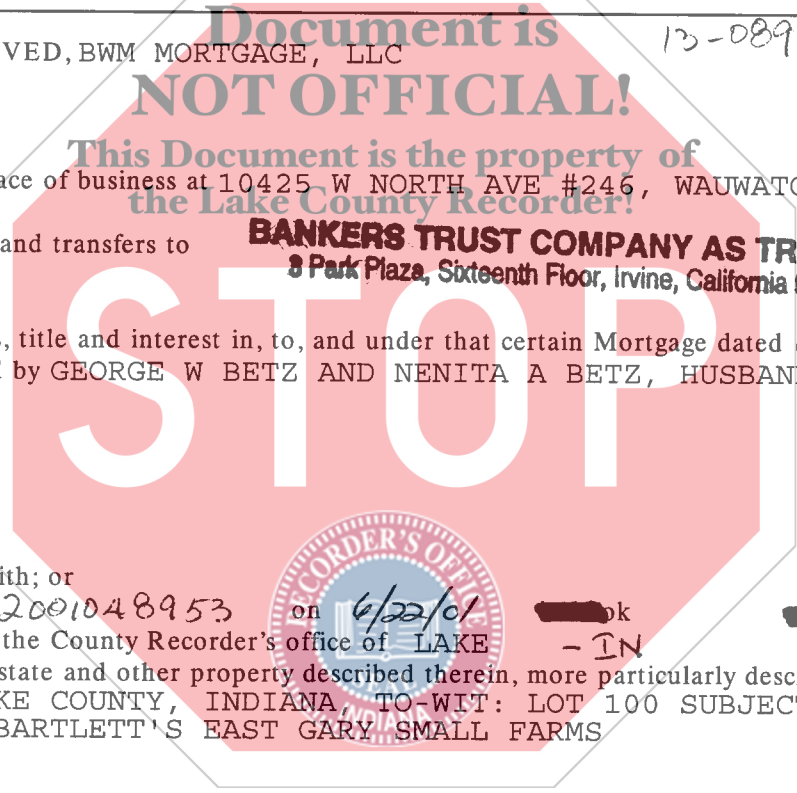

TOGETHER with the note or notes therein described or referred to therein and secured thereby, the money due and to become due thereon with interest, and all rights accrued or to accrue under said Mortgage.

IN WITNESS WHEREOF, Assignor has caused this Corporation Assignment of Mortgage to be executed by its duly authorized officer as of the day and year first written below.

12-
H.H.
920998



DATE JUNE 15, 2001
STATE OF ~~INDIANA~~ Wisconsin
COUNTY OF MILWAUKEE

On JUNE 20, 2001 before
me, Cheryl L. Torres Notary Public, personally
appeared JAMES W. LARSON, PRESIDENT

_____ personally known to me (or proved
to me on the basis of satisfactory evidence) to be the person(s)
whose name(s) is/are subscribed to the within instrument and
acknowledged to me that he/she/they executed the same in
his/her/their authorized capacity(ies), and that by his/her/their
signature(s) on the instrument the person(s), or the entity upon
behalf of which the person(s), acted, executed the instrument.

WITNESS my hand and official seal.

Signature

Cheryl L. Torres
My commission expires
8/29/2004

(Seal)

BWM MORTGAGE, LLC A WISCONSIN
CORPORATION

[Signature]
JAMES W. LARSON
PRESIDENT

NOTARY PUBLIC
CHERYL L. TORRES

(This area for official notarial seal)

This instrument prepared by:
KATHLEEN M. FISCHER
10425 W NORTH AVE #246
WAUWATOSA, WISCONSIN, 53226

