

①

Hold For: 2002 003751
Stewart Title Services
of Northwest Indiana
8695 Broadway
Merrillville, IN 46410

#014501265

Lake County

WARRANTY DEED

Case No: 014501265

Parcel No: Unit 24 Key#30-0210-0055
and 30-0210-56

This Indenture Witnesseth, That Adelina V. Romo

(Grantor) of Lake County, in the State of Indiana, *Conveys and Warrants* to
Javier H. Flores

(Grantee) of Lake County, in the State of Indiana, for the sum of Ten & 00/100
Dollars (\$10.00) and other valuable consideration, the receipt and sufficiency of which is hereby
acknowledged, the following described real estate in Lake County, in the State of
Indiana:

All of Lot 55 and the North One-Half (1/2) of Lot 54, Block 18,
Calumet Addition to East Chicago, as per plat thereof, Recorded
in Plat Book 8 page 32, in the Office of the Recorder of Lake
County, Indiana.

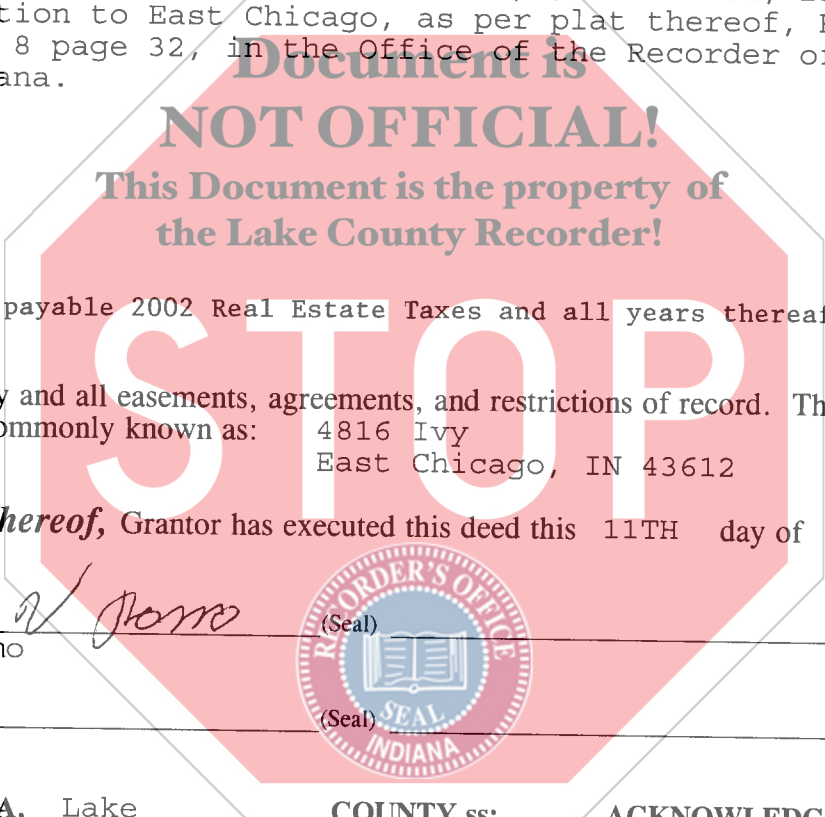

Subject to 2001 payable 2002 Real Estate Taxes and all years thereafter.

Subject To any and all easements, agreements, and restrictions of record. The address of
such real estate is commonly known as: 4816 Ivy
East Chicago, IN 43612

In Witness Whereof, Grantor has executed this deed this 11TH day of JANUARY
2002 .

Adelina V. Romo
Adelina V. Romo



(Seal)
(Seal)

STATE OF INDIANA, Lake COUNTY ss: ACKNOWLEDGEMENT

Before me, a Notary Public in and for the said County and State, personally appeared
Adelina V. Romo

who acknowledged the execution of the foregoing Warranty Deed, and who, having been duly
sworn, stated that any representations therein contained are true.

Witness my hand and notarial seal this 11th day of January 2002 .

My commission expires:
10/17/06

Signature *Linda S. Wood*
Linda S. Wood, Notary Public
Residing in Lake County, Indiana

THIS INSTRUMENT PREPARED BY: Jacob M. Yonkman, Attorney at Law 1432-45

Information from: Stewart Title Services
Send tax bills to:

LINDA S. WOOD
NOTARY PUBLIC, Lake County, Indiana
My Commission Expires October 17, 2006
Resident of Lake County, Indiana

JAN 18 2002
014501265

001232 / # 4223

14.02 AC