

2002 006254

2002 JAN 17 AM 10:46

WARRANTY DEED

RECORDER

THIS INDENTURE WITNESSETH, That RONALD SEDGWICK, GRANTOR(S) of LAKE County in the State of INDIANA, CONVEYS AND WARRANTS to ROBERT A. LEWIS AND CHARLENE LEWIS, HUSBAND AND WIFE, of LAKE County in the State of INDIANA as GRANTEE(S) in consideration of One Dollar (\$1.00) and other valuable consideration, the receipt and sufficiency of which are hereby acknowledged, the following described real estate in LAKE County, in the State of Indiana:

PARCEL 1:

THAT PART OF THE NORTHEAST 1/4 OF SECTION 33, TOWNSHIP 32 NORTH, RANGE 8 WEST OF THE SECOND PRINCIPAL MERIDIAN, MORE PARTICULARLY DESCRIBED AS FOLLOWS:

(LEGAL DESCRIPTION CONTINUED ON REVERSE SIDE HEREOF)

COMMONLY KNOWN AS: 403 240TH AVENUE WEST, SHELBY, IN 46377

UNIT NO. 2 KEY NO. 3-27-20

SUBJECT TO SPECIAL ASSESSMENTS, ACCRUED BUT NOT YET DUE 2001 TAXES PAYABLE 2002, 2002 TAXES PAYABLE 2003 AND ALL REAL ESTATE TAXES DUE AND PAYABLE HEREAFTER.

SUBJECT TO EASEMENTS, RESTRICTIONS AND COVENANTS OF RECORD, IF ANY.

Dated this 2nd day of JANUARY, 2002.

Ronald Sedgwick
RONALD SEDGWICK

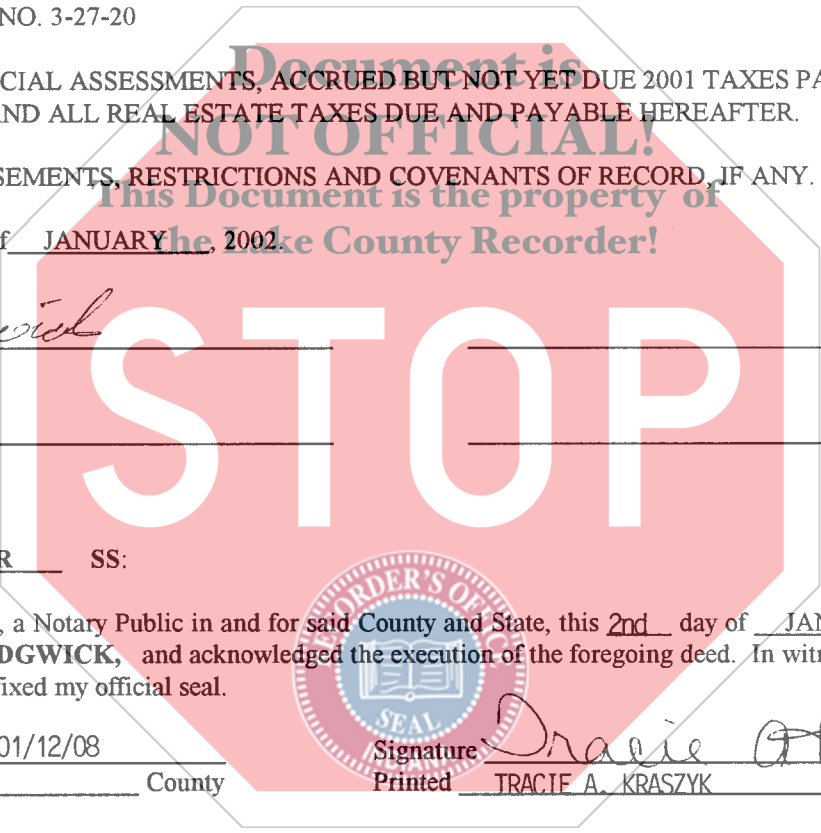

STATE OF INDIANA
COUNTY OF PORTER SS:

Before me, the undersigned, a Notary Public in and for said County and State, this 2nd day of JANUARY, 2002, personally appeared: RONALD SEDGWICK, and acknowledged the execution of the foregoing deed. In witness whereof, I have hereunto subscribed my name and affixed my official seal.

My commission expires: 01/12/08
Resident of PORTER County

Signature Tracie A. Kraszyk
Printed TRACIE A. KRASYK Notary Public

STATE OF
COUNTY OF SS:

Before me, the undersigned, a Notary Public in and for said County and State, this ___ day of ___, 2001, personally appeared: and acknowledged the execution of the foregoing deed. In witness whereof, I have hereunto subscribed my name and affixed my official seal.

My commission expires:
Resident of County

Signature
Printed, Notary Public

This instrument prepared by PATRICK J. McMANAMA, Attorney at Law, Identification No: 9534-45
No legal opinion given or rendered.

Return Deed To: GRANTEES - 297 E. 800 NORTH, LAKE VILLAGE, IN 46349
Send Tax bills to: GRANTEES - 297 E. 800 NORTH, LAKE VILLAGE, IN 46349

COMMUNITY TITLE COMPANY
FILE NO L22577-v Cash

JAN 15 2002

LAKE COUNTY AUDITOR

000901

Handwritten initials and marks: 16, CM

SEDGWICK/LEWIS

BEGINNING AT THE NORTHWEST CORNER OF THE NORTHEAST 1/4 OF SAID SECTION 33, THENCE SOUTH ALONG THE WEST LINE OF THE SAID NORTHEAST 1/4 A DISTANCE OF 1180 FEET; THENCE EAST PARALLEL TO THE NORTH LINE OF SAID NORTHEAST 1/4 A DISTANCE OF 299.80 FEET; THENCE SOUTH 24 DEGREES 12 MINUTES EAST A DISTANCE OF 752.40 FEET; THENCE SOUTH 4 DEGREES 35 MINUTES EAST A DISTANCE OF 34.0 FEET; THENCE NORTH 82 DEGREES 15 MINUTES EAST ALONG THE NORTH BANK OF THE MARBLE-POWERS DITCH A DISTANCE OF 605 FEET TO A POINT, SAID POINT BEING THE BEGINNING POINT OF THIS DESCRIPTION; THENCE NORTH 82 DEGREES 15 MINUTES EAST ALONG THE SAID NORTH BANK OF THE MARBLE-POWERS DITCH A DISTANCE OF 150 FEET; THENCE NORTH 4 DEGREES 35 MINUTES WEST A DISTANCE OF 63 FEET; THENCE WESTERLY A DISTANCE OF 150 FEET; THENCE SOUTH 4 DEGREES AND 15 MINUTES EAST A DISTANCE OF 61 FEET, TO THE POINT OF BEGINNING.

PARCEL 2:

THAT PART OF THE NORTHEAST 1/4 OF SECTION 33, TOWNSHIP 32 NORTH, RANGE 8 WEST OF THE SECOND PRINCIPAL MERIDIAN, MORE PARTICULARLY DESCRIBED AS FOLLOWS:

BEGINNING AT THE NORTHWEST CORNER OF THE NORTHEAST 1/4 OF SAID SECTION 33; THENCE SOUTH ALONG THE WEST LINE OF THE SAID NORTHEAST 1/4 A DISTANCE OF 1180 FEET; THENCE EAST PARALLEL TO THE NORTH LINE OF SAID NORTHEAST 1/4 A DISTANCE OF 299.80 FEET; THENCE SOUTH 24 DEGREES 12 MINUTES EAST A DISTANCE OF 752.40 FEET; THENCE SOUTH 4 DEGREES 35 MINUTES EAST A DISTANCE OF 34.0 FEET TO THE CENTER LINE OF HIGHWAY 55; THENCE NORTH 87 DEGREES 37 MINUTES 12 SECONDS EAST ALONG THE NORTH EDGE OF THE MARBLE-POWER DITCH A DISTANCE OF 755 FEET, TO A POINT WHICH IS THE POINT OF BEGINNING; THENCE NORTH 2 DEGREES, 22 MINUTES 48 SECONDS WEST A DISTANCE OF 60.0 FEET; THENCE NORTH 87 DEGREES 37 MINUTES 12 SECONDS EAST A DISTANCE OF 50.0 FEET; THENCE SOUTH 2 DEGREES 22 MINUTES 48 SECONDS EAST A DISTANCE OF 60.0 FEET TO THE NORTH EDGE OF THE MARBLE-POWER DITCH; THENCE SOUTH 87 DEGREES 37 MINUTES 12 SECONDS WEST, ALONG THE NORTH EDGE OF THE MARBLE-POWER DITCH, TO THE POINT OF BEGINNING, A DISTANCE OF 50 FEET, IN LAKE COUNTY, INDIANA.

