

2

STATE OF INDIANA
LAKE COUNTY
FILED FOR RECORD

2000 080642

2000 NOV -3 PM 1:44

MORRIS W. CARTER
RECORDER

A298-10
R298-04

QUITCLAIM DEED

THIS QUITCLAIM DEED, Executed this 9th day of November, 1997

by first party, Grantor, Noel Aquilla Bradley

whose post office address is 354 Waite St

to second party, Grantee, Albert Evans Jr.

whose post office address is P.O. Box 4556 Gary, IN 46404

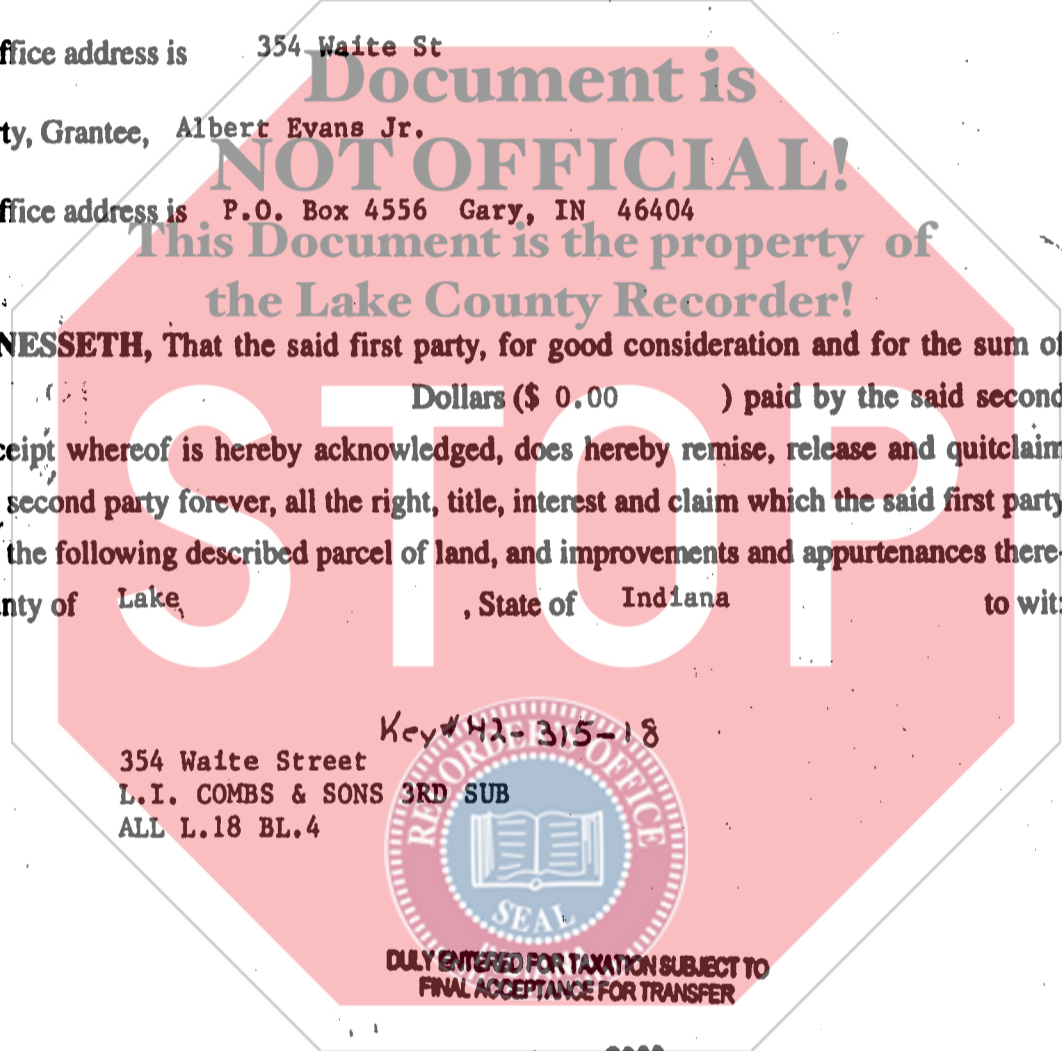

WITNESSETH, That the said first party, for good consideration and for the sum of Dollars (\$ 0.00) paid by the said second party, the receipt whereof is hereby acknowledged, does hereby remise, release and quitclaim unto the said second party forever, all the right, title, interest and claim which the said first party has in and to the following described parcel of land, and improvements and appurtenances there- to in the County of Lake, State of Indiana to wit:

354 Waite Street
L.I. COMBS & SONS 3RD SUB
ALL L.18 BL.4

Key # 42-315-18



DULY ENTERED FOR TAXATION SUBJECT TO
FINAL ACCEPTANCE FOR TRANSFER

NOV 3 2000

PETER BENJAMIN
LAKE COUNTY AUDITOR

ATHE
(1)

(Revised 3/97)

If your state requires 8 1/2" x 11" forms, cut off the bottom of this page at the dotted line.



© E-Z Legal Forms. Before you use this form, read it, fill in all blanks, and make whatever changes are necessary to your particular transaction. Consult a lawyer if you doubt the form's fitness for your purpose and use. E-Z Legal Forms and the retailer make no representation or warranty, express or implied, with respect to the merchantability of this form for an intended use or purpose.

00462

Handwritten initials: Ka/AC

25 x 10

IN WITNESS WHEREOF, The said first party has signed and sealed these presents the day and year first above written. Signed, sealed and delivered in presence of:

Thora M. Evans
Signature of Witness

Noel A. Bradley
Signature of First Party

Thora M. Evans
Print name of Witness

Noel A. Bradley
Print name of First Party

Signature of Witness

Signature of First Party

Print name of Witness

Print name of First Party

State of INDIANA
County of LAKE

On 11-9-97 before me, PERSONALLY
appeared NOEL A. BRADLEY

personally known to me (or proved to me on the basis of satisfactory evidence) to be the person(s) whose name(s) is/are subscribed to the within instrument and acknowledged to me that he/she/they executed the same in his/her/their authorized capacity(ies), and that by his/her/their signature(s) on the instrument the person(s), or the entity upon behalf of which the person(s) acted, executed the instrument.

WITNESS my hand and official seal.

[Signature]
Signature of Notary

NOT OFFICIAL!
This Document is the property of
the Lake County Recorder

Affiant Known Produced ID
Type of ID DL

(Seal)

State of INDIANA

County of LAKE

On November 2, 2000 before me, RENDE A. LONG
appeared THORA M. EVANS

personally known to me (or proved to me on the basis of satisfactory evidence) to be the person(s) whose name(s) is/are subscribed to the within instrument and acknowledged to me that he/she/they executed the same in his/her/their authorized capacity(ies), and that by his/her/their signature(s) on the instrument the person(s), or the entity upon behalf of which the person(s) acted, executed the instrument.

WITNESS my hand and official seal.

[Signature]
Signature of Notary
my comm exp 7/2/2001



Affiant Known Produced ID
Type of ID Driver License

(Seal)

Thora M. Evans
Signature of Preparer

THORA M. EVANS
Print Name of Preparer

7155 HEMLOCK AV
Address of Preparer

----- (2) -----
If your state requires 8 1/2" x 11" forms, cut off the bottom of this page at the dotted line.



STATE OF INDIANA
LAKE COUNTY
FILED FOR RECORD

2000 080642

2000 NOV -3 PM 1:45

MORRIS W. CARTER
RECORDER

Document Mail Back to Information Sheet

This is where you want the recorded-document sent back to
when it has completed the recording process.

This Document is the property of

Name Albert Evans Jr

Address P.O. Box 4556

City St Zip GARY, IN 46404

Telephone (219) 882-8303

Signature Printed Albert Evans Jr

Signature Written _____

Date of Signature 11-3-00

Check Number _____

Check Amount Cash \$16.00

Office Use Only

Check Equals Amount Due Yes No

Total 16.00

Initials Ac