

Warranty Deed

THIS INDENTURE WITNESSETH, That HELEN NADOLSKI, tenant in the entirety, County of LAKE, in the State of Indiana CONVEY AND WARRANT to THE HELEN NADOLSKI LIVING TRUST NUMBER 927 OF FEBRUARY 2, 1999 County of LAKE, in the State of Indiana, for the sum of TEN DOLLARS (\$10.00) and other valuable consideration, the receipt of which is hereby acknowledged, the following described real estate in LAKE County, Indiana.

Lot Twenty-eight (28), Block C, Meadowland Manor, Unit No. 1, in the City of Gary, as shown in Plat Book 31, page 91, in Lake County, Indiana.

Subject To: Taxes, easements, covenants and restrictions of record, special improvements, sanitation assessments, ditches and drains and rights thereof, zoning ordinances, highways, and legal right-of-ways.

#46-582-28

Subject to all zoning laws and other restrictions, regulation, ordinances, or statutes of any governmental authority applicable to the above property.

More Commonly known as 5224-34 Georgia Street, Gary, Indiana.

Tax bills should be sent to such address unless otherwise indicated above.

IN WITNESS WHEREOF, tenant in the entirety executed this deed on the 21 day of Oct., 2000.

Signature: X Helen Nadolski

Signature: _____

Printed: Helen Nadolski

Printed: _____

ACKNOWLEDGMENT

STATE OF INDIANA)
)SS:
COUNTY OF LAKE)

Before me, a Notary Public in and for said County and State, personally appeared, Helen Nadolski and _____ acknowledged the execution of the foregoing Warranty Deed.

Witness my hand and Notarial Seal this 21st day of Oct., 2000.

My Commission Expires: _____

SIGNATURE: _____

3-22-2007

Printed: Sandra DAVIS

Notary Public

Resident of LAKE, County

This instrument prepared by Attorney David L. Chidester, 100 E. Lincolnway, Suite 202-Valparaiso, Indiana 46383 (219) 465-0868

Return Deed to Helen Nadolski, 5224 Georgia Street, Gary, Indiana 46409

PETER BENJAMIN
LAKE COUNTY AUDITOR

02388

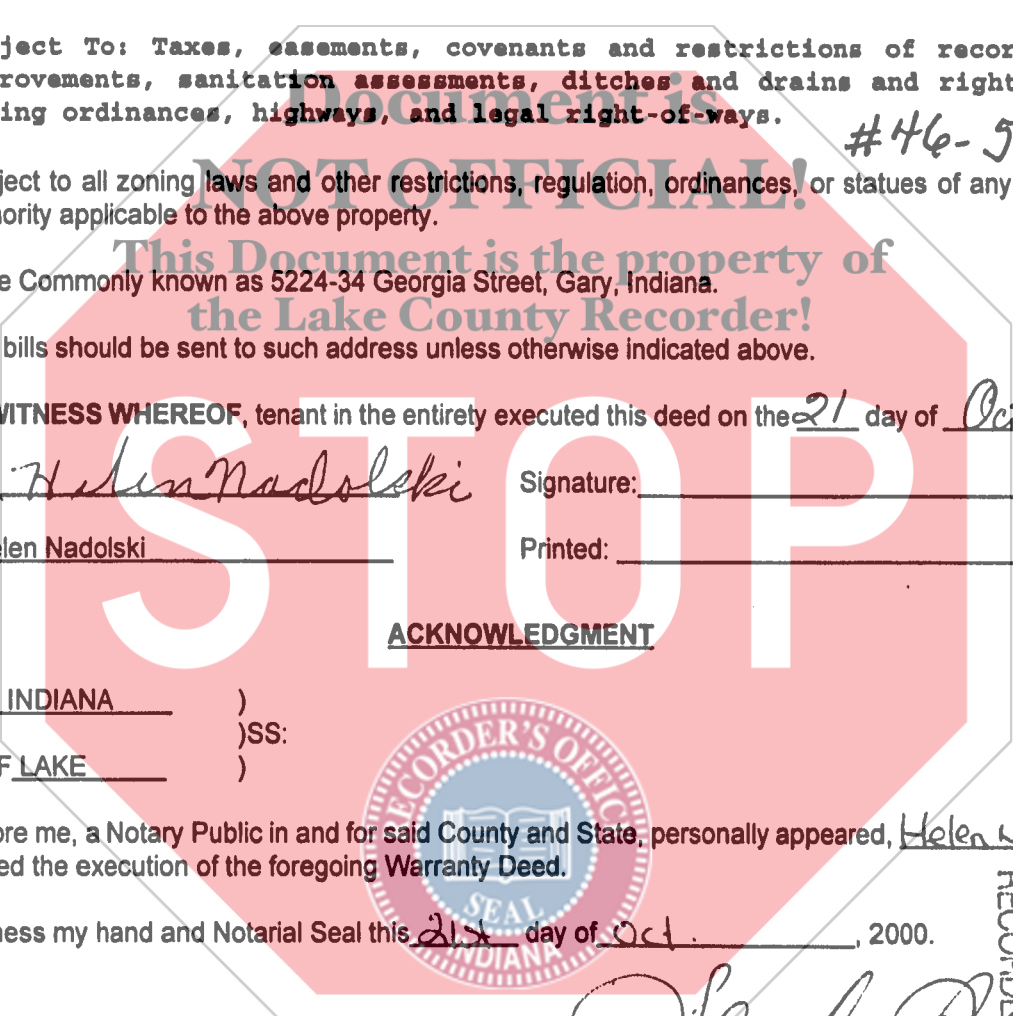

2000 079375

STATE OF INDIANA
LAKE COUNTY
FILED
2000 OCT 31 AM 11:32
MERRIS W. DANTER
RECORDER

OCT 31 2000

15.00
3.00
9