

STATE OF INDIANA
LAKE COUNTY
FILED FOR RECORD

2000 076403

2000 OCT 19 PM 3:28

RECORDED
INDEXED

A298-10
R298-04

QUITCLAIM DEED

THIS QUITCLAIM DEED, Executed this 4th day of October, 2000 (year),

by first party, Grantor, Mr. & Mrs. Ora Mae & Eugene Keith
 whose post office address is 2423 Buchanan Street, Gary, Indiana
 to second party, Grantee, Calvary Hill Temple Faith Church, Inc.
 Agent, Jeanetta Perry
 whose post office address is P.O. Box 1086
 Milwaukee, WI. 53201-1086

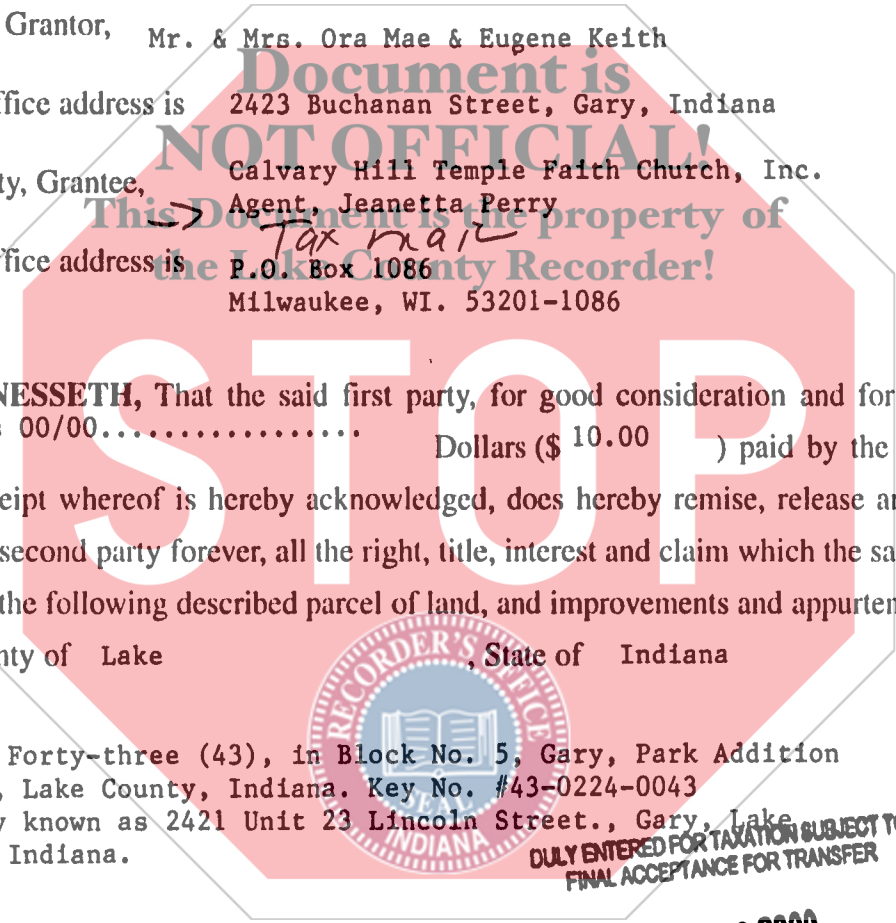

WITNESSETH, That the said first party, for good consideration and for the sum of Ten dollars 00/00..... Dollars (\$ 10.00) paid by the said second party, the receipt whereof is hereby acknowledged, does hereby remise, release and quitclaim unto the said second party forever, all the right, title, interest and claim which the said first party has in and to the following described parcel of land, and improvements and appurtenances there- to in the County of Lake, State of Indiana to wit:

Lot No. Forty-three (43), in Block No. 5, Gary, Park Addition to Gary, Lake County, Indiana. Key No. #43-0224-0043 commonly known as 2421 Unit 23 Lincoln Street., Gary, Lake County, Indiana.

DULY ENTERED FOR TAXATION SUBJECT TO FINAL ACCEPTANCE FOR TRANSFER

OCT 19 2000

PETER BENJAMIN
LAKE COUNTY AUDITOR

01588

© 1992-2000 E-Z Legal Forms, Inc.

(1)
ATAA

Rev. 6'00

This product does not constitute the rendering of legal advice or services. This product is intended for informational use only and is not a substitute for legal advice. State laws vary, so consult an attorney on all legal matters. This product was not necessarily prepared by a person licensed to practice law in this state.

If your state requires 8 1/2" x 11" forms, cut off the bottom of this page at the dotted line.

16.00
AC

IN WITNESS WHEREOF, The said first party has signed and sealed these presents the day and year first above written. Signed, sealed and delivered in presence of:

[Signature]
Signature of Witness

Ora Mae Keith
Signature of First Party

Patrician Owens
Print name of Witness

Ora Mae Keith
Print name of First Party

BeShanta Nichols
Signature of Witness

Eugene Keith
Signature of First Party

BeShanta Nichols
Print name of Witness

EUGENE KEITH SR.
Print name of First Party

State of Indiana
County of Lake

On October 4, 2000 before me, Renee A. Long
appeared Ora Mae Keith & Eugene Keith
personally known to me (or proved to me on the basis of satisfactory evidence) to be the person(s) whose name(s) is/are subscribed to the within instrument and acknowledged to me that he/she/they executed the same in his/her/their authorized capacity(ies), and that by his/her/their signature(s) on the instrument the person(s), or the entity upon behalf of which the person(s) acted, executed the instrument.
WITNESS my hand and official seal.

Renee A. Long
Signature of Notary

My comm exp 7/2/2001

Affiant Known Produced ID
Type of ID Drivers License
(Seal)

State of _____
County of _____
On _____ before me,
appeared _____

personally known to me (or proved to me on the basis of satisfactory evidence) to be the person(s) whose name(s) is/are subscribed to the within instrument and acknowledged to me that he/she/they executed the same in his/her/their authorized capacity(ies), and that by his/her/their signature(s) on the instrument the person(s), or the entity upon behalf of which the person(s) acted, executed the instrument.
WITNESS my hand and official seal.

Signature of Notary

Affiant Known Produced ID
Type of ID _____
(Seal)

Signature of Preparer

Print Name of Preparer

Address of Preparer

(2)

If your state requires 8 1/2" x 11" forms, cut off the bottom of this page at the dotted line.



2000 076404 ⁰³

STATE OF INDIANA
LAKE COUNTY
FILED BY [unclear] TD
2000 OCT 19 PM 3:28

Document Mail Back to
Information Sheet

This is where you want the recorded document sent back to when it has completed the recording process.

Name Calvary Hill Temple, Op. Faith Church
Address P.O. Box 1086
City St Zip Milwaukee, WI 53201-1086
Telephone (414) 873-9893
Signature Printed Perry, Jeanette
Signature Written Perry, Jeanette
Date of Signature October 19, 2000
Check Number #2204
Check Amount \$32.00

Office Use Only

Check Equals Amount Due Yes No
Total 32.00
Initials Ac