

2000 075427



WARRANTY DEED

TAX KEY # 13-589-29 Unit 20

THIS INDENTURE WITNESSETH, THAT METRO PLEX HOMES, INC.

OF LAKE COUNTY, STATE OF INDIANA CONVEY AND WARRANT TO TIMOTHY ADAMS AND ELENI ADAMS, HUSBAND AND WIFE

OF LAKE COUNTY, STATE OF INDIANA, FOR AND IN CONSIDERATION OF THE SUM OF TEN AND NO/100 DOLLARS THE RECEIPT WHEREOF IS HEREBY ACKNOWLEDGED, THE FOLLOWING DESCRIBED REAL ESTATE IN LAKE COUNTY, STATE OF INDIANA, TO-WIT:

LOT 29, IN THE WOODS, UNIT 1, AN ADDITION TO THE TOWN OF SCHERERVILLE, AS PER PLAT THEREOF, RECORDED IN PLAT BOOK 75, PAGE 33, IN THE OFFICE OF THE RECORDER OF LAKE COUNTY, INDIANA.

COMMONLY KNOWN AS: 2849 Morningside Drive
Crown Point, IN 46307

THERE IS NO GROSS INCOME TAX DUE BY VIRTUE OF THIS DEED.

IN WITNESS WHEREOF, THE SAID Metro Plex Homes, Inc. President

HAVE HEREUNTO SET his HAND AND SEAL, THIS 16th DAY OF October, 2000

Vincent Van Vuren, President (SEAL) PETER BENJAMIN (SEAL)
Metro Plex Homes, Inc. (SEAL) LAKE COUNTY AUDITOR (SEAL)

STATE OF INDIANA, COUNTY OF LAKE, SS:
BEFORE ME, THE UNDERSIGNED NOTARY PUBLIC IN AND FOR SAID COUNTY AND STATE, PERSONALLY APPEARED Vincent Van Vuren, President of Metro Plex * Homes, Inc. AND ACKNOWLEDGED THE EXECUTION OF THIS INSTRUMENT TO BE his VOLUNTARY ACT

AND DEED, WITNESS MY HAND AND OFFICIAL SEAL THIS 16th DAY OF October, 2000

MY COMMISSION EXPIRES: 9/17/01
Andrea A. Widlowski NOTARY PUBLIC

SEND TAX STATEMENTS TO: 2849 Morningside Drive Crown Point, IN 46307

THIS INSTRUMENT PREPARED BY: Vincent Van Vuren HOLD FOR FIRST AMERICAN TITLE

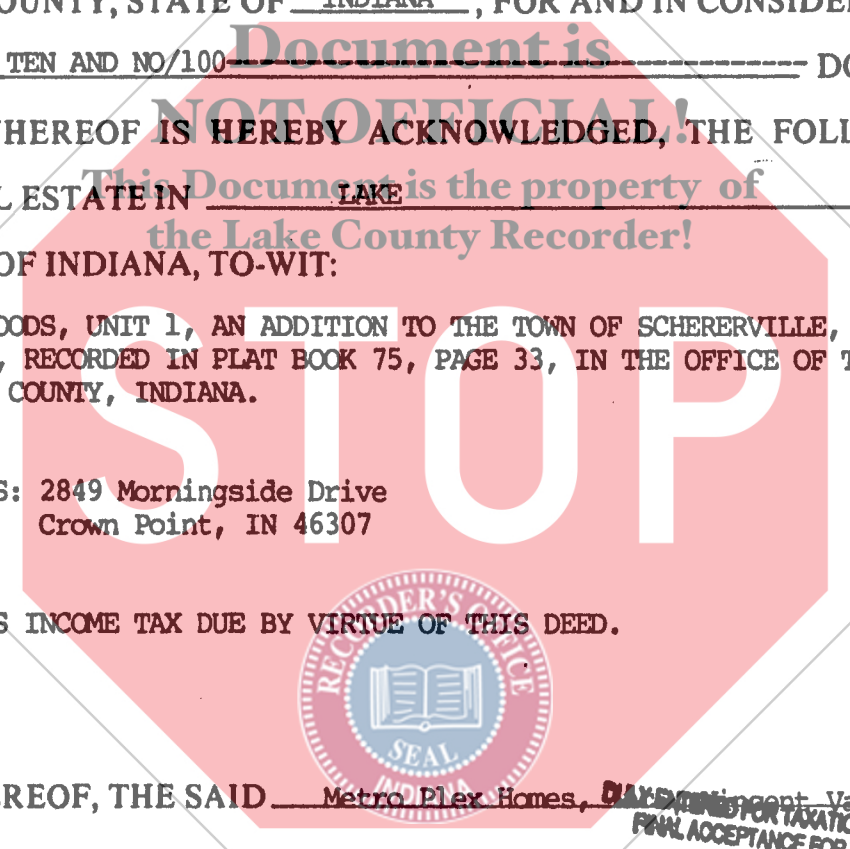

01359

Fu
14
60