

STATE OF INDIANA
LAKE COUNTY
FILED FOR RECORD

2000 073791

2000 OCT 11 AM 9:07

THIS FORM HAS BEEN PREPARED FOR USE IN THE STATE OF INDIANA BY LAWYERS ONLY. SELECTING A FORM OF INSTRUMENT, FILLING IN BLANK SPACES, STRIKING OUT PROVISIONS AND INSERTING SPECIAL CLAUSES MAY CONSTITUTE THE PRACTICE OF LAW, WHICH SHOULD BE PERFORMED ONLY BY A LAWYER.

Mail tax bills to:
3934 Wright Circle
Gary, IN 46408

WARRANTY DEED

Key No. 39-18-46 and
Key #39-18-32

THIS INDENTURE WITNESSETH, That Jo A. Newlin ("Grantor")

of Lake County in the State of Indiana
CONVEY(S) AND WARRANT(S) TO Edmund J. Garcia and Parri Garcia, husband and wife

of Lake County in the State of Indiana ("Grantee")

in consideration of One Dollar and other valuable consideration, the receipt and sufficiency of which are hereby acknowledged, the following described real estate in Lake County, in the State of Indiana:

See attached for legal description.

More commonly known as: 3934 Wright Circle
Gary, IN 46408

Subject to real estate taxes for 2000 due and payable in 2001 and thereafter.

Subject to all covenants, conditions, restrictions, liens and easements of record.

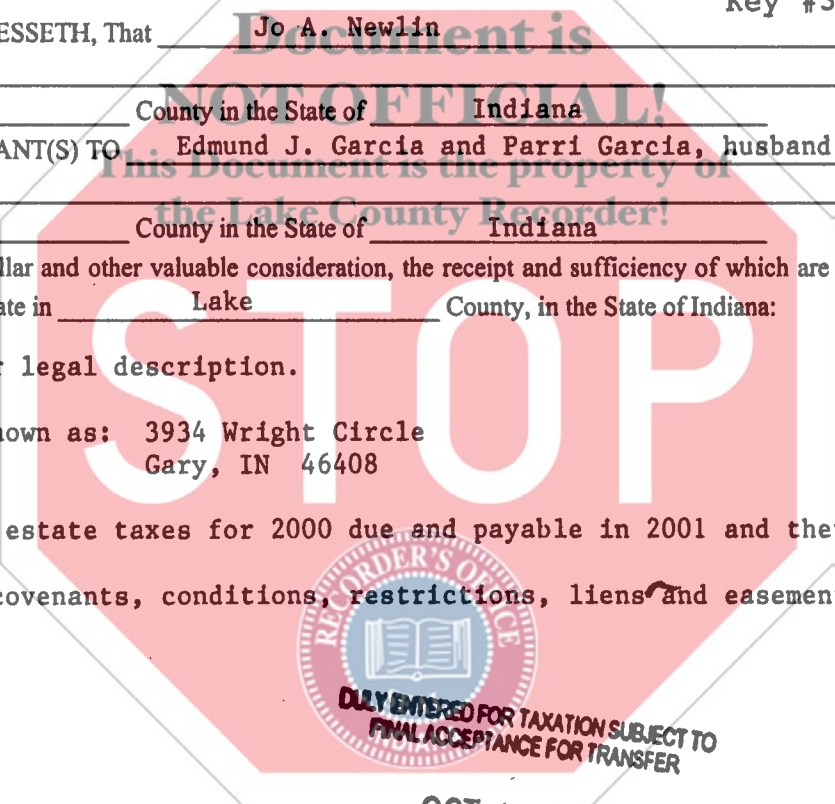

OCT 10 2000

PETER BENJAMIN
LAKE COUNTY AUDITOR

00580

Ticor M.O. 920004549

(Do not mark below this line)

18.00
T.I

Dated this 6th day of October, 2000.

Jo A. Newlin
(Signature)

Jo A. Newlin
(Printed Name)

(Signature)

(Printed Name)

(Signature)

(Signature)

(Printed Name)

(Printed Name)

STATE OF Indiana COUNTY OF Lake SS:

Before me, the undersigned, a Notary Public in and for said County and State, this 6th day of October, 2000 personally appeared: Jo A. Newlin

and acknowledged the execution of the foregoing deed in witness whereof, I have hereunto subscribed my name and affixed my official seal.

My commission expires: 1-26-07

Resident of Lake

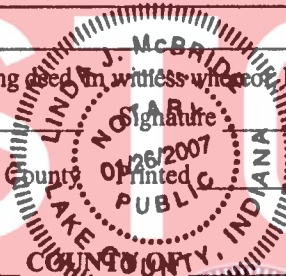

Linda J. McBride
(Signature)

Linda J. McBride

, Notary Public

STATE OF _____ COUNTY OF _____ SS:

Before me, the undersigned, a Notary Public in and for said County and State, this _____ day of _____, _____ personally appeared: _____

and acknowledged the execution of the foregoing deed. In witness whereof, I have hereunto subscribed my name and affixed my official seal.

My commission expires: _____ Signature: _____

Resident of _____ County Printed _____, Notary Public

This instrument prepared by Mark S. Lucas, Lucas, Holcomb & Medrea, 300 E. 90th Dr., Attorney at Law
Attorney No. _____ Easton Ct., Merrillville, IN 46410

MAIL TO:



LEGAL DESCRIPTION

That part of the Northeast 1/4 of the Southeast 1/4 of the Northwest 1/4 of Section 30, Township 36 North, Range 8 West of the 2nd Principal Meridian, being more particularly described as follows:

Commencing at a point on the West line of said Northeast 1/4 of the Southeast 1/4 of the Northwest 1/4, 245 feet South of the Northwest corner thereof; thence East parallel to the North line of said Northeast 1/4 of the Southeast 1/4 of the Northwest 1/4, a distance of 232.65 feet; thence South, a distance of 165.02 feet, more or less, to a point 250 feet North of the South line and 232.57 feet East of the West line of said Northeast 1/4 of the Southeast 1/4 of the Northwest 1/4; thence West parallel to the South line of said Northeast 1/4 of the Southeast 1/4 of the Northwest 1/4, a distance of 232.57 feet to the West line thereof; thence North 165 feet, more or less, to the point of beginning, in Lake County, Indiana.

