

H.E.

STATE OF INDIANA
LAKE COUNTY
FILED FOR RECORD

2000 073329

2000 OCT 10 AM 9:24

MORRIS W. CARTER
RECORDER

SATISFACTION OF MORTGAGE

This Certifies, that a certain Mortgage executed by **JUDITH A. GRAVES**, to Mercantile National Bank of Indiana, calling for **\$6,500.00** dated **AUGUST 28, 1998** and recorded **SEPTEMBER 21, 1998** as Document no. **98074387**, LAKE County, State of Indiana, has been fully paid and satisfied, and the same is hereby released.

TICOR TITLE INSURANCE
Crown Point, Indiana

Property is legally described as:

LOT 1, 2, 3, AND THE NORTH 1/2 OF LOT 4 IN BLOCK 25 IN UNIT 7 IN WOODMAR ADDITION TO THE CITY OF HAMMOND, AS PER PLAT THEREOF, RECORDED IN PLAT BOOK 16 PAGE 34, IN THE OFFICE OF THE RECORDER OF LAKE COUNTY, INDIANA. PART OF LOT 21 BLOCK 24 AND LOTS 1 AND 2 BLOCK 25 IN UNIT 7 WOODMAR, SAID PART BEING THAT PART OF VACATED 174TH AVENUE (FORMERLY 22ND AVENUE) VACATED PURSUANT TO CONFIRMATORY #1968 LYING SOUTH OF A LINE 83.17 FEET SOUTH OF AND PARALLEL WITH THE NORTH LINE OF LOT 22 BLOCK 24 IN UNIT 7 WOODMAR RECORDED IN PLAT BOOK 16 PAGE 34, IN THE OFFICE OF THE RECORDER OF LAKE COUNTY, INDIANA.

Property is commonly referred to as: **7403 MAGOUN AVENUE - HAMMOND, INDIANA 46324**

MERCANTILE NATIONAL BANK OF INDIANA

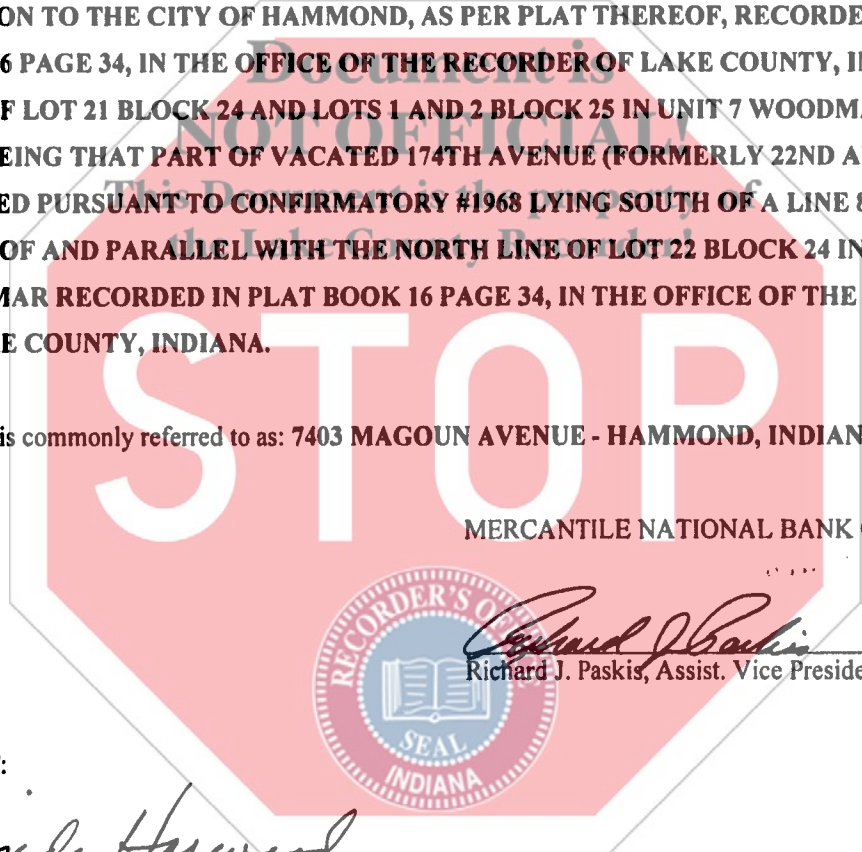

Richard J. Paskis, Assist. Vice President

ATTEST:

Linda Harwood
Linda Harwood, Asst. Loan Administration Officer

State of Indiana, Lake County, SS:

Before me, the undersigned, a Notary Public in and for said County, this **2ND** day of **OCTOBER**, 2000, personally appeared Linda Harwood, Assistant Loan Administration Officer and Richard J. Paskis, Assist. Vice President of Mercantile National Bank of Indiana and acknowledged the Execution of the foregoing Satisfaction of Mortgage.

Shawn Sashington
Shawn Sashington

My commission expires: **January 31, 2007**
County of Residence: **Lake**

This document was prepared by: Janice Gasiorek Mortgage Loan Service Mercantile National Bank of Indiana

Return: Mercantile National Bank, 200 West Ridge Road, Griffith, IN 46319

10.00
ETP
77