

GRANT OF EASEMENT

THIS INDENTURE WITNESSETH, that Frances R. Crisman, as Trustee of the Frances R. Crisman Revocable Trust dated July 18, 1996, of Lake County in the State of Indiana in consideration of the sum of One (\$1.00) Dollar and other good and valuable consideration, the receipt of which is hereby acknowledged, do hereby grant unto DeForest Lipke and Tereonedita Lipke, husband and wife, as to an undivided 1/2 interest and DeForest Lipke, Jr., as to an undivided 1/2 interest, their heirs, successors and assigns, a perpetual non-exclusive access easement for ingress and egress with or without vehicles, together with a utility easement over and across the same land hereinafter described for the purpose of installing and maintaining electric power transmission lines, telephone lines and water and sewer pipes, on and across the following described real estate owned by the Grantor, in fee simple, in Lake County, Indiana.

Legal description on Exhibit A attached.

Said tract of land above described to be used jointly by the Grantor and the Grantee, their grantees', successors, heirs, assigns, tenants, servants, visitors, and licensees, in common with all others having the like right, at all times hereafter, for all purposes connected with the use and enjoyment of the said land of the Grantee, which land is described as follows:

Legal description on Exhibit B attached.

IN WITNESS WHEREOF, Grantor has executed this Easement this 15th day of June, 2000.

FILED

SEP 26 2000

PETER BENJAMIN
LAKE COUNTY AUDITOR

Frances R. Crisman
FRANCES R. CRISMAN, TRUSTEE

01752

16.00
E.P.
2836

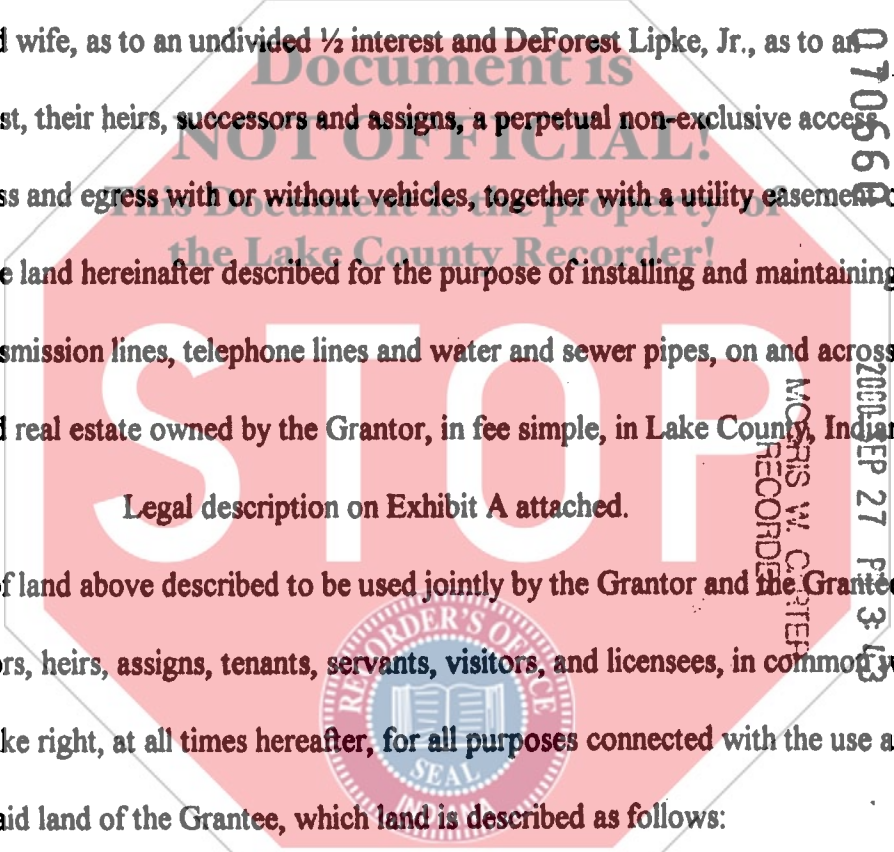

000 070566
2000 SEP 27 PM 3:43
STATE OF INDIANA
LAKE COUNTY
FILED FOR RECORD

Document is
NOT OFFICIAL!

This Document is the property of
EXHIBIT A
the Lake County Recorder!

LEGAL DESCRIPTION

STOP

EASEMENT DESCRIPTION: Part of the SW 1/4 of Section 7, Township 35 North, Range 7 West of the 2nd P.M. and part of the SE 1/4 of Section 12, Township 35 North, Range 8 West of the 2nd P.M., Lake County, Indiana, described as follows: Beginning at the Southeast corner of said Section 12; thence North 88°57'24" West, along the South line of said SE 1/4, 40.00 feet; thence North 06°00'00" West, 280.00 feet; thence North 25°00'00" West, 340.00 feet; thence North 05°30'00" West, 169.45 feet; thence North 26°13'29" West 150.00 feet; thence North 06°27'56" West, 467.10 feet; thence North 83°32'04" East, 60.00 feet; thence South 06°27'56" East, 456.65 feet; thence South 26°13'29" East, 148.91 feet; thence South 06°30'00" East, 179.01 feet; thence South 25°00'00" East, 280.92 feet; thence South 88°57'24" East, 46.38 feet to a point on the East line of said SE 1/4 that is 366.77 feet North of the Southeast corner of said Section 12; thence continuing South 88°57'24" East, 320.16 feet; thence North 00°16'18" East, 321.37 feet; thence North 22°39'43" West, 115.00 feet; thence North 00°16'18" East, 202.33 feet; thence South 88°57'24" East, 60.01 feet; thence South 00°16'18" West, 189.35 feet; thence South 22°39'43" East, 114.96 feet; thence South 00°16'18" West, 394.37 feet; thence North 88°57'24" West, 398.02 feet to the West line of the SW 1/4 of said Section 7; thence continuing North 88°57'24" West, 17.57 feet; thence South 25°00'00" East, 13.64 feet; thence South 06°00'00" East, 110.25 feet to the East line of the SE 1/4 of said Section 12; thence continuing South 06°00'00" East 166.47 feet to the South line of the SE 1/4 of said Section 7; thence North 88°57'24" West, 20.37 feet to the point of beginning, containing 1.447 acres, more or less, in said Section 7 and 1.943 acres, more or less, in said Section 12.



EXHIBIT B

LEGAL DESCRIPTION

KRULL & SON

This Document is the property of
ENGINEERS AND SURVEYORS
ESTABLISHED 1914

P.O. BOX 422
205 MAIN STREET
MORIST, INDIANA 46042
OFFICE PHONE 219-347-2888

PLAT OF SURVEY

PARCEL 1: Part of the SW 1/4 of Section 7, Township 35 North, Range 7 West of the 2nd P.M. and part of the SE 1/4 of Section 12, Township 35 North, Range 8 West of the 2nd P.M., Lake County, Indiana, described as follows: Commencing at the Southwest corner of said Section 7; thence South 88°57'24" East, along the South line of the SW 1/4 of said Section 7, 20.37 feet to the point of beginning; thence North 06°00'00" West, 188.47 feet to a point of the West line of said SW 1/4 that is 185.06 North of the Southwest corner of said Section 7; thence continuing North 06°00'00" West, 110.25 feet; thence North 25°00'00" West, 13.64 feet; thence South 88°57'24" East, 17.87 feet to a point on the East line of the SE 1/4 of said Section 12 that is 308.78 feet North of the Southeast corner of said Section 12; thence continuing South 88°57'24" East, 204.00 feet; thence South 00°16'18" West, 308.78 feet to the South line of the SW 1/4 of said Section 7; thence North 88°57'24" West, along said South line, 181.63 feet to the point of beginning, containing 1.393 acres, more or less, in said Section 7 and 0.019 acres, more or less, in said Section 12.

PARCEL 2: Part of the SW 1/4 of Section 7, Township 35 North, Range 7 West of the 2nd P.M. and part of the SE 1/4 of Section 12, Township 35 North, Range 8 West of the 2nd P.M., Lake County, Indiana, described as follows: Commencing at the Southwest corner of the SW 1/4 of said Section 7; thence North 00°16'18" East, along the West line of said SW 1/4, 398.77 feet to the point of beginning; thence North 88°57'24" West, 48.38 feet; thence North 25°00'00" West, 280.92 feet; thence North 05°30'00" West, 170.11 feet; thence North 26°13'29" West, 148.91 feet; thence North 06°27'38" West, 458.65 feet; thence South 45°13'30" East, 281.25 feet; thence South 19°30'40" East, 113.93 feet; thence South 05°32'22" West, 394.34 feet; thence North 72°26'07" East, 96.30 feet to the West line of the SE 1/4 of said Section 12, thence continuing North 72°26'07" East, 289.21 feet; thence South 22°39'43" East, 115.00 feet; thence South 00°16'18" West, 321.37 feet; thence North 88°57'24" West, 320.15 feet to the point of beginning, containing 2.780 acres, more or less, in said Section 7 and 3.104 acres, more or less, in said Section 12.

PARCEL 3: Part of the SW 1/4 of Section 7, Township 35 North, Range 7 West of the 2nd P.M., Lake County, Indiana, described as follows: Commencing at the Southwest corner of the SW 1/4 of said Section 7; thence South 88°57'24" East, along the South line of said SW 1/4, 904.10 feet to the point of beginning; thence North 00°16'18" East, 215.00 feet; thence North 88°57'24" West, 418.16 feet; thence North 00°16'18" East, 91.78 feet; thence North 88°57'24" West, 107.85 feet; thence North 00°16'18" East, 394.37 feet; thence North 22°39'43" West, 114.99 feet; thence North 00°16'18" East, 189.35 feet; thence South 88°57'24" East, 934.18 feet; thence South 00°16'18" West, 359.47 feet; thence South 04°46'06" East, 639.53 feet to the South line of the SW 1/4 of said Section 7; thence North 88°57'24" West, along the South line of said SW 1/4, 421.59 feet to the point of beginning, containing 18.175 acres, more or less.

Together with a 60 foot ingress and egress, drainage and utility easement.