

2

STATE OF INDIANA
LAKE COUNTY
FILED FOR RECORD

2000 069512

2000 SEP 22 PH 12: 09

MORRIS W. CARTER
RECORDER

A298-10
R298-04

QUITCLAIM DEED

THIS QUITCLAIM DEED, Executed this 31 day of August, 2000 (year),

by first party, Grantor, *Aspasia Medellin / Aspasia Sofin-Plutis*

whose post office address is *3521 S. Randolph Hobart, IN 46342*

to second party, Grantee, *Emanuel M. Medellin*

whose post office address is *3443 Massachusetts Street Gary, IN 46409*

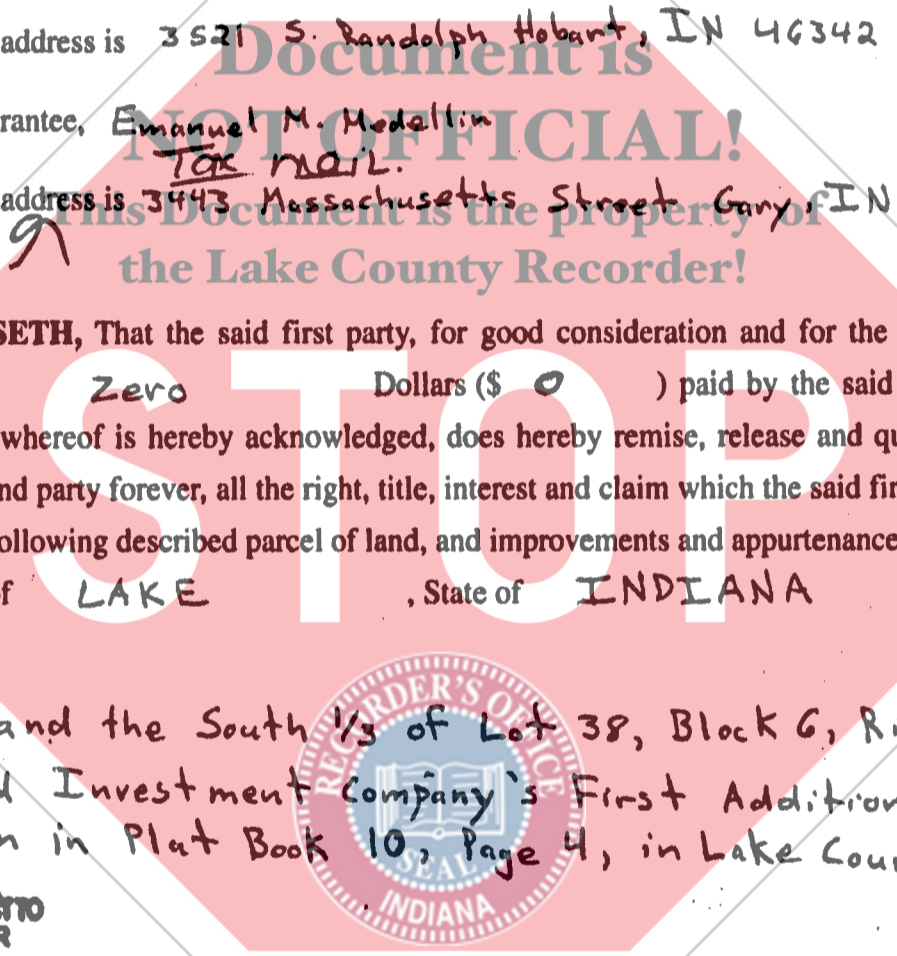

WITNESSETH, That the said first party, for good consideration and for the sum of

Zero Dollars (\$ *0*) paid by the said second

party, the receipt whereof is hereby acknowledged, does hereby remise, release and quitclaim unto the said second party forever, all the right, title, interest and claim which the said first party has in and to the following described parcel of land, and improvements and appurtenances there- to in the County of *LAKE*, State of *INDIANA* to wit:

Lot 37 and the South 1/3 of Lot 38, Block G, Riverview Land and Investment Company's First Addition to Gary, as shown in Plat Book 10, Page 4, in Lake County, Indiana

DULY ENTERED FOR TAXATION SUBJECT TO FINAL ACCEPTANCE FOR TRANSFER

SEP 22 2000

PETER BENJAMIN
LAKE COUNTY AUDITOR

Key # *..46-466-38*

01533

ABAA (1)

Rev. 4/99

If your state requires 8 1/2" x 11" forms, cut off the bottom of this page at the dotted line.



*16-
CS*

25x10

IN WITNESS WHEREOF, The said first party has signed and sealed these presents the day and year first above written. Signed, sealed and delivered in presence of:

Debra S. Ransom
Signature of Witness

DEBRA S. RANSOM
Print name of Witness

Marilyn Janosek
Signature of Witness

MARILYN JANOSEK
Print name of Witness

Aspasia Sotir-Plutis
Signature of First Party

Aspasia Sotir-Plutis
Print name of First Party

Signature of First Party

Print name of First Party

State of INDIANA

County of LAKE

On 8-31-2000 before me,
appeared ASPASIA SOTIR-PLUTIS

personally known to me (or proved to me on the basis of satisfactory evidence) to be the person(s) whose name(s) is/are subscribed to the within instrument and acknowledged to me that he/she/they executed the same in his/her/their authorized capacity(ies), and that by his/her/their signature(s) on the instrument the person(s), or the entity upon behalf of which the person(s) acted, executed the instrument.
WITNESS my hand and official seal.

Barbara Bryson
Signature of Notary

State of _____
County of _____
On _____

appeared _____ before me,
personally known to me (or proved to me on the basis of satisfactory evidence) to be the person(s) whose name(s) is/are subscribed to the within instrument and acknowledged to me that he/she/they executed the same in his/her/their authorized capacity(ies), and that by his/her/their signature(s) on the instrument the person(s), or the entity upon behalf of which the person(s) acted, executed the instrument.
WITNESS my hand and official seal.

Signature of Notary

Affiant _____ Known _____ Produced ID _____
Type of ID Ind. L. 8905-10-2806
(Seal)



Emanuel M. Medellin
Signature of Preparer

Emanuel M. Medellin
Print Name of Preparer

3443 Mass. St. Gary, IN 46409
Address of Preparer

10230

(2)

If your state requires 8 1/2" x 11" forms, cut off the bottom of this page at the dotted line.