

STATE OF INDIANA
LAKE COUNTY
FILED FOR RECORD

2000 065794

2000 SEP 11 AM 10:38

WARRANTY DEED

MORRIS W. CARTER
RECORDER

THIS INDENTURE WITNESSETH, That **KEITH A. ERIKS AND MONICA T. ERIKS, HUSBAND AND WIFE,** GRANTOR(S) of LAKE County in the State of INDIANA, CONVEYS AND WARRANTS to **DANIEL E. GRIFFIN AND KIMBERLY M. GRIFFIN, HUSBAND AND WIFE** of LAKE County in the State of INDIANA, as GRANTEE(S) in consideration of One Dollar (\$1.00) and other valuable consideration, the receipt and sufficiency of which are hereby acknowledged, the following described real estate in LAKE County, in the State of Indiana:

SEE REVERSE SIDE HEREOF FOR LEGAL DESCRIPTION.

COMMONLY KNOWN AS: 2016 E. ELM STREET, GRIFFITH, INDIANA 46319

SUBJECT TO SPECIAL ASSESSMENTS, 1999 TAXES PAYABLE 2000, 2000 TAXES PAYABLE 2001 AND ALL REAL ESTATE TAXES DUE AND PAYABLE HEREAFTER.

Unit No. 1, Key No. 39-22-39

SUBJECT TO EASEMENTS, RESTRICTIONS, AND COVENANTS OF RECORD, IF ANY.

Dated this 28th day of August, 2000.

Keith A. Eriks Monica T. Eriks
KEITH A. ERIKS MONICA T. ERIKS

STATE OF INDIANA
COUNTY OF LAKE SS:

Before me, the undersigned, a Notary Public in and for said County and State, this 28th day of August, 2000, personally appeared: **KEITH A. ERIKS AND MONICA T. ERIKS, HUSBAND AND WIFE**, and acknowledged the execution of the foregoing deed. In witness whereof, I have hereunto subscribed my name and affixed my official seal.

My commission expires: 04/15/08 Signature Patricia Ludington
Resident of LAKE County Printed Patricia Ludington, Notary Public

STATE OF _____
COUNTY OF _____ SS:

Before me, the undersigned, a Notary Public in and for said County and State, this _____ day of _____, 2000, personally appeared: _____ and acknowledged the execution of the foregoing deed. In witness whereof, I have hereunto subscribed my name and affixed my official seal.

My commission expires: _____ Signature _____
Resident of _____ County Printed _____, Notary Public

This instrument prepared by **PATRICK J. McMANAMA**, Attorney at Law, Identification No: 9534-45

Return Deed To: **DANIEL E. GRIFFIN AND KIMBERLY M. GRIFFIN** 2016 EAST ELM STREET, GRIFFITH, INDIANA 46319
Send Tax Bills To: **DANIEL E. GRIFFIN AND KIMBERLY M. GRIFFIN**
FINAL ACCEPTANCE FOR TRANSFER

COMMUNITY TITLE COMPANY
FILE NO 19997MV

SEP 5 2000

PETER BENJAMIN
LAKE COUNTY AUDITOR

16.00
EP.

00150

CM

LEGAL DESCRIPTION

ERIKS/GRIFFIN

THE EAST 50 FEET OF THAT PART OF THE SOUTHWEST 1/4 OF THE NORTHWEST 1/4 OF FRACTIONAL SECTION 31, TOWNSHIP 36 NORTH, RANGE 8 WEST OF THE 2ND P.M., DESCRIBED AS FOLLOWS: BEGINNING AT THE INTERSECTION OF THE SOUTHERLY RIGHT-OF-WAY LINE OF THE MICHIGAN CENTRAL RAILROAD WITH THE SOUTH LINE OF THE SOUTHWEST 1/4 OF THE NORTHWEST 1/4 OF SAID FRACTIONAL SECTION 31; THENCE EAST ALONG SOUTH LINE OF SOUTHWEST 1/4 OF THE NORTHWEST 1/4 OF SAID FRACTIONAL SECTION 31, A DISTANCE OF 613.77 FEET TO A POINT 747.9 FEET EAST OF THE SOUTHWEST CORNER THEREOF; THENCE NORTH 228.10 FEET TO A POINT ON THE SOUTHERLY RIGHT-OF-WAY LINE OF SAID RAILROAD AND 747.41 FEET EAST OF THE WEST LINE OF THE SOUTHWEST 1/4 OF THE NORTHWEST 1/4 OF SAID FRACTIONAL SECTION 31; THENCE SOUTHWESTERLY ALONG THE SOUTHERLY RIGHT-OF-WAY LINE OF SAID RAILROAD TO THE POINT OF BEGINNING, IN LAKE COUNTY, INDIANA.

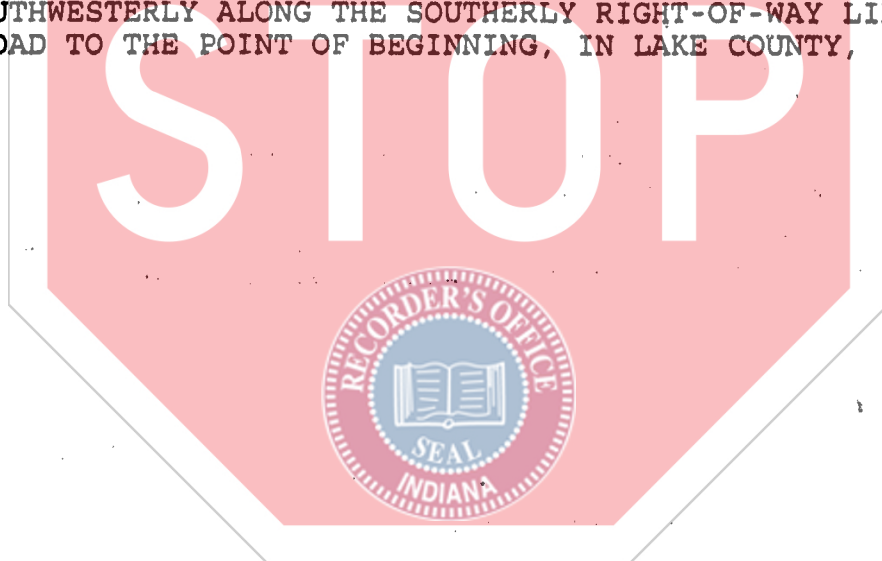

COMMUNITY LIFE COMPANY
FILE NO _____