

6800744598

[WHEN RECORDED RETURN TO]
NTC ATTN: DARRELL COLON
101 N. BRAND BLVD., SUITE #1800
GLENDALE, CALIFORNIA 91203
GREENTREE LOAN: 6800744598

Corporation



2000 064004

STATE OF INDIANA
LAKE COUNTY
FILED FOR RECORDING

2000 SEP -1 PM 2:03

LOAN #: 61923215

MADEB W. GIBBER
RECORDER

ASSIGNMENT OF MORTGAGE

KNOW ALL MEN BY THESE PRESENTS That

Irwin Mortgage Corporation (formerly known as Inland Mortgage Corporation)
9265 Counselors Row
Indianapolis, IN 46240-0616

organized and existing under the laws of the State of Indiana, party of the first part, for value received, has granted, bargained, sold, assigned, transferred and set over, and by these presents does grant, sell, assign, transfer and set over unto

Green Tree Financial Servicing Corporation

organized and existing under the laws of Delaware, party of the second part, its successors and assigns, a certain indenture of mortgage dated 05/22/98, made by

Robert Leyba and Lucy Leyba, Husband and Wife as Joint Tenants

to it, securing the payment of one promissory note therein described for the sum of **Twenty-Five Thousand Six Hundred No/100 Dollars \$25,600.00** and all its rights, title and interest in and to the premises situated in the county of Lake, State of Indiana, and described in said mortgage as follows, to-wit: *Int. Instrument # 98039897*

SEE LEGAL DESCRIPTION ATTACHED HERETO AND MADE A PART HEREOF

AP #: 28-29-0082-0025

which said mortgage is recorded in the office of the Recorder of Lake in the State of Indiana, in Book No. _____ at Page _____ as Document No. _____ together with the said note therein described and the money due or to grow due thereon, with the interest;

TO HAVE AND TO HOLD the same unto the said party of the second part, its successors and assigns, forever; subject only to the provisions in the said indenture of mortgage contained.

IN WITNESS WHEREOF, the party of the first part has caused this instrument to be executed in its name by **Eric R. Coss** its Vice President, and attested by **Mark J. Lynch**, its Senior Vice President and its corporate seal to be hereunto affixed on **February 12, 1999**.

ATTEST:

IRWIN MORTGAGE CORPORATION
(formerly known as Inland Mortgage Corporation)

Mark J. Lynch
Mark J. Lynch, Senior Vice President

By: *Eric R. Coss*
Eric R. Coss, Vice President

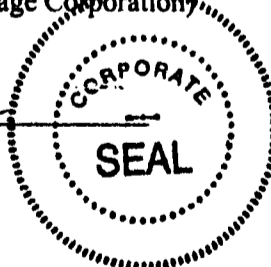

State of VIRGINIA

County of HENRICO

The foregoing instrument was acknowledged before me on **February 10, 1999** by **Eric R. Coss**, Vice President of **IRWIN MORTGAGE CORPORATION** (formerly known as Inland Mortgage Corporation), an **INDIANA** corporation, on behalf of the corporation.

My Commission Expires: November 30, 2002

Luanne S. Bragg
Luanne S. Bragg, Notary Public

Indiana Assignment of Mortgage 12/93

ORIGINAL



12/00
AC
675433

EXHIBIT A

LEGAL DESCRIPTION

Lot 26 in Harvey's Subdivision in the City of Whiting, as per plat thereof, recorded in Plat Book 2, page 34, in the Office of the Recorder of Lake County, Indiana.

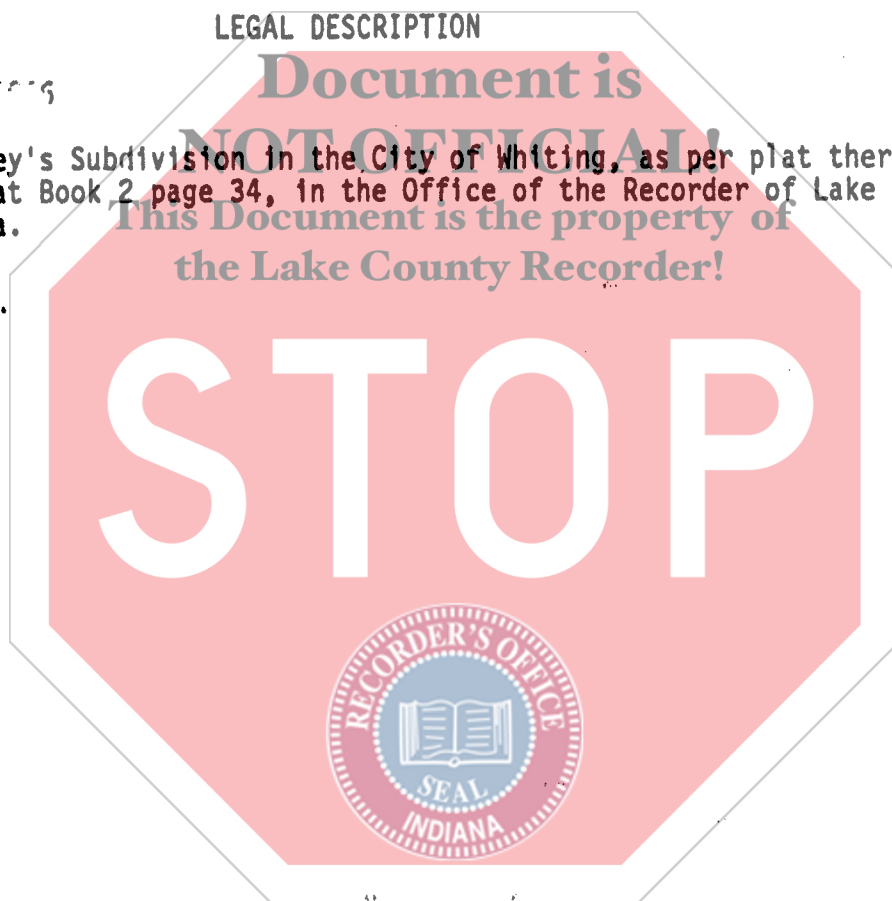

END OF LEGAL DESCRIPTION