

STATE OF INDIANA
LAKE COUNTY
FILED FOR RECORD

2

MORTGAGE / DEED OF TRUST ASSIGNMENT
2000 063909

2000 SEP -1 AM 11:15 6907387523

For value received, Conseco Bank, Inc., a corporation organized and existing under the laws of the State of Utah, hereby assigns to Conseco Finance Servicing Corp., its successors and assigns, all right, title, and interest in and to a certain Mortgage / Deed of Trust dated May 11, 2000, made by Doris G Thill and Tamala W Anderson joint tenants with rights of survivorship, as mortgagor(s), to Conseco Bank, Inc., as mortgagee, as filed in the offices of the County Recorder, county of Lake, State of Indiana, together with the Note secured by such mortgage / deed of trust on the following described property situated in the above county and state, to wit:

See attached exhibit A for legal description.

Date this day of June 30, 2000.

Mtg. Rec. Bk _____ Pg _____
Instrument # 2000-034986

Document is NOT OFFICIAL!

Conseco Bank, Inc.

This Document is the property of the Lake County Recorder!

By

Julie Larson
Julie Larson, Authorized Agent

State of Arizona

) ss

County of Maricopa

As a Notary Public for the State of Arizona, I hereby certify that Julie Larson personally came before me on this date and acknowledged that he/she is an Authorized Agent of Conseco Bank, Inc., a Utah corporation, and that by authority duly given and as the act of the corporation, the foregoing instrument was signed in its name by him/her.

Witness my hand and official seal dated this day June 30, 2000.

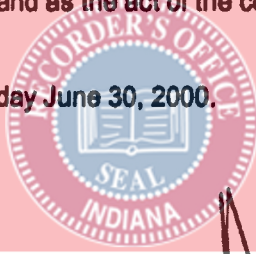

NR

Notary Public

My Commission Expires:

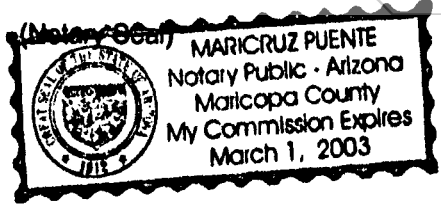

[WHEN RECORDED RETURN TO]
NTC ATTN: DARRELL COLON
101 N. BRAND BLVD., SUITE #1800
GLENDALE, CALIFORNIA 91203
GREENTREE LOAN: 6907387523



13.00
AC

679143/687193

EXHIBIT A

Legal Description:

LOT 20, BLOCK 2, AS MARKED AND LAID DOWN ON THE RECORDED PLAT OF BEVERLY SEVENTH ADDITION, IN THE CITY OF HAMMOND, LAKE COUNTY, INDIANA, AS THE SAME APPEARS OF RECORD IN PLAT BOOK 29, PAGE 100 IN THE RECORDERS OFFICE OF LAKE COUNTY, INDIANA.

Parcel ID: 26-32-0205-0020

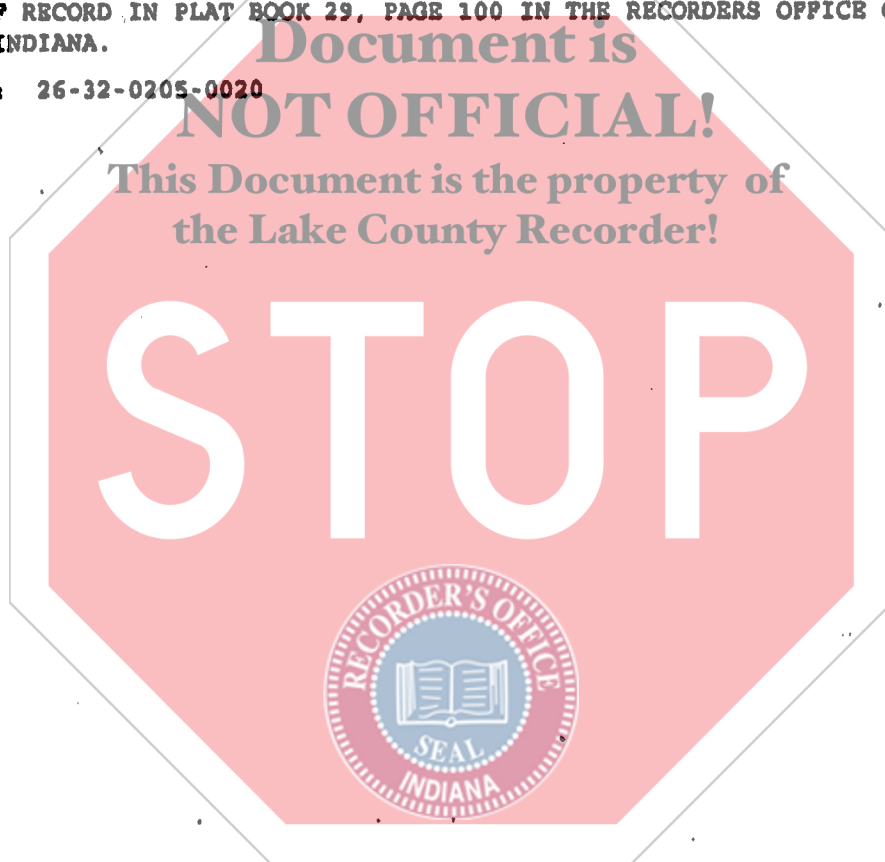

DGT
TWA