

STATE OF INDIANA
LAKE COUNTY
FILED FOR RECORD

2000 063228

2000 AUG 30 PM 1:28

REC. CENTER

Mail To: 828 W. 19th AV., Gary, IN 46407



A298-10
R298-04

QUITCLAIM DEED

THIS QUITCLAIM DEED, Executed this 21 day of August, 2000 (year),

by first party, Grantor, Claudine Welch

whose post office address is 468 W. 53rd Pl., Merrillville, IN, 46410

to second party, Grantee, Fredina Welch-Glover

whose post office address is 828 W. 19th AV, Gary, IN 46407

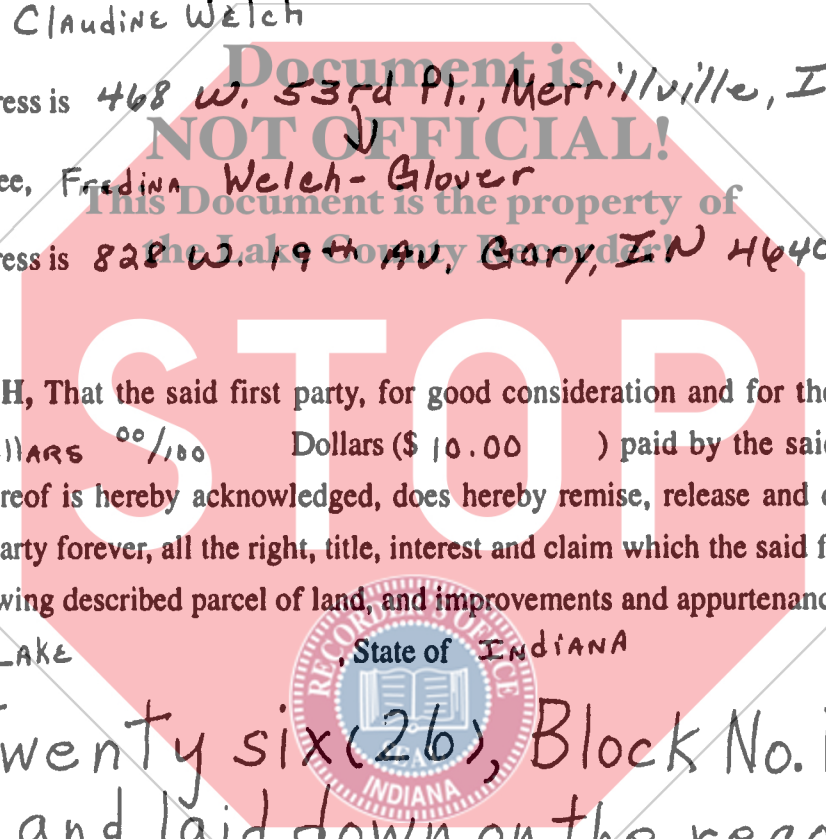

WITNESSETH, That the said first party, for good consideration and for the sum of
TEN DOLLARS ^{00/100} Dollars (\$ 10.00) paid by the said second
party, the receipt whereof is hereby acknowledged, does hereby remise, release and quitclaim
unto the said second party forever, all the right, title, interest and claim which the said first party
has in and to the following described parcel of land, and improvements and appurtenances there-
to in the County of LAKE, State of INDIANA to wit:

Lot No. Twenty six (26), Block No. Nine (9)
as marked and laid down on the recorded
plat of Logan Park Addition to Tolleston, in the
City of Gary, Lake County, Indiana.
Address - 828 West 19th Avenue, Gary, Indiana

AKHF
(1)

(Revised 3/98)

If your state requires 8 1/2" x 11" forms, cut off the bottom of this page at the dotted line.

DULY ENTERED FOR TAXATION SUBJECT TO
FINAL ACCEPTANCE FOR TRANSFER

AUG 30 2000

PETER BENJAMIN
LAKE COUNTY AUDITOR



© E-Z Legal Forms. Before you use this form, read it, fill in all blanks, and make whatever changes are necessary to your particular transaction. Consult a lawyer if you doubt the form's fitness for your purpose and use. E-Z Legal Forms and the retailer make no representation or warranty, express or implied, with respect to the merchantability of this form for an intended use or purpose.

16-00
E.P.
CS

02443

IN WITNESS WHEREOF, The said first party has signed and sealed these presents the day and year first above written. Signed, sealed and delivered in presence of:

Signature of Witness Claudine Welch
Signature of First Party

Print name of Witness _____
Print name of First Party

Signature of Witness _____
Signature of First Party

Print name of Witness _____
Print name of First Party

State of INDIANA)
County of LAKE
On 8-30-00
appeared Claudine Welch
personally known to me (or proved to me on the basis of satisfactory evidence) to be the person(s) whose name(s) is/are subscribed to the within instrument and acknowledged to me that he/she/they executed the same in his/her/their authorized capacity(ies), and that by his/her/their signature(s) on the instrument the person(s), or the entity upon behalf of which the person(s) acted, executed the instrument.
WITNESS my hand and official seal.

before me, DENISE A. Georgopoulos
Document is the property of the Lake County Recorder!

Denise A. Georgopoulos
Signature of Notary

**DENISE A. GEORGOPOULOS, Notary Public
A Resident of Lake County, IN
My Commission Expires Dec. 11, 2000**

Affiant Known Produced ID
Type of ID _____ (Seal)

State of _____
County of _____
On _____
appeared _____
personally known to me (or proved to me on the basis of satisfactory evidence) to be the person(s) whose name(s) is/are subscribed to the within instrument and acknowledged to me that he/she/they executed the same in his/her/their authorized capacity(ies), and that by his/her/their signature(s) on the instrument the person(s), or the entity upon behalf of which the person(s) acted, executed the instrument.
WITNESS my hand and official seal.

before me, _____
STOP
SEAL INDIANA

Signature of Notary

Affiant Known Produced ID
Type of ID _____ (Seal)

Signature of Preparer

Print Name of Preparer

Address of Preparer

(2)
If your state requires 8 1/2" x 11" forms, cut off the bottom of this page at the dotted line.